

**FIBER CABLE TRAY**

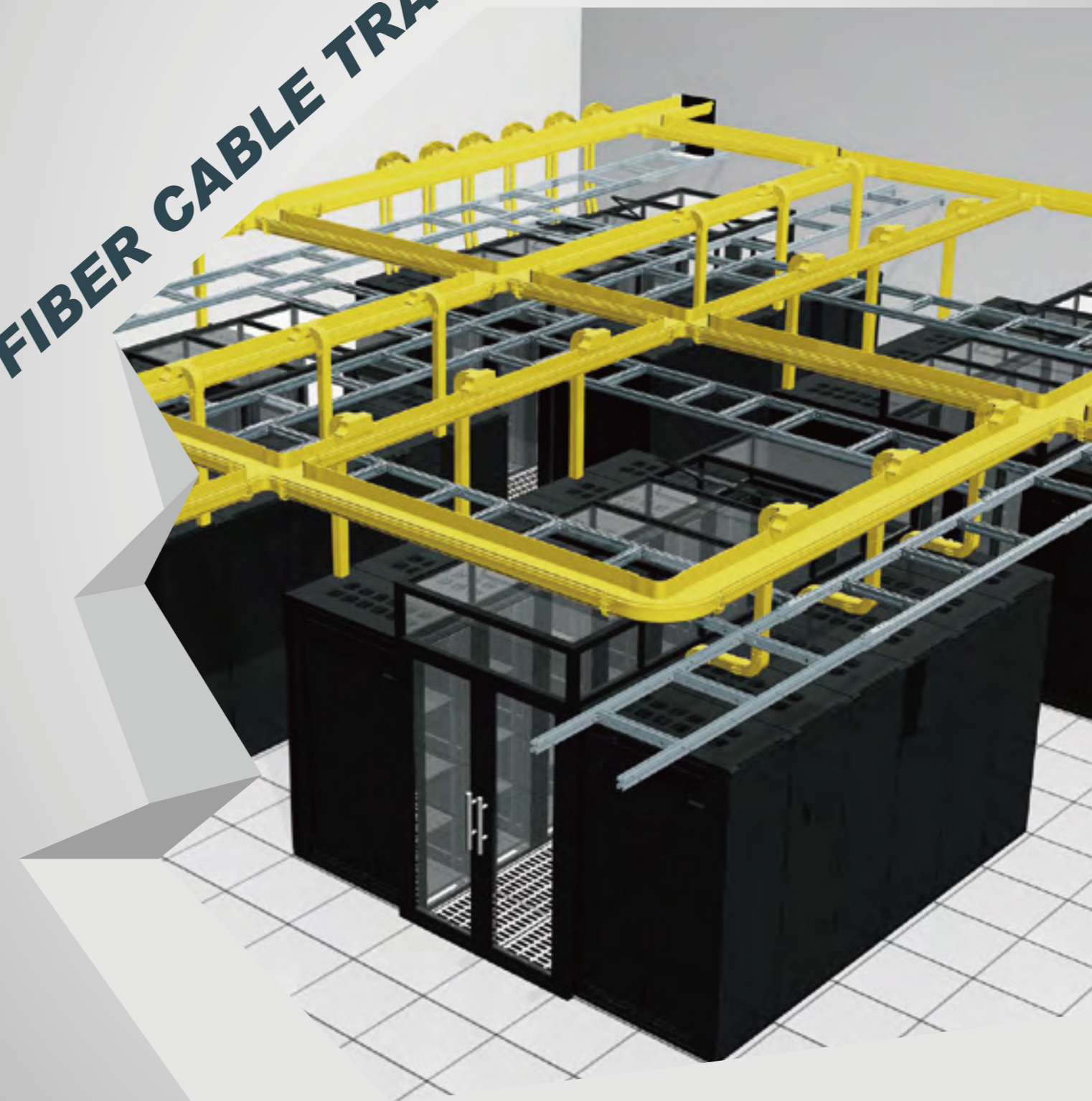



Inova

# INDEX

— **STRAIGHT SECTION**

PAGES 01 - 02

— **JUNCTION**

PAGES 03 - 05

— **HORIZONTAL TEE**

PAGES 06 - 08

— **CUTTING IN TEE**

PAGES 09

— **CROSS**

PAGES 10 - 12

— **HORIZONTAL 90° ELBOW**

PAGES 13 - 15

— **45° UP ELBOW**

PAGES 16 - 18

— **45° DOWN ELBOW**

PAGES 19 - 21

— **CONVERSION**

PAGES 22 - 24

— **DOWNSPOUT**

PAGES 25 - 28

— **END CAP**

PAGES 29 - 31

— **SUPPORT**

PAGES 32 - 37



# FIBER CABLE TRAY

Fiber Cable Tray is designed to protect and route fiber optic patch cords, manage cable assemblies to and from network cabinets, ODF and other terminal devices.

Fiber optical cable tray is the best solution for optical raceway requirements and application with pleasant appearance and quite easy maintenance.

Two kinds of raw material of straight section for option,

ABS is environment friendly and high-class, PVC offers an relatively cheaper version for tight budget projects.

Tool-less assembly and quick movable exits.

Exclusive big capacity 4"x15" design, also provides 4"x 5" and 4"x 10" for needs of various projects.

All plastic parts reach UL94-V0 level of flammability.

RoHS compliant

Yellow color is standard, other nonstandard colors are available by request.

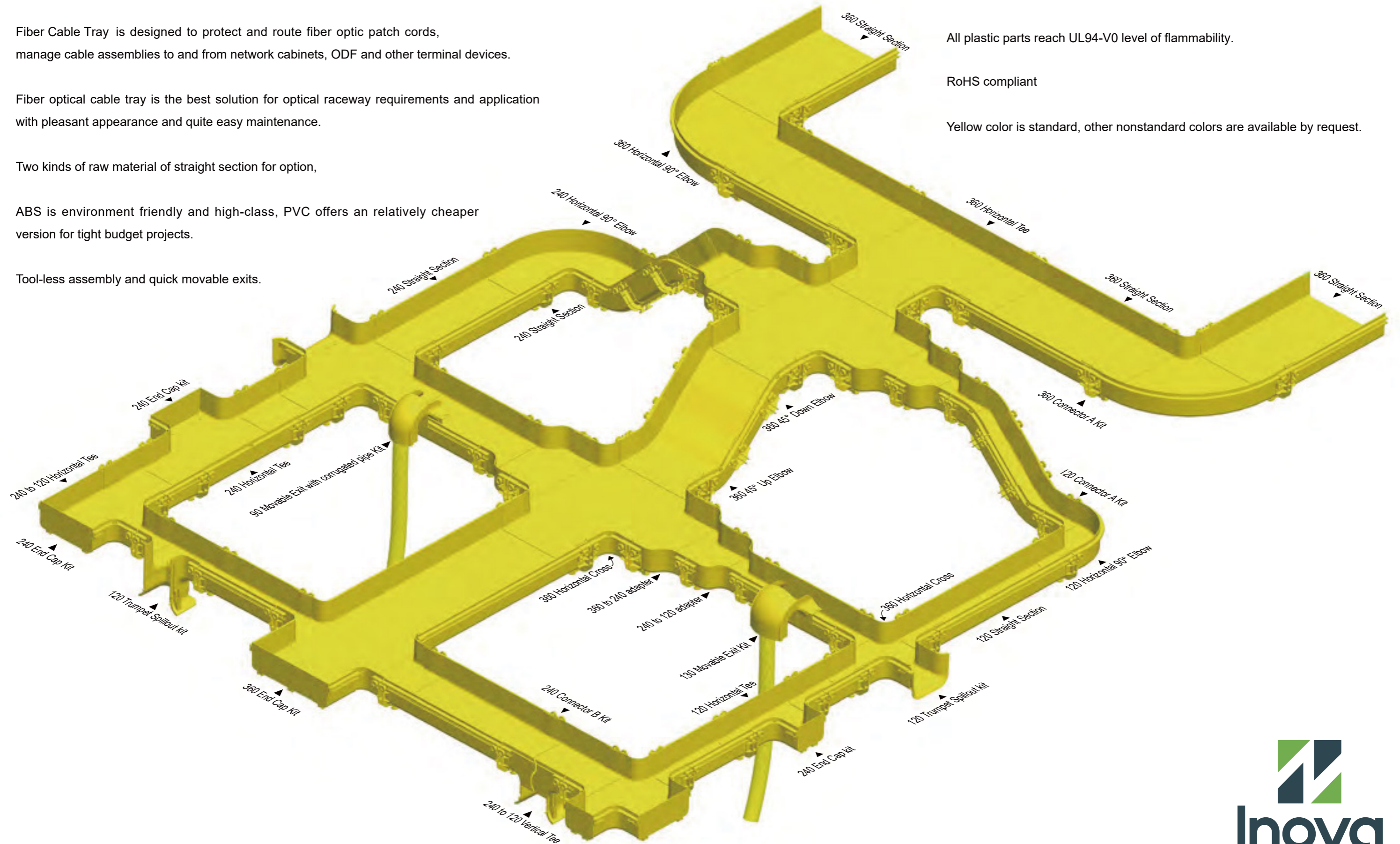

**RECOMMENDED DENSITY**

RACEWAY SIZE		4" X 5"		4" X 10"		4" X 15"	
PATCH CORDS DIA		2.0mm	3.0mm	2.0mm	3.0mm	2.0mm	3.0mm
Accumulated height	5cm	1020	440	2040	880	3060	1320
	7.5cm	1530	660	3060	1320	4590	1980
	11cm	2040	880	4080	1760	6120	2640

**UDL**  
Uniformly distributed load



TOOL FREE



QUICK INSTALL



FLAME RETARDANT

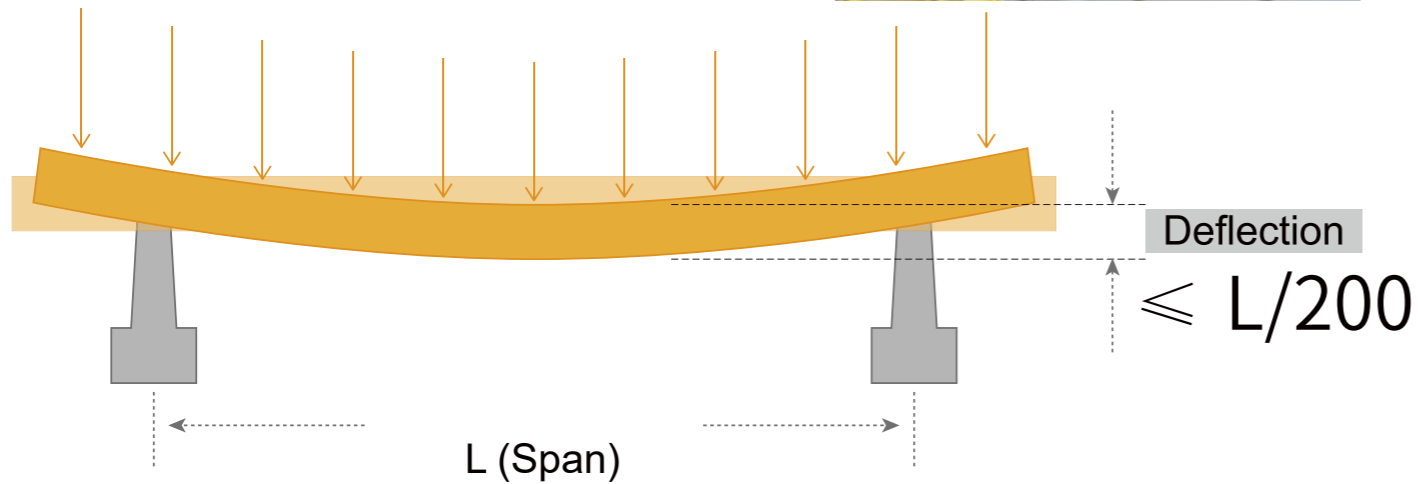

SIZE	SPAN			DEFLECTION(mm)			LOAD(kg)		
120	1	1.5	2	5	7	10	120	110	60
240	1	1.5	2	5	7	10	320	90	60
360	1	1.5	2	5	7	10	340	100	70

**STRAIGHT SECTION**

**360 STRAIGHT SECTION**

ITEM NO.:	WIDTH		HEIGHT		MATERIAL
	MM	INCH	MM	INCH	
AS01	360	15	100	4	PVC / ABS

USED TO CARRY THE CABLES HORIZONTALLY THROUGHOUT THE SYSTEM. ACCEPTS COVER AND FITTINGS.

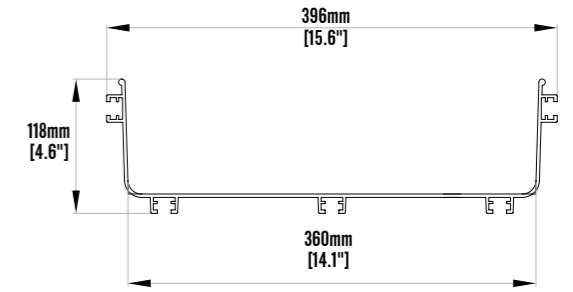
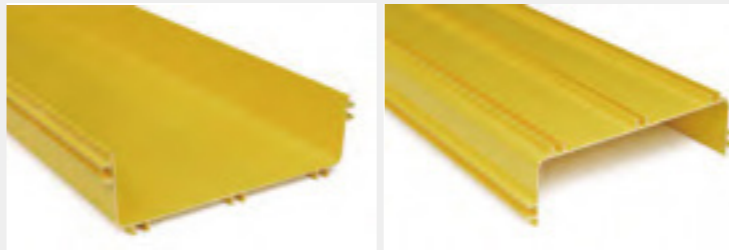

**360 STRAIGHT SECTION COVER**

ITEM NO.: AF39

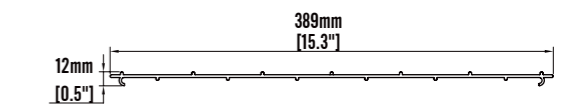

**240 STRAIGHT SECTION**

ITEM NO.:	WIDTH		HEIGHT		MATERIAL
	MM	INCH	MM	INCH	
AS02	240	10	100	4	PVC / ABS

USED TO CARRY THE CABLES HORIZONTALLY THROUGHOUT THE SYSTEM. ACCEPTS COVER AND FITTINGS.

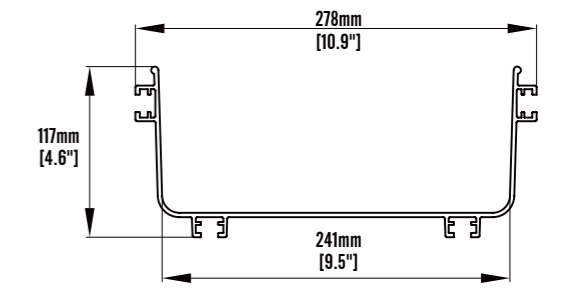

**240 STRAIGHT SECTION COVER**

ITEM NO.: AF45

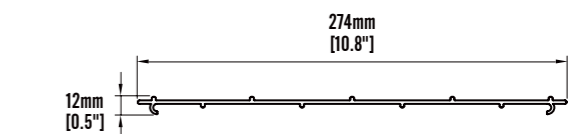

## 120 STRAIGHT SECTION

ITEM NO.:	WIDTH		HEIGHT		MATERIAL
	MM	INCH	MM	INCH	
AS03	120	5	100	4	PVC / ABS
USED TO CARRY THE CABLES HORIZONTALLY THROUGHOUT THE SYSTEM. ACCEPTS COVER AND FITTINGS.					

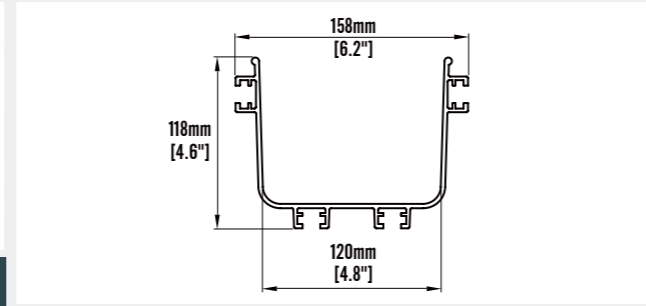
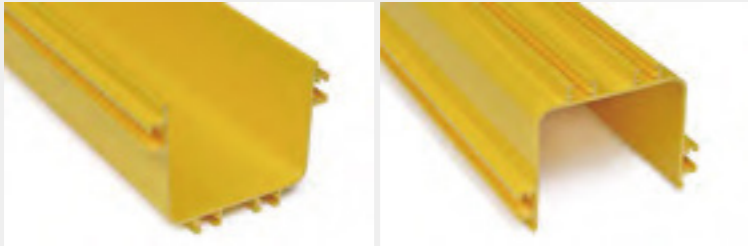

## 120 STRAIGHT SECTION COVER

ITEM NO.: AF51

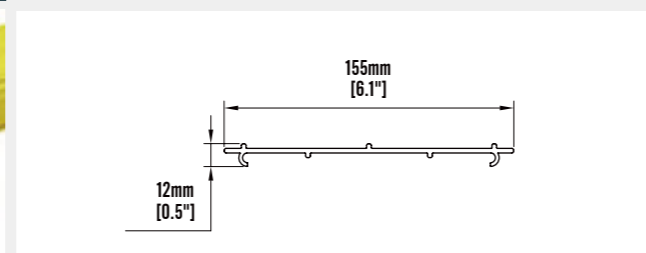
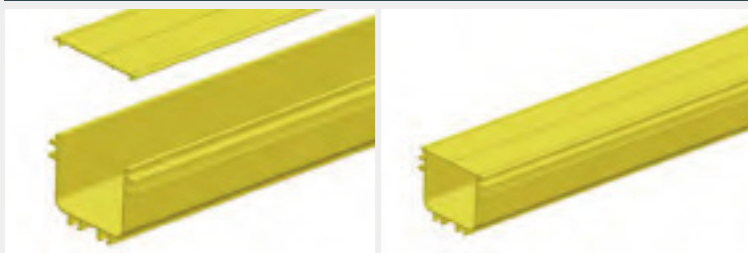

## 60 STRAIGHT SECTION

ITEM NO.:	WIDTH		HEIGHT		MATERIAL
	MM	INCH	MM	INCH	
AS04	60	2.36	60	2.36	PVC / ABS
USED TO CARRY THE CABLES HORIZONTALLY THROUGHOUT THE SYSTEM. ACCEPTS COVER AND FITTINGS.					

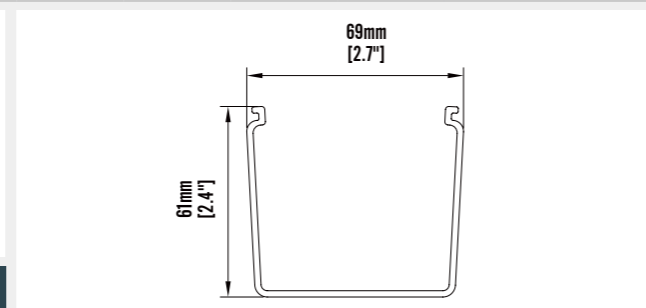

## 60 STRAIGHT SECTION COVER

ITEM NO.: AF63

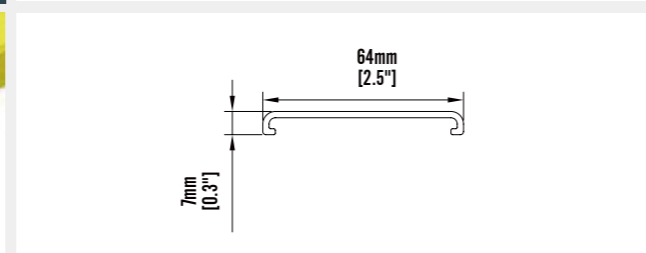
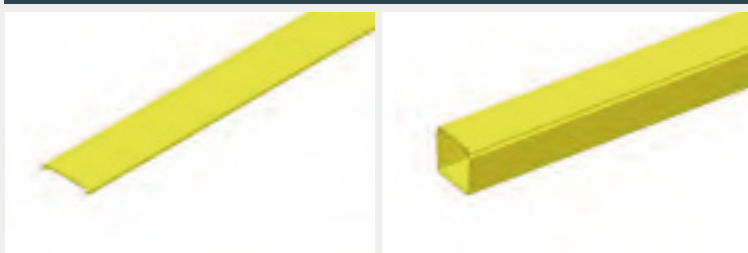

## 360 CONNECTOR A KIT

ITEM NO.:	WIDTH		HEIGHT		MATERIAL
	MM	INCH	MM	INCH	
AFK02	360	15	100	4	PVC / ABS
QUICKLY JOINS TWO SECTIONS OF CHANNEL AND/OR FITTINGS. TIGHTEN AND RELEASE BOLTS BY FINGERS, ABSOLUTELY TOOLLESS					

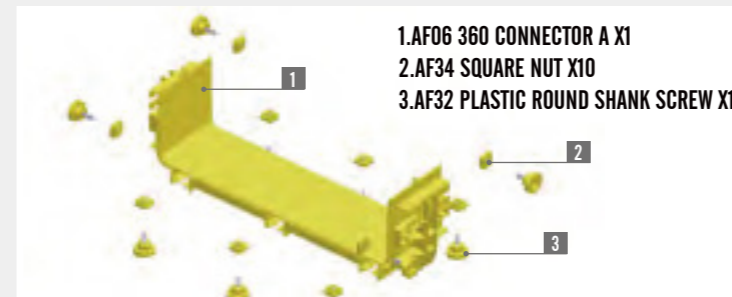
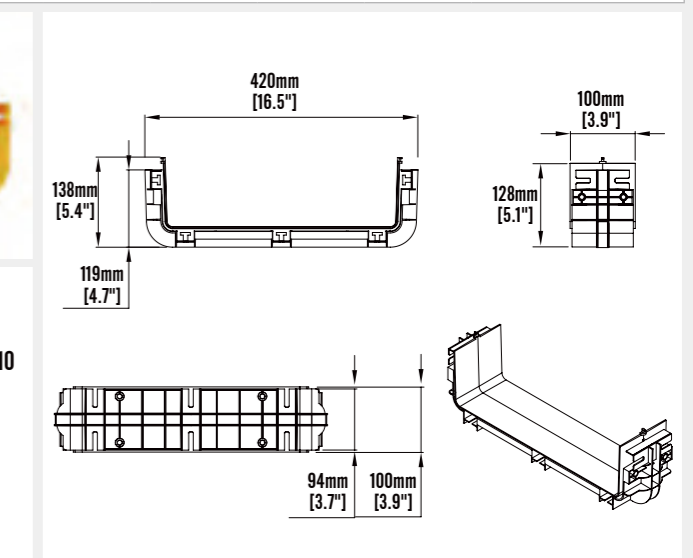

## 240 CONNECTOR B KIT

ITEM NO.:	WIDTH		HEIGHT		MATERIAL
	MM	INCH	MM	INCH	
AFK05	240	10	100	4	PVC / ABS
QUICKLY JOINS TWO SECTIONS OF CHANNEL AND/OR FITTINGS. TIGHTEN AND RELEASE BOLTS BY FINGERS, ABSOLUTELY TOOLLESS					

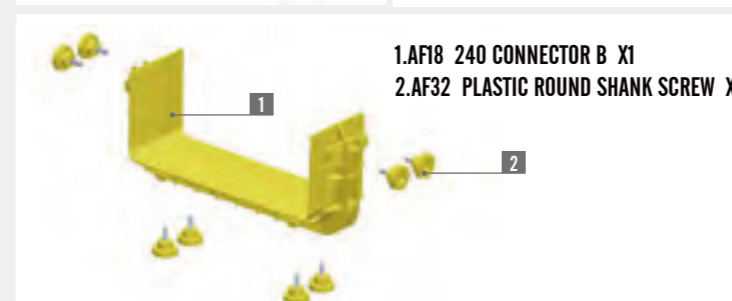
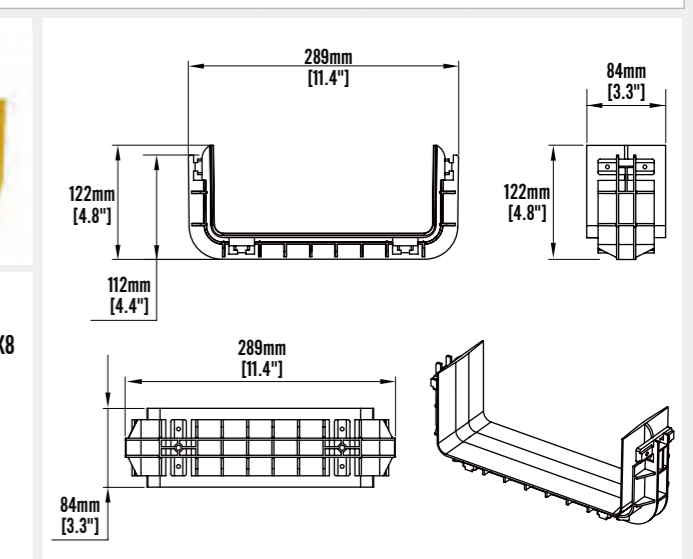

## 120 CONNECTOR B KIT

	ITEM NO.:	WIDTH		HEIGHT		MATERIAL
		MM	INCH	MM	INCH	
	AFK09	120	5	100	4	PVC / ABS

QUICKLY JOINS TWO SECTIONS OF CHANNEL AND/OR FITTINGS.  
TIGHTEN AND RELEASE BOLTS BY FINGERS, ABSOLUTELY TOOLLESS

1.AF28 120 CONNECTOR B X1  
2.AF32 PLASTIC ROUND SHANK SCREW X8

## 60 CONNECTOR

	ITEM NO.:	WIDTH		HEIGHT		MATERIAL
		MM	INCH	MM	INCH	
	AF70	60	2.36	60	2.36	PVC / ABS

QUICKLY JOINS TWO SECTIONS OF CHANNEL AND/OR FITTINGS.

## 360/240/120 INSTALLATION DEMONSTRATION

## 60 INSTALLATION DEMONSTRATION

## HORIZONTAL TEE

### 360 HORIZONTAL TEE

ITEM NO.:	WIDTH		HEIGHT		MATERIAL
	MM	INCH	MM	INCH	
AF02	360	15	100	4	PVC / ABS

ATTACHES TO 4"X15" CHANNEL AND/OR FITTINGS TO CREATE A 90° HORIZONTAL BRANCH FROM A STRAIGHT HORIZONTAL RUN.



### 360 HORIZONTAL TEE CROSS COVER

ITEM NO.: AF41

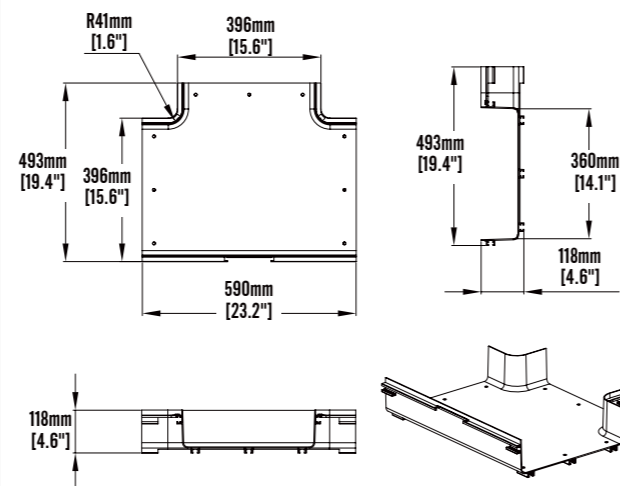
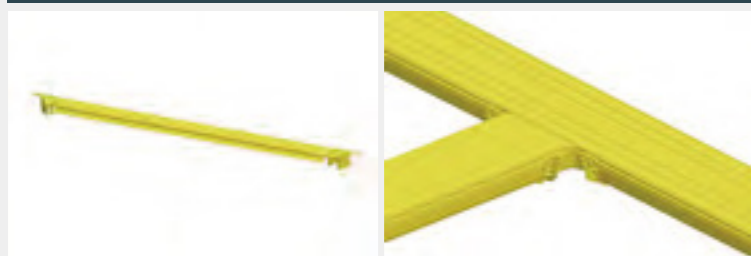

### 240 HORIZONTAL TEE

ITEM NO.:	WIDTH		HEIGHT		MATERIAL
	MM	INCH	MM	INCH	
AF08	240	10	100	4	PVC / ABS

ATTACHES TO 4"X10" CHANNEL AND/OR FITTINGS TO CREATE A 90° HORIZONTAL BRANCH FROM A STRAIGHT HORIZONTAL RUN.



### 240 HORIZONTAL TEE CROSS COVER

ITEM NO.: AF47

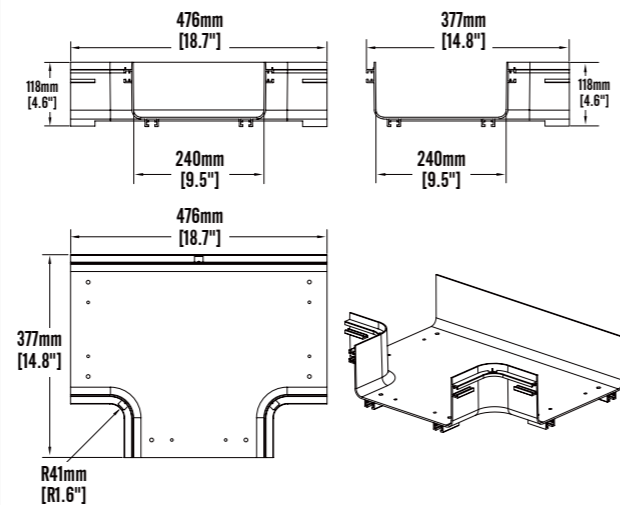
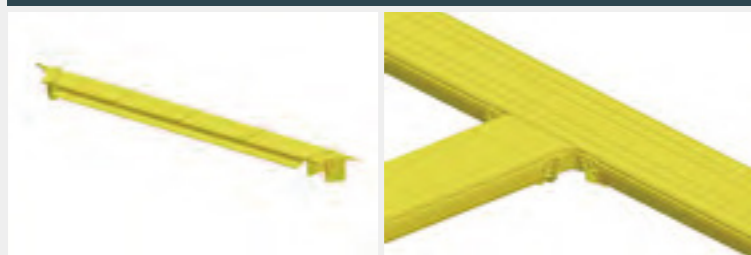

## HORIZONTAL TEE

### 120 HORIZONTAL TEE

ITEM NO.:	WIDTH		HEIGHT		MATERIAL
	MM	INCH	MM	INCH	
AF21	120	5	100	4	PVC / ABS

ATTACHES TO 4"X5" CHANNEL AND/OR FITTINGS TO CREATE A 90° HORIZONTAL BRANCH FROM A STRAIGHT HORIZONTAL RUN.



### 120 HORIZONTAL TEE CROSS COVER

ITEM NO.: AF53

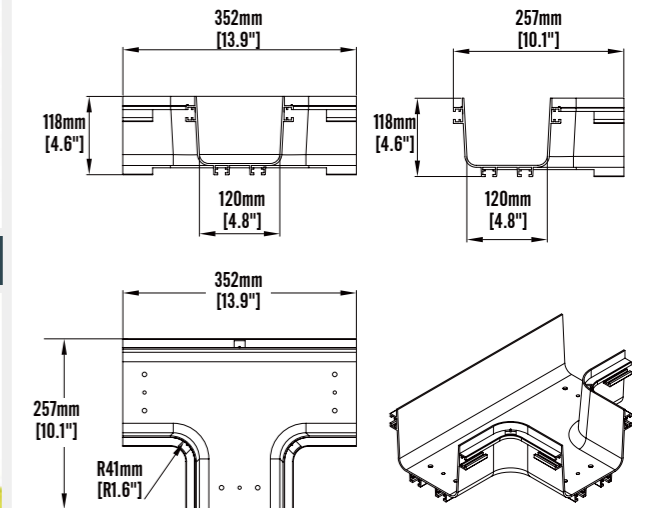
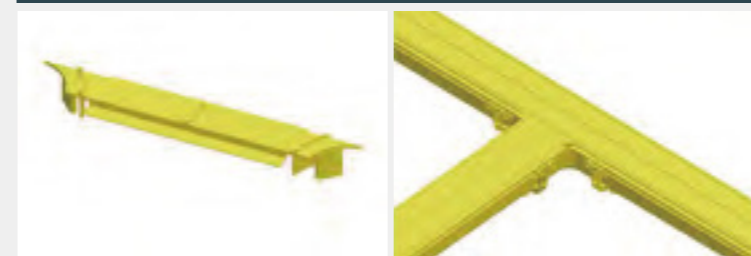

### 60 HORIZONTAL TEE

ITEM NO.:	WIDTH		HEIGHT		MATERIAL
	MM	INCH	MM	INCH	
AF59	60	2.36	60	2.36	PVC / ABS

ATTACHES TO 2.36"X2.36" CHANNEL AND/OR FITTINGS TO CREATE A 90° HORIZONTAL BRANCH FROM A STRAIGHT HORIZONTAL RUN.



### 60 HORIZONTAL TEE CROSS COVER

ITEM NO.: AF65

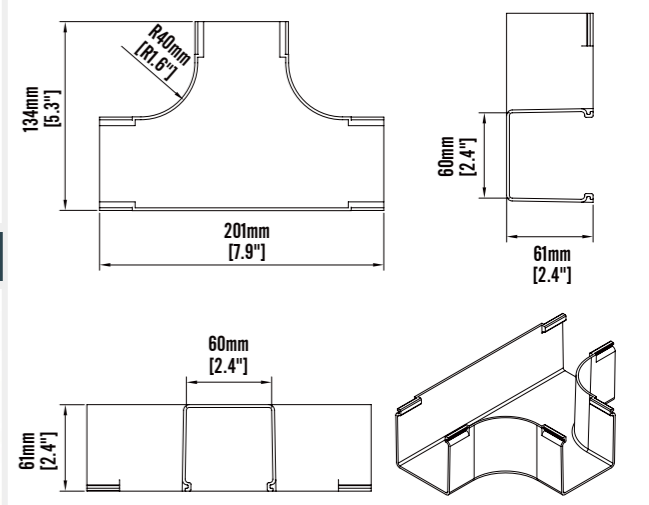
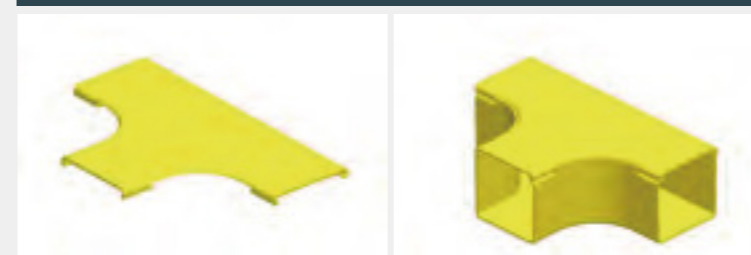

## 360/240/120 HORIZONTAL TEE INSTALLATION

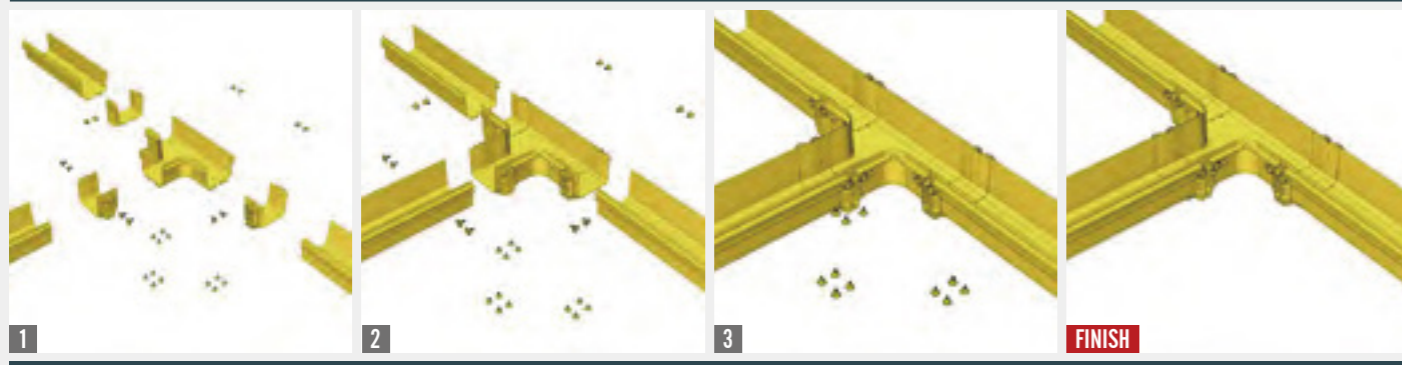

## 360/240/120 HORIZONTAL TEE CROSS COVER INSTALLATION

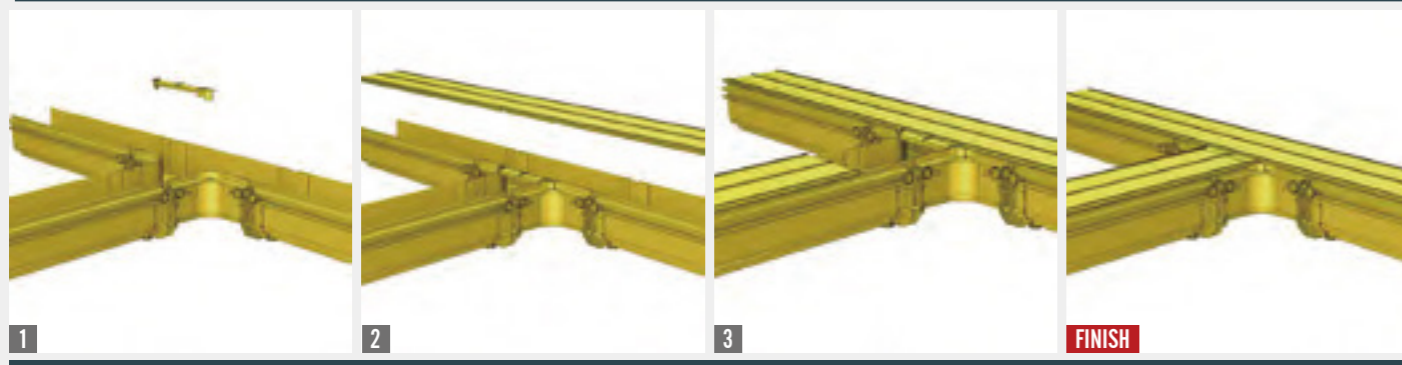

## 60 HORIZONTAL TEE INSTALLATION

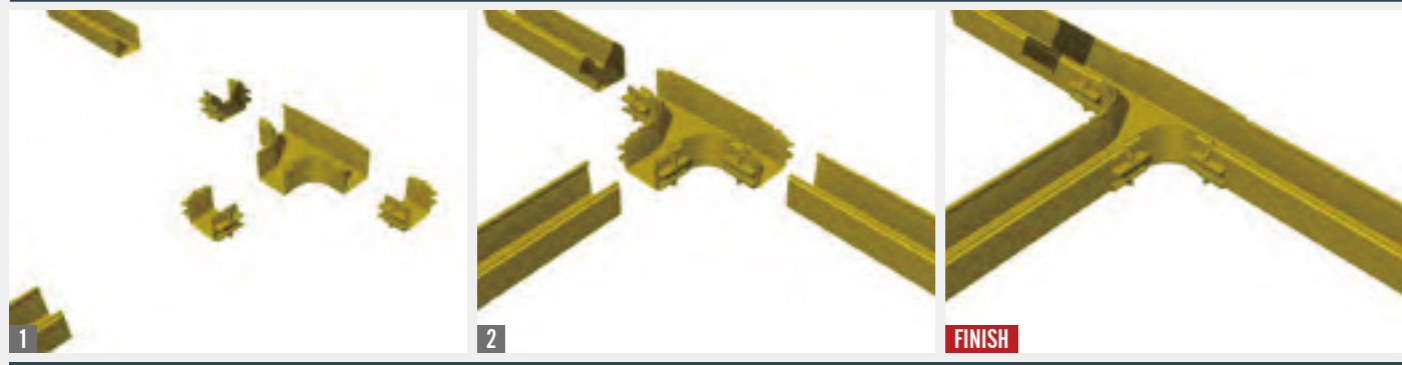

## 60 HORIZONTAL TEE COVER INSTALLATION



## 240 CUTTING IN TEE

ITEM NO.:	WIDTH		HEIGHT		MATERIAL
	MM	INCH	MM	INCH	
AF36	240	10	100	4	PVC / ABS

ATTACHES TO 4"X10" CHANNEL TO CREATE A 90° HORIZONTAL ELBOW FROM ANYWHERE OF A STRAIGHT HORIZONTAL RUN.

- 1.AF36 240 CUTTING IN TEE X1
- 2.AF35 T-SHAPE SCREW X2
- 3.AF33 PLASTIC TWIST NUT X2

Technical drawings showing dimensions: 353mm [13.9"], 116mm [4.6"], 100mm [3.9"], 242mm [9.5"], 338mm [13.3"], 132mm [5.2"], 116mm [4.6"], 132mm [5.2"]

## 120 CUTTING IN TEE

ITEM NO.:	WIDTH		HEIGHT		MATERIAL
	MM	INCH	MM	INCH	
AF31	120	5	100	4	PVC / ABS

ATTACHES TO 4"X5" CHANNEL TO CREATE A 90° HORIZONTAL ELBOW FROM ANYWHERE OF A STRAIGHT HORIZONTAL RUN.

- 1.AF31 120 CUTTING IN TEE X1
- 2.AF35 T-SHAPE SCREW X2
- 3.AF33 PLASTIC TWIST NUT X2

Technical drawings showing dimensions: 233mm [9.2"], 116mm [4.6"], 218mm [8.6"], 120mm [4.8"], 132mm [5.2"], 116mm [4.6"], 132mm [5.2"], R40mm [R1.6"]

## CUTTING IN TEE INSTALLATION

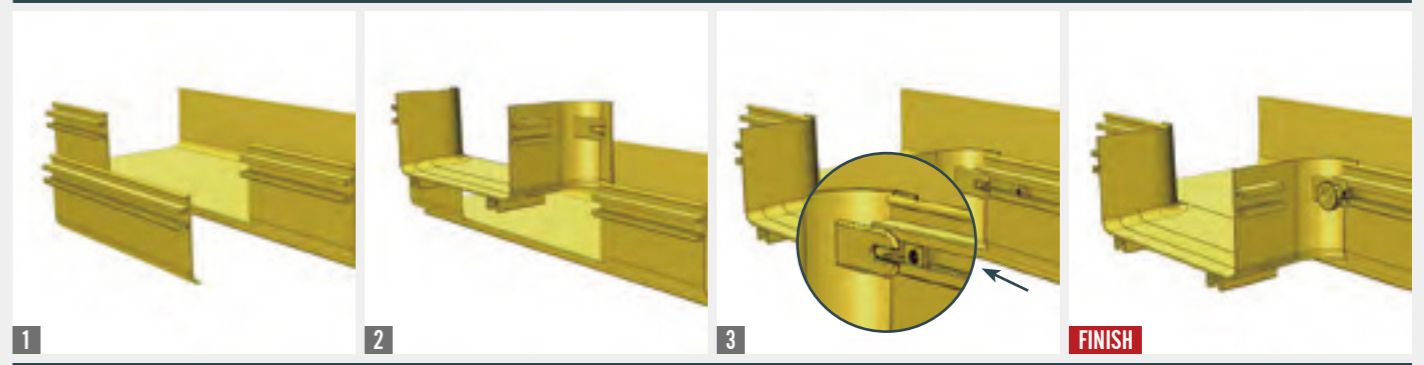



360 HORIZONTAL CROSS

ITEM NO.:	WIDTH		HEIGHT		MATERIAL
	MM	INCH	MM	INCH	
AF03	360	15	100	4	PVC / ABS

ATTACHES TO 4"X15" CHANNEL AND/OR FITTINGS TO CREATE A HORIZONTAL FOUR WAY CROSS INTERSECTION WITH TWO 4"X15" EXITS.

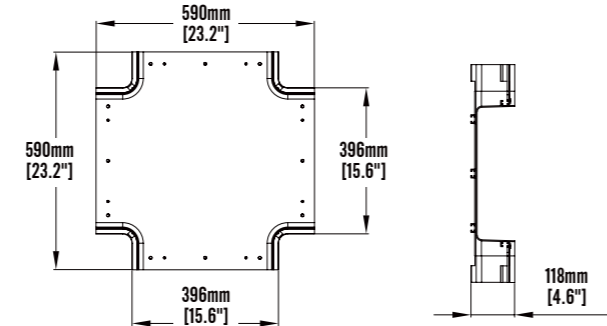

360 HORIZONTAL TEE CROSS COVER

ITEM NO.: AF41

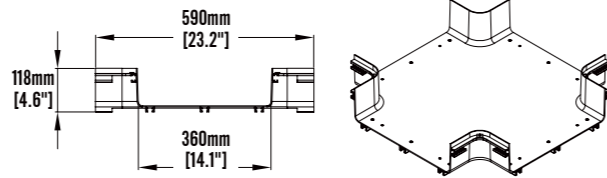
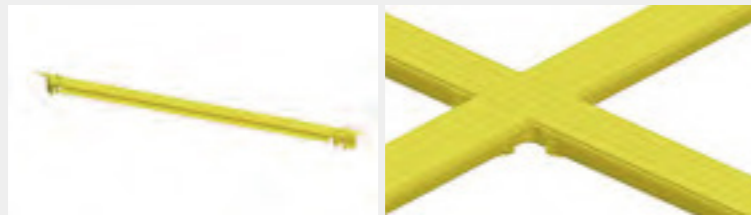

240 HORIZONTAL CROSS

ITEM NO.:	WIDTH		HEIGHT		MATERIAL
	MM	INCH	MM	INCH	
AF09	240	10	100	4	PVC / ABS

ATTACHES TO 4"X10" CHANNEL AND/OR FITTINGS TO CREATE A HORIZONTAL FOUR WAY CROSS INTERSECTION WITH TWO 4"X10" EXITS.

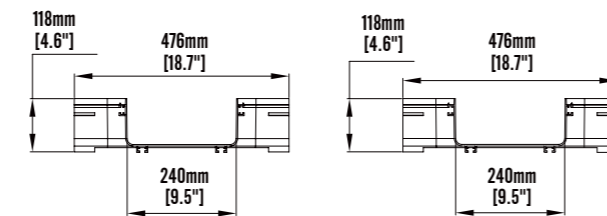
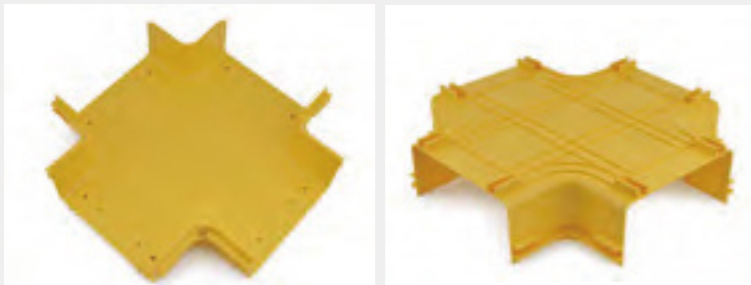

240 HORIZONTAL TEE CROSS COVER

ITEM NO.: AF47

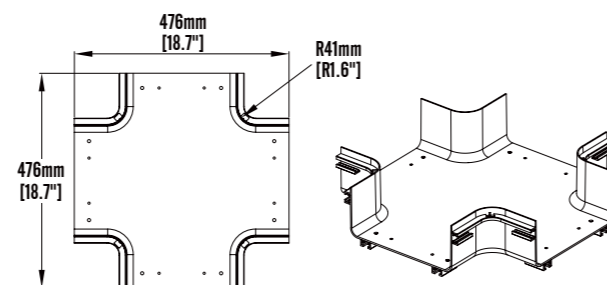
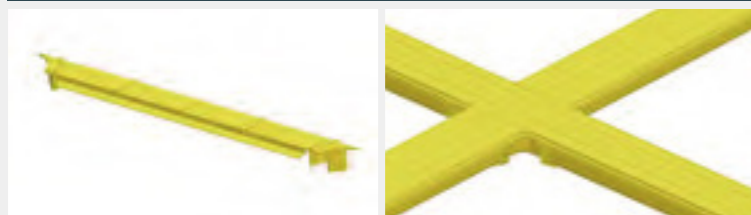

120 HORIZONTAL CROSS

ITEM NO.:	WIDTH		HEIGHT		MATERIAL
	MM	INCH	MM	INCH	
AF22	120	5	100	4	PVC / ABS

ATTACHES TO 4"X5" CHANNEL AND/OR FITTINGS TO CREATE A HORIZONTAL FOUR WAY CROSS INTERSECTION WITH TWO 4"X5" EXITS.

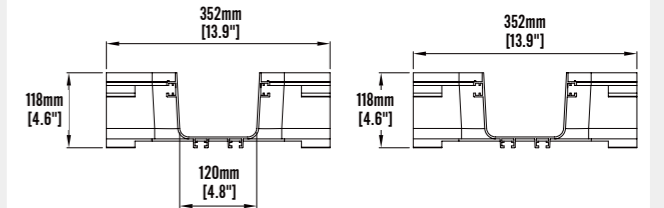

120 HORIZONTAL TEE CROSS COVER

ITEM NO.: AF53

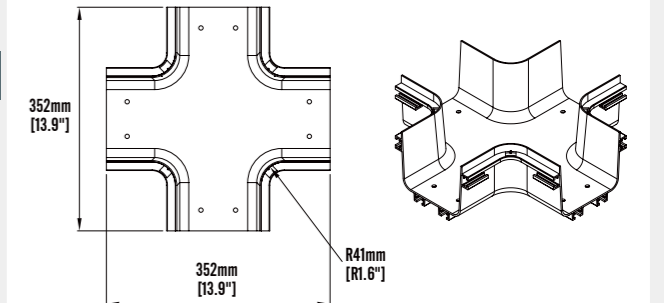
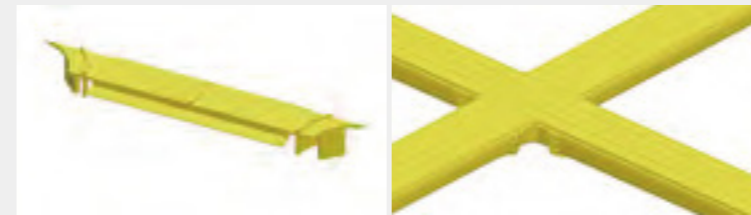

60 HORIZONTAL CROSS

ITEM NO.:	WIDTH		HEIGHT		MATERIAL
	MM	INCH	MM	INCH	
AF60	60	2.36	60	2.36	PVC / ABS

ATTACHES TO 2.36"X2.36" CHANNEL AND/OR FITTINGS TO CREATE A HORIZONTAL FOUR WAY CROSS INTERSECTION WITH TWO 2.36"X2.36" EXITS.

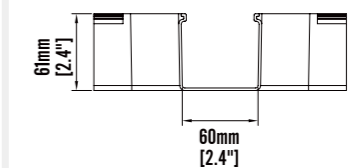

60 HORIZONTAL CROSS COVER

ITEM NO.: AF66

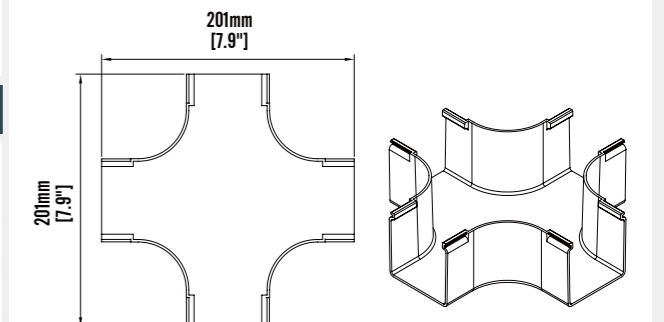

**360/240/120 HORIZONTAL CROSS INSTALLATION**

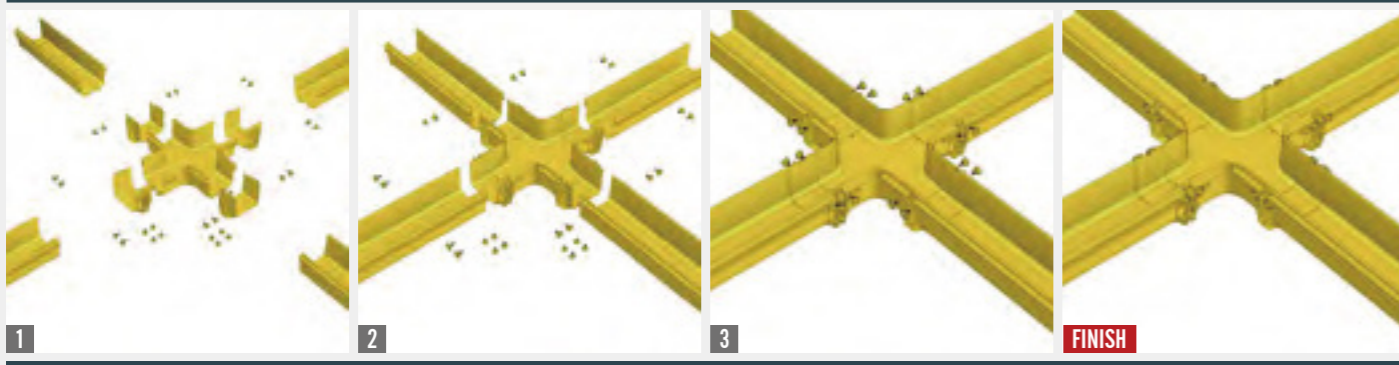

**360/240/120 HORIZONTAL TEE CROSS COVER INSTALLATION**

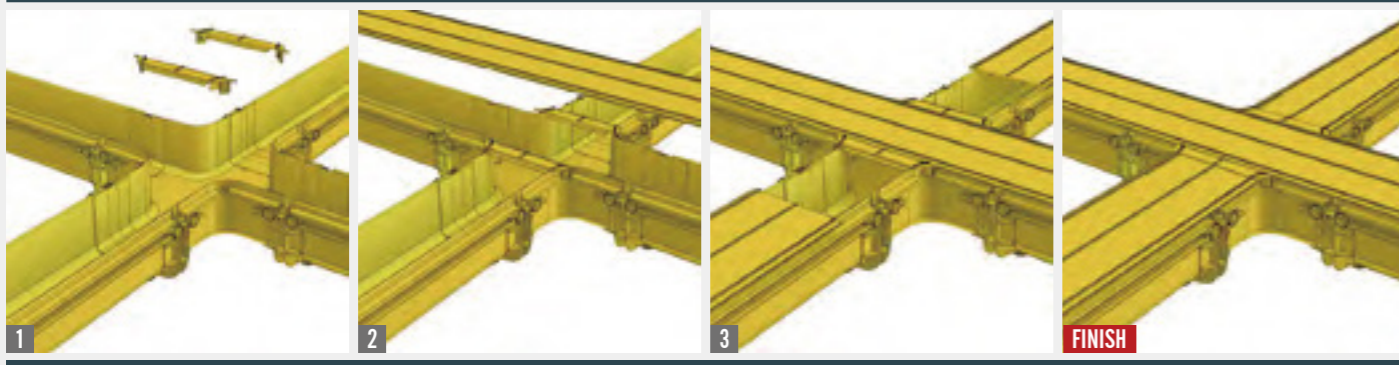

**60 HORIZONTAL CROSS INSTALLATION**

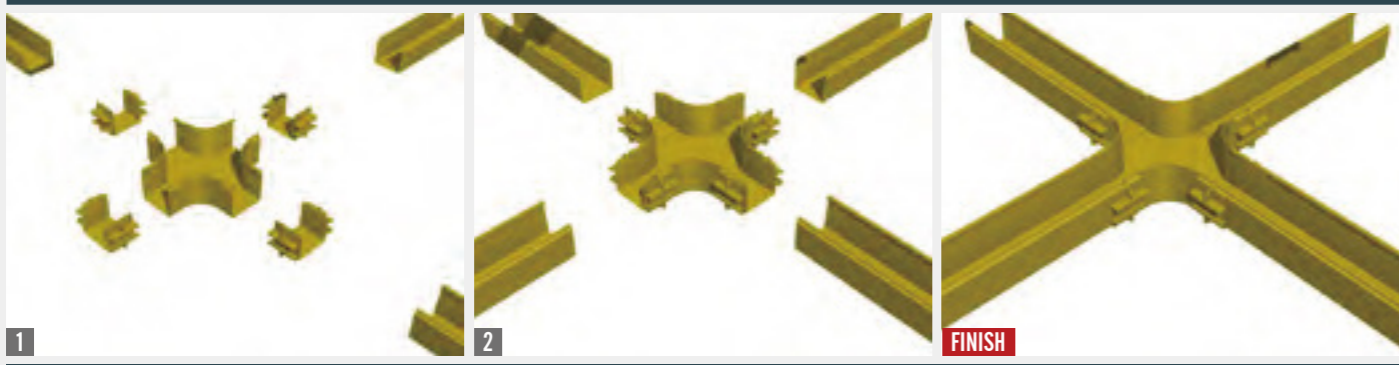

**60 HORIZONTAL CROSS COVER INSTALLATION**

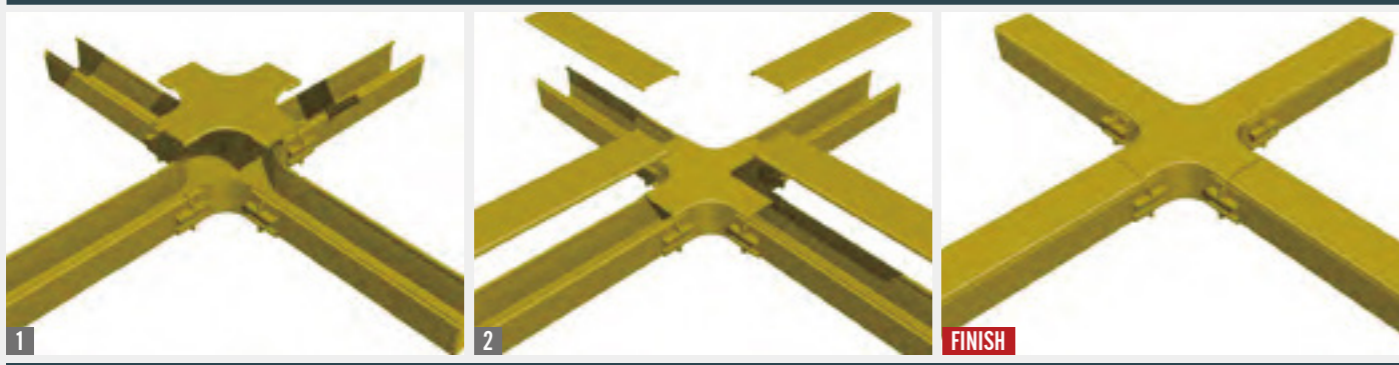

**360 HORIZONTAL 90° ELBOW**

ITEM NO.:	WIDTH		HEIGHT		MATERIAL
	MM	INCH	MM	INCH	
AF01	360	15	100	4	PVC / ABS

ATTACHES TO 4"X15" CHANNEL AND/OR FITTINGS TO CREATE A 90° HORIZONTAL ELBOW FROM A STRAIGHT HORIZONTAL RUN.

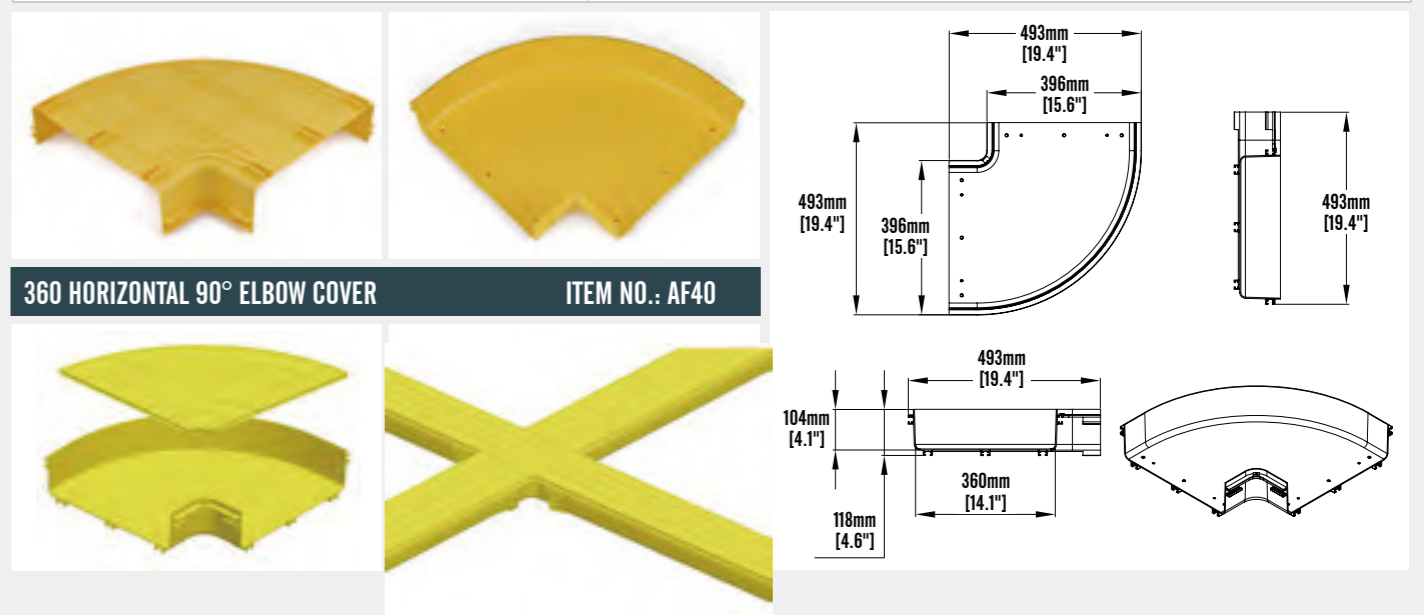

**360 HORIZONTAL 90° ELBOW COVER ITEM NO.: AF40**

**240 HORIZONTAL 90° ELBOW**

ITEM NO.:	WIDTH		HEIGHT		MATERIAL
	MM	INCH	MM	INCH	
AF07	240	10	100	4	PVC / ABS

ATTACHES TO 4"X10" CHANNEL AND/OR FITTINGS TO CREATE A 90° HORIZONTAL ELBOW FROM A STRAIGHT HORIZONTAL RUN.

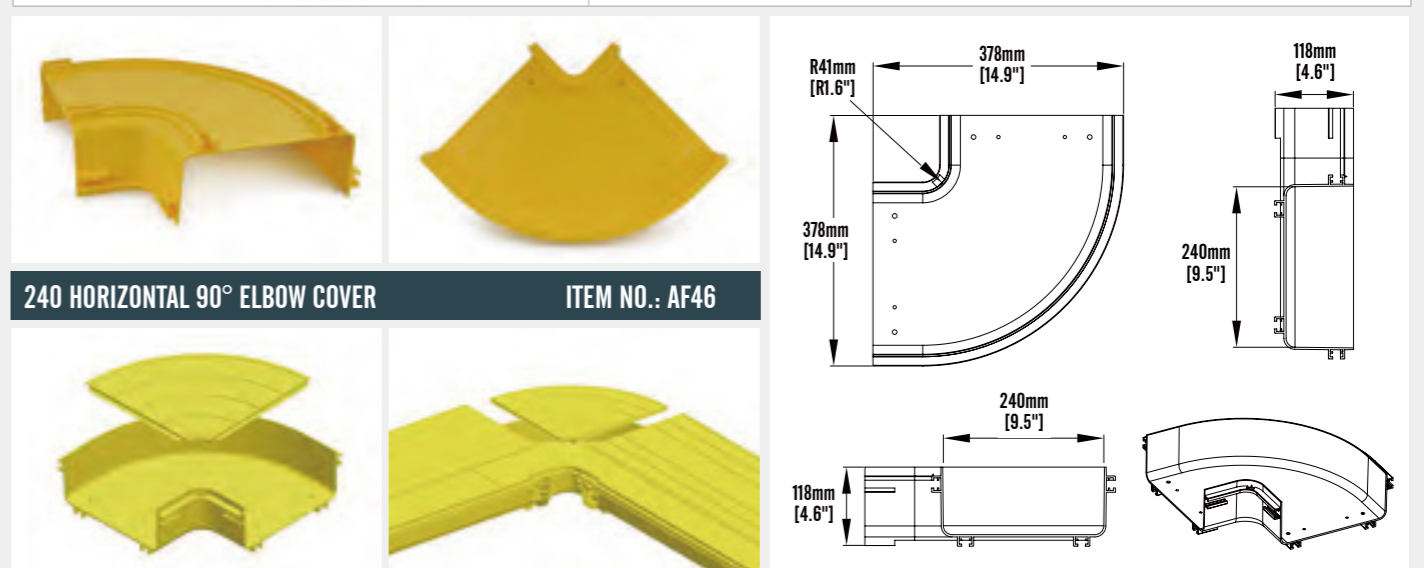

**240 HORIZONTAL 90° ELBOW COVER ITEM NO.: AF46**

## HORIZONTAL 90° ELBOW

### 120 HORIZONTAL 90° ELBOW

ITEM NO.:	WIDTH		HEIGHT		MATERIAL
	MM	INCH	MM	INCH	
AF20	120	5	100	4	PVC / ABS
ATTACHES TO 4"X5" CHANNEL AND/OR FITTINGS TO CREATE A 90° HORIZONTAL ELBOW FROM A STRAIGHT HORIZONTAL RUN.					

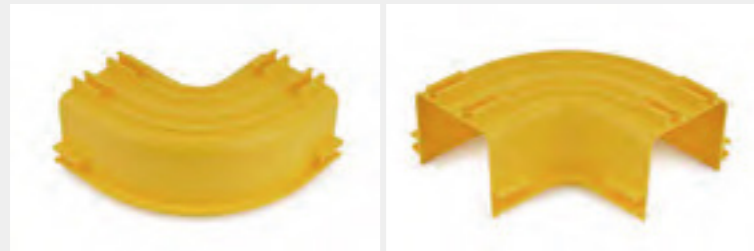

### 120 HORIZONTAL 90° ELBOW COVER

ITEM NO.: AF52

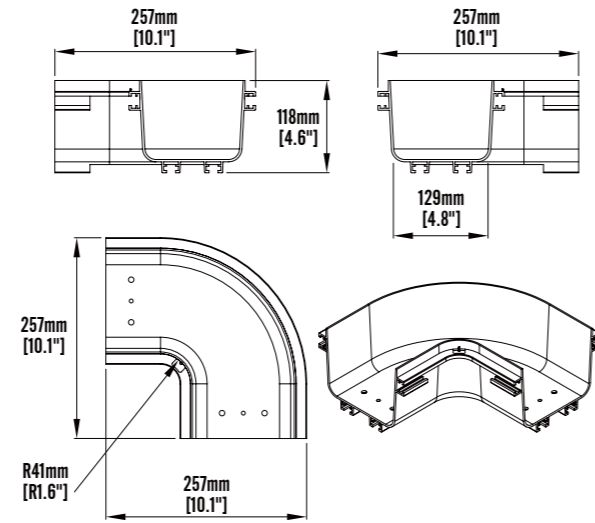
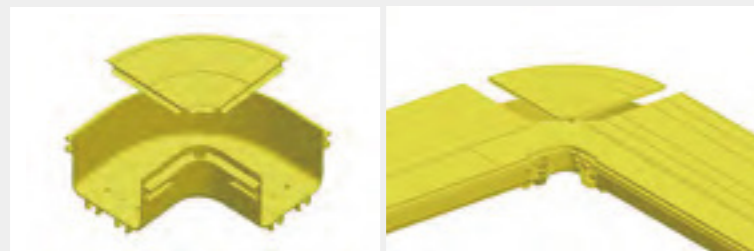

### 60 HORIZONTAL 90° ELBOW

ITEM NO.:	WIDTH		HEIGHT		MATERIAL
	MM	INCH	MM	INCH	
AF69	60	2.36	60	2.36	PVC / ABS
ATTACHES TO 2.36"X2.36" CHANNEL AND/OR FITTINGS TO CREATE A 90° HORIZONTAL ELBOW FROM A STRAIGHT HORIZONTAL RUN.					



### 60 HORIZONTAL 90° ELBOW COVER

ITEM NO.: AF64

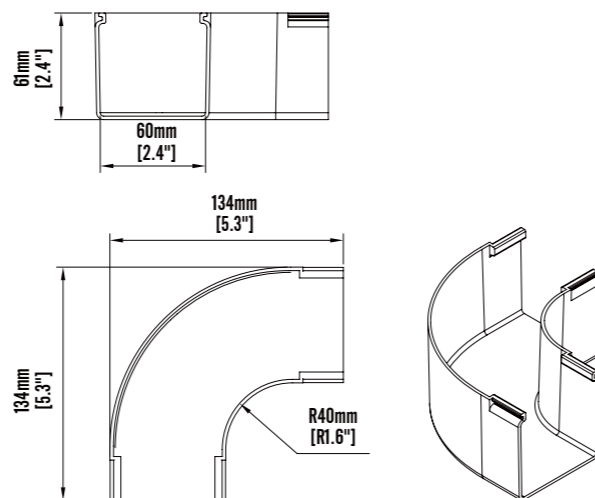
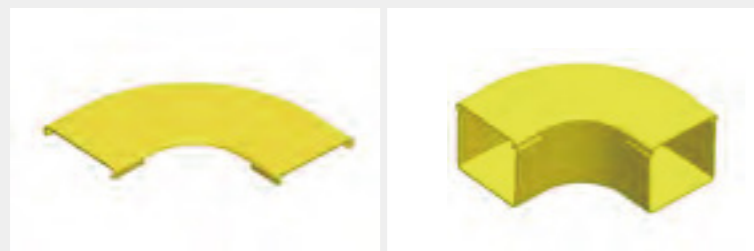

## HORIZONTAL 90° ELBOW

### 360/240/120 HORIZONTAL 90° ELBOW INSTALLATION

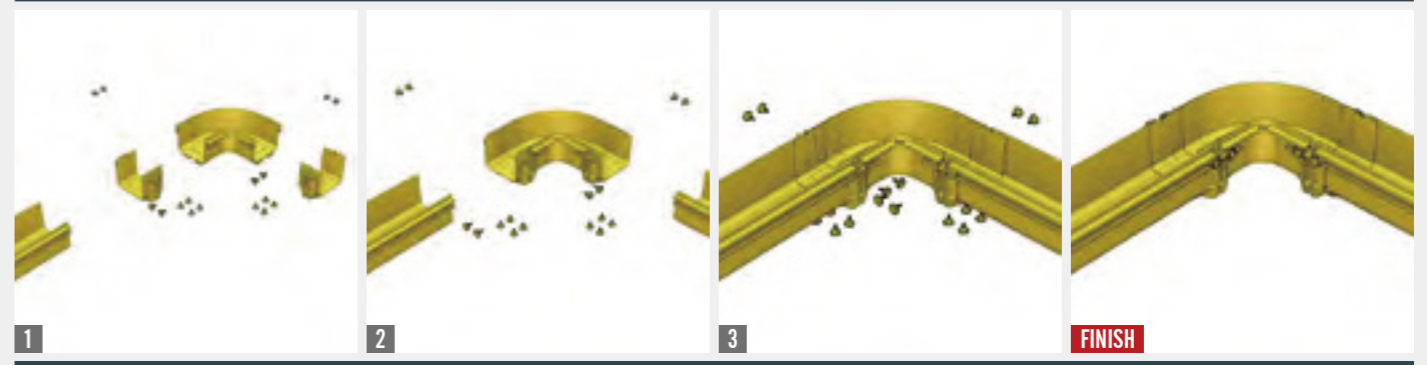

### 360/240/120 HORIZONTAL 90° ELBOW COVER INSTALLATION

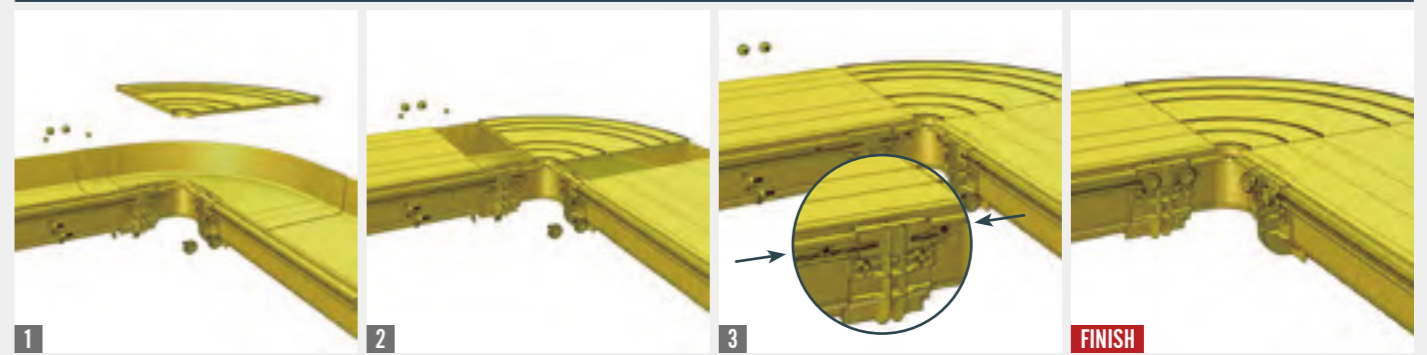

### 60 HORIZONTAL 90° ELBOW INSTALLATION



### 60 HORIZONTAL 90° ELBOW COVER INSTALLATION



## UP ELBOW

### 360 45° UP ELBOW

ITEM NO.:	WIDTH		HEIGHT		MATERIAL
	MM	INCH	MM	INCH	
AF38	360	15	100	4	PVC / ABS

ATTACHES TO 4"X15" CHANNEL AND/OR FITTING TO CREATE A 45° UPWARD ANGLE FROM A STRAIGHT HORIZONTAL RUN. USED WITH 45° DOWN ELBOW TO CHANGE LEVEL OF A HORIZONTAL RUN.

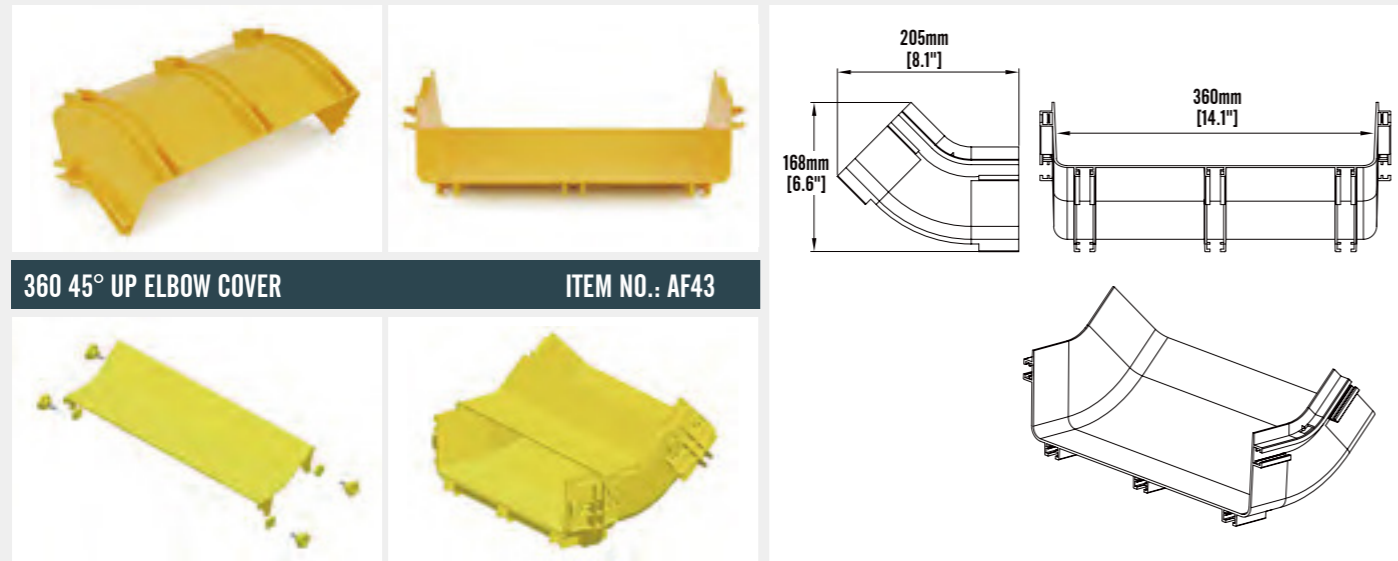

### 360 45° UP ELBOW COVER

ITEM NO.: AF43

## UP ELBOW

### 120 45° UP ELBOW

ITEM NO.:	WIDTH		HEIGHT		MATERIAL
	MM	INCH	MM	INCH	
AF24	120	5	100	4	PVC / ABS

ATTACHES TO 4"X5" CHANNEL AND/OR FITTING TO CREATE A 45° UPWARD ANGLE FROM A STRAIGHT HORIZONTAL RUN. USED WITH 45° DOWN ELBOW TO CHANGE LEVEL OF A HORIZONTAL RUN.

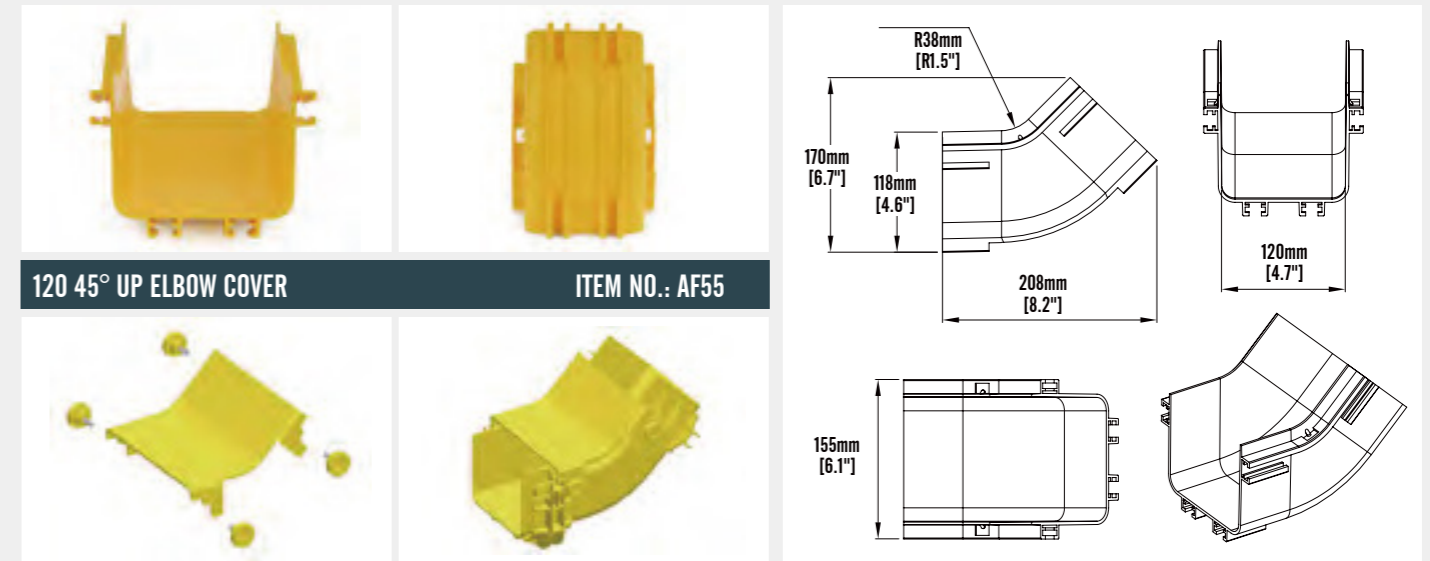

### 120 45° UP ELBOW COVER

ITEM NO.: AF55

### 240 45° UP ELBOW

ITEM NO.:	WIDTH		HEIGHT		MATERIAL
	MM	INCH	MM	INCH	
AF14	240	10	100	4	PVC / ABS

ATTACHES TO 4"X10" CHANNEL AND/OR FITTING TO CREATE A 45° UPWARD ANGLE FROM A STRAIGHT HORIZONTAL RUN. USED WITH 45° DOWN ELBOW TO CHANGE LEVEL OF A HORIZONTAL RUN.

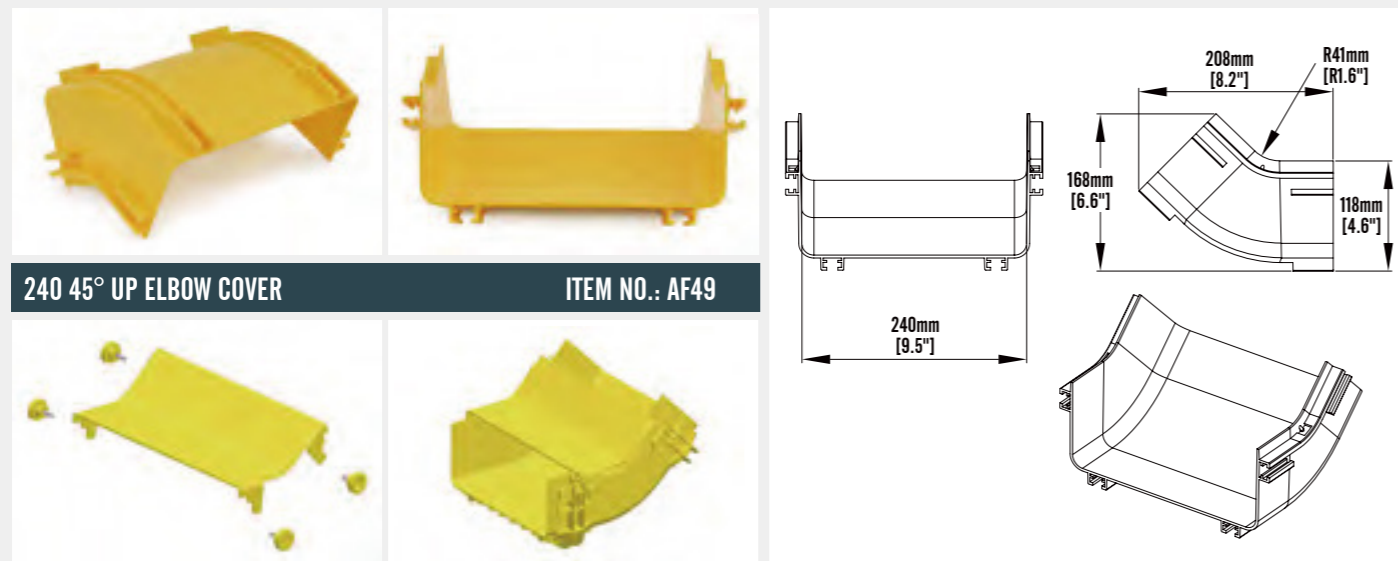

### 240 45° UP ELBOW COVER

ITEM NO.: AF49

### 60 90° UP ELBOW

ITEM NO.:	WIDTH		HEIGHT		MATERIAL
	MM	INCH	MM	INCH	
AF62	60	2.36	60	2.36	PVC / ABS

ATTACHES TO 2.36"X2.36" CHANNEL AND/OR FITTING TO CREATE A 90° UPWARD ANGLE FROM A STRAIGHT HORIZONTAL RUN. USED WITH 90° DOWN ELBOW TO CHANGE LEVEL OF A HORIZONTAL RUN.

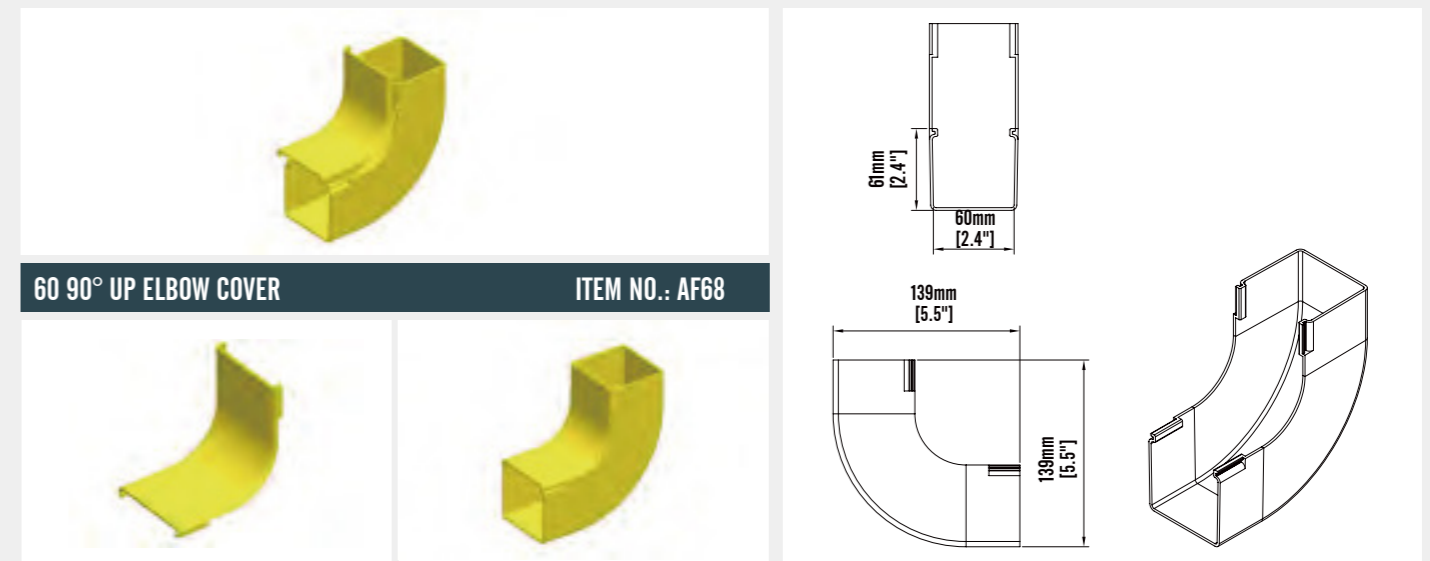

### 60 90° UP ELBOW COVER

ITEM NO.: AF68

#### 360/240/120 45° UP ELBOW INSTALLATION

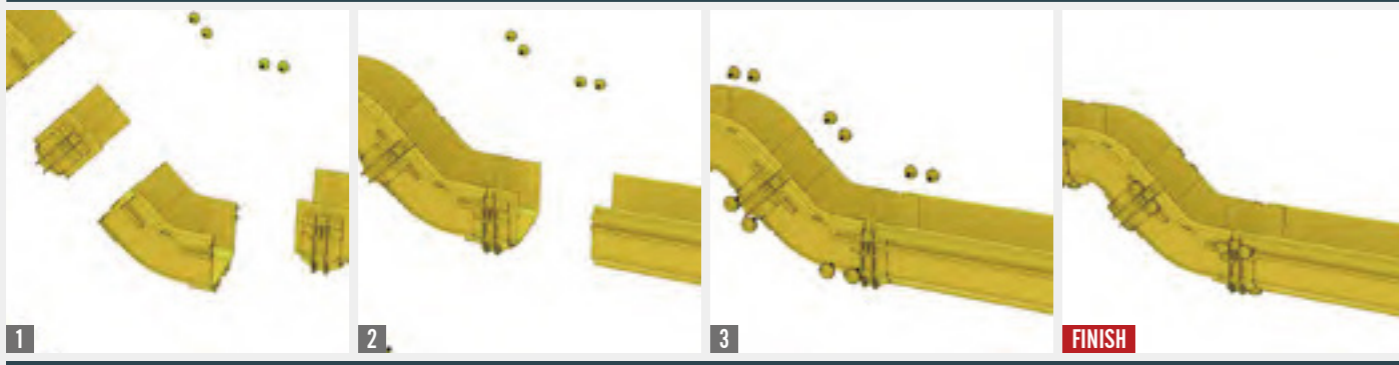

#### 360/240/120 45° UP ELBOW COVER INSTALLATION

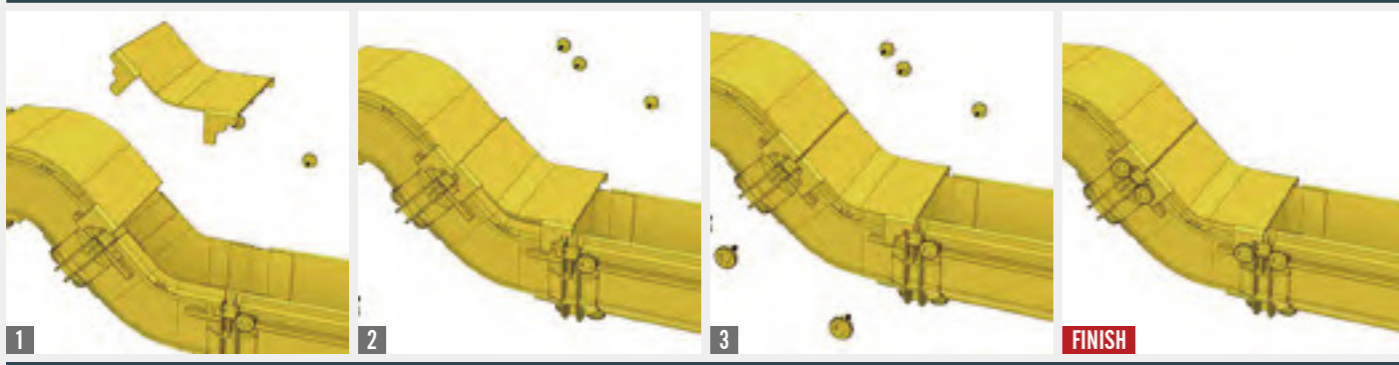

#### 60 90° UP ELBOW INSTALLATION

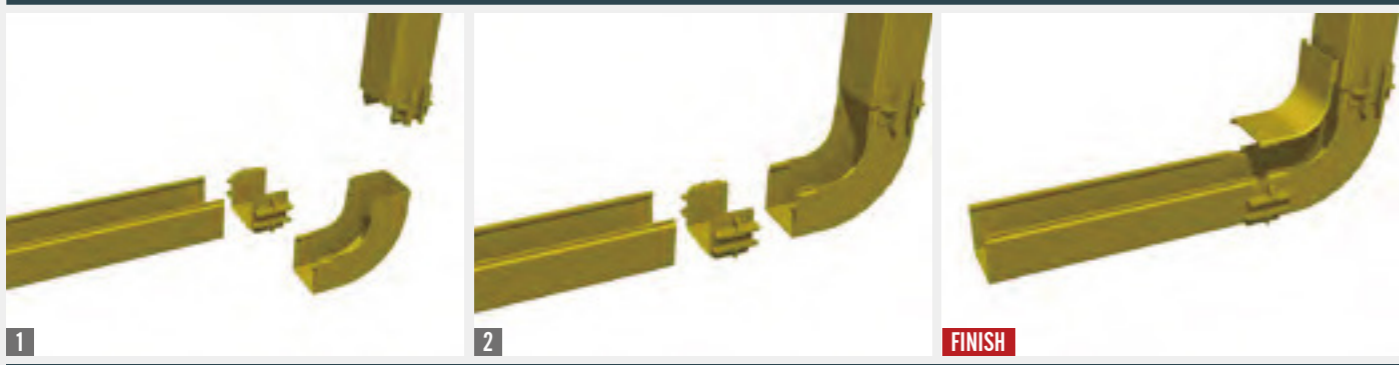

#### 60 90° UP ELBOW COVER INSTALLATION



#### 360 45° DOWN ELBOW



ITEM NO.:	WIDTH		HEIGHT		MATERIAL
	MM	INCH	MM	INCH	
AF37	360	15	100	4	PVC / ABS

ATTACHES TO 4"X15" CHANNEL AND/OR FITTING TO CREATE A 45° DOWNWARD ANGLE FROM A STRAIGHT HORIZONTAL RUN. USED WITH 45° UP ELBOW TO CHANGE LEVEL OF A HORIZONTAL RUN.



#### 360 45° DOWN ELBOW COVER

ITEM NO.: AF42

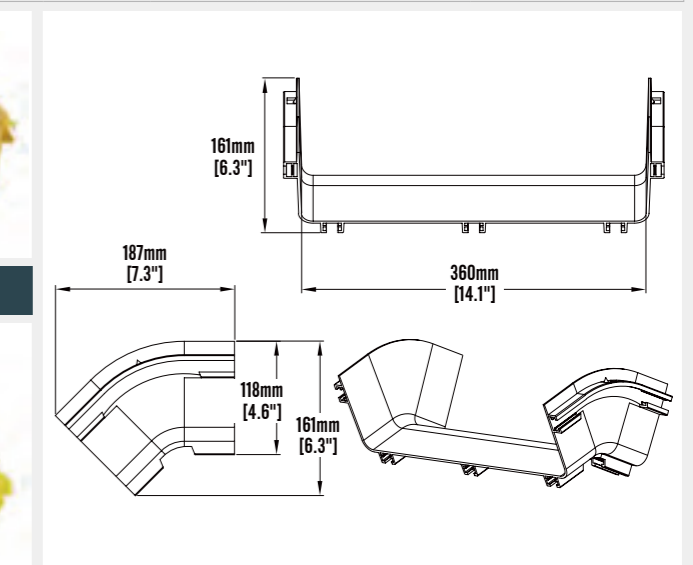

#### 240 45° DOWN ELBOW



ITEM NO.:	WIDTH		HEIGHT		MATERIAL
	MM	INCH	MM	INCH	
AF13	240	10	100	4	PVC / ABS

ATTACHES TO 4"X10" CHANNEL AND/OR FITTING TO CREATE A 45° DOWNWARD ANGLE FROM A STRAIGHT HORIZONTAL RUN. USED WITH 45° UP ELBOW TO CHANGE LEVEL OF A HORIZONTAL RUN.



#### 240 45° DOWN ELBOWCOVER

ITEM NO.: AF48

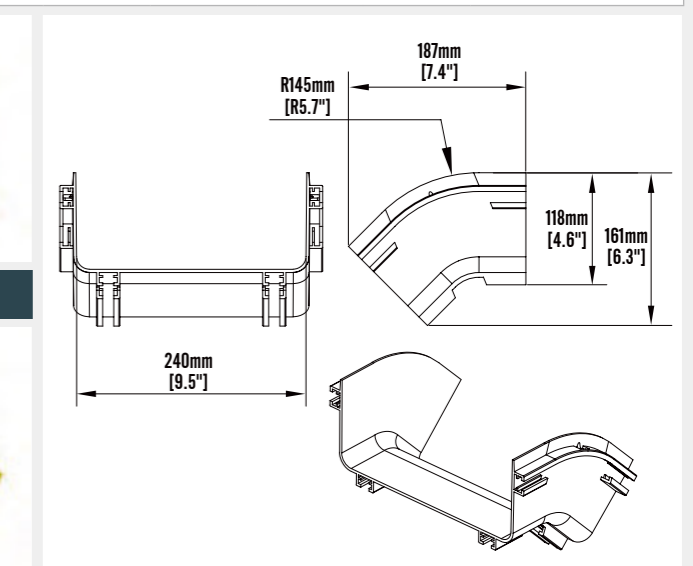

## DOWN ELBOW

### 120 45° DOWN ELBOW

ITEM NO.:	WIDTH		HEIGHT		MATERIAL
	MM	INCH	MM	INCH	
AF23	120	5	100	4	PVC / ABS

ATTACHES TO 4"x5" CHANNEL AND/OR FITTING TO CREATE A 45° DOWNWARD ANGLE FROM A STRAIGHT HORIZONTAL RUN. USED WITH 45° UP ELBOW TO CHANGE LEVEL OF A HORIZONTAL RUN.

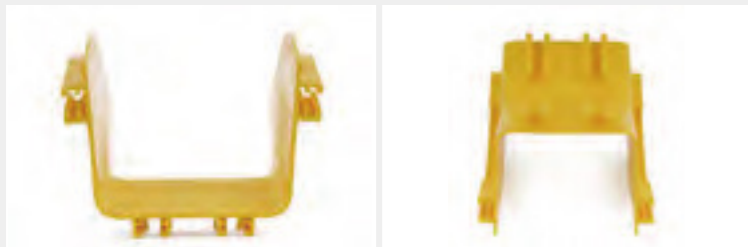

### 120 45° DOWN ELBOW COVER

ITEM NO.: AF54

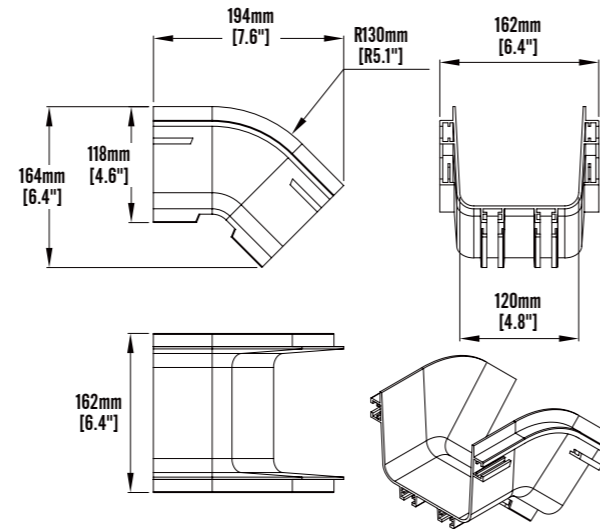
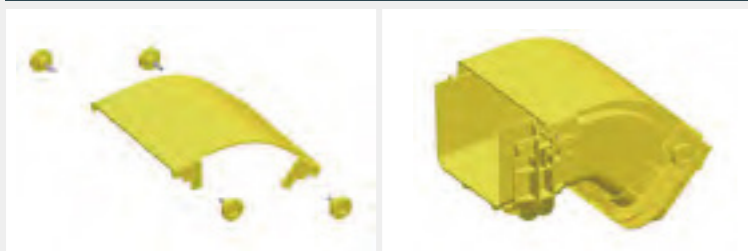

### 60 90° DOWN ELBOW

ITEM NO.:	WIDTH		HEIGHT		MATERIAL
	MM	INCH	MM	INCH	
AF61	60	2.36	60	2.36	PVC / ABS

ATTACHES TO 2.36"x2.36" CHANNEL AND/OR FITTING TO CREATE A 90° DOWNWARD ANGLE FROM A STRAIGHT HORIZONTAL RUN. USED WITH 90° UP ELBOW TO CHANGE LEVEL OF A HORIZONTAL RUN.



### 60 90° DOWN ELBOW COVER

ITEM NO.: AF67

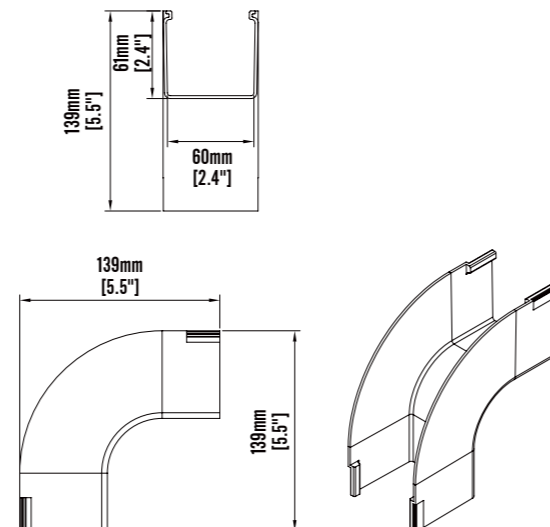
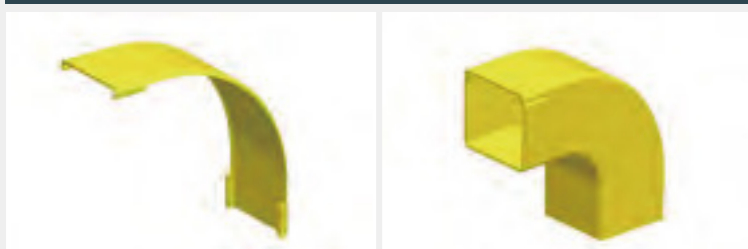

## DOWN ELBOW

### 360/240/120 45° DOWN ELBOW INSTALLATION

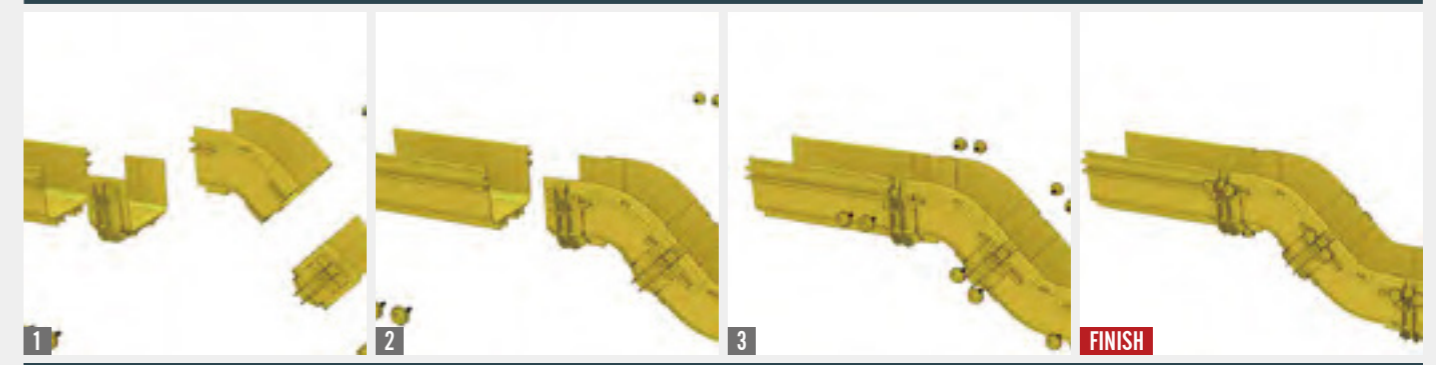

### 360/240/120 45° DOWN ELBOW COVER INSTALLATION

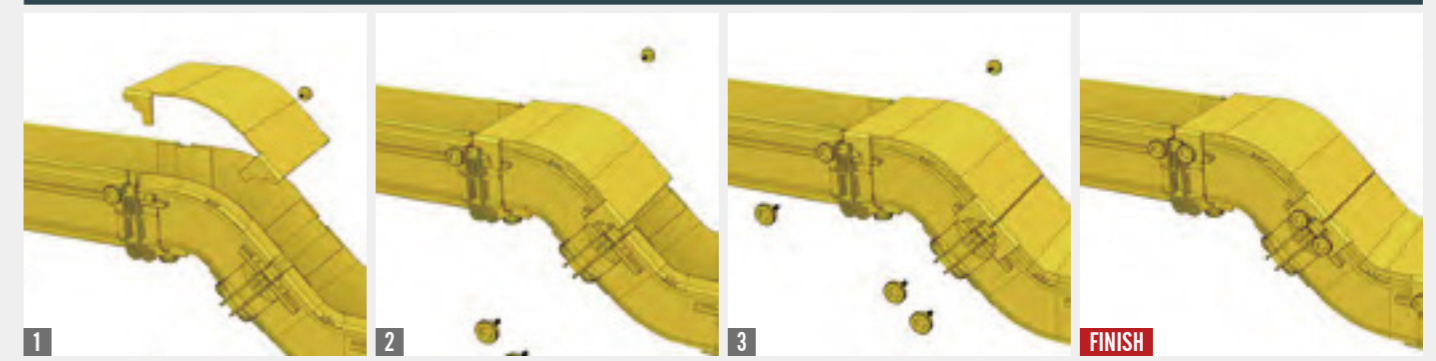

### 60 90° DOWN ELBOW INSTALLATION



### 60 90° DOWN ELBOW COVER INSTALLATION



## 360 TO 240 ADAPTER

ITEM NO.:	WIDTH		HEIGHT		MATERIAL
	MM	INCH	MM	INCH	
AF04	360	15	100	4	PVC / ABS
ATTACHES ANY 4"X15" FITTING OR CHANNEL TO ANY 4"X10" FITTING OR CHANNEL.					



## 360 TO 240 ADAPTER COVER

ITEM NO.: AF44

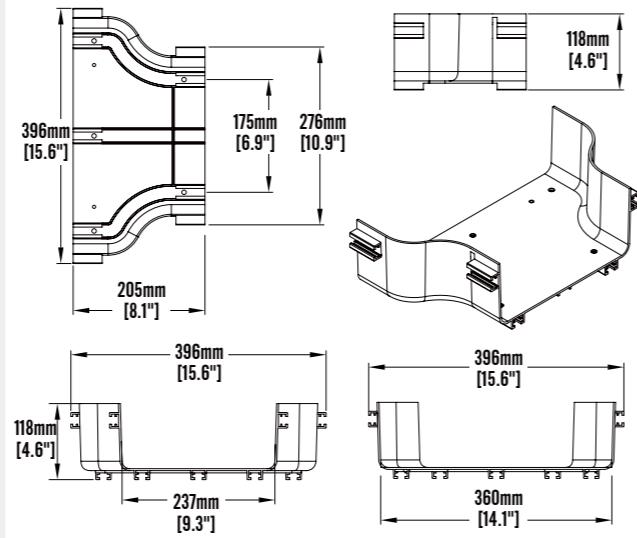
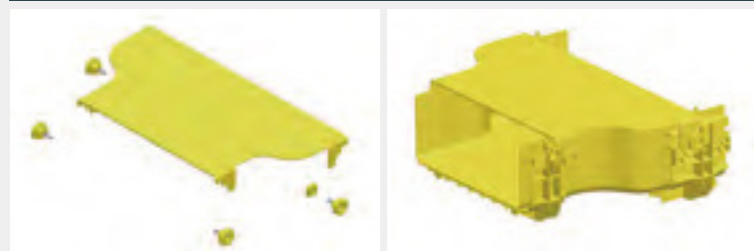

## 240 TO 120 ADAPTER

ITEM NO.:	WIDTH		HEIGHT		MATERIAL
	MM	INCH	MM	INCH	
AF15	240	10	100	4	PVC / ABS
ATTACHES ANY 4"X10" FITTING OR CHANNEL TO ANY 4"X5" FITTING OR CHANNEL.					



## 240 TO 120 ADAPTER COVER

ITEM NO.: AF50

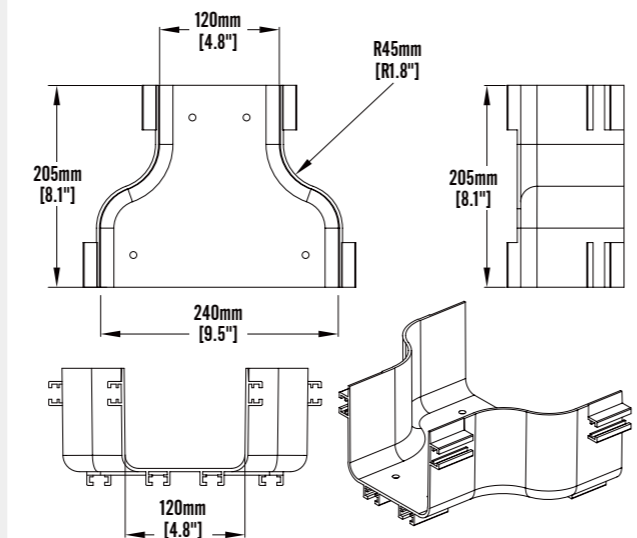
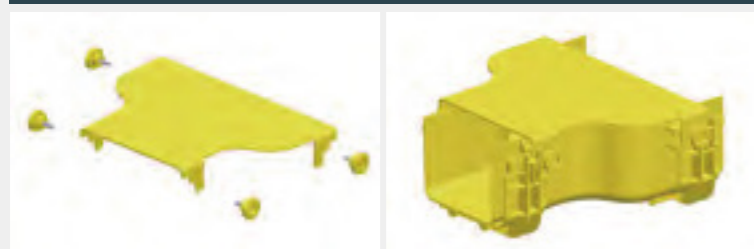

## 360 TO 240 ADAPTER AND 240 TO 120 ADAPTER INSTALLATION

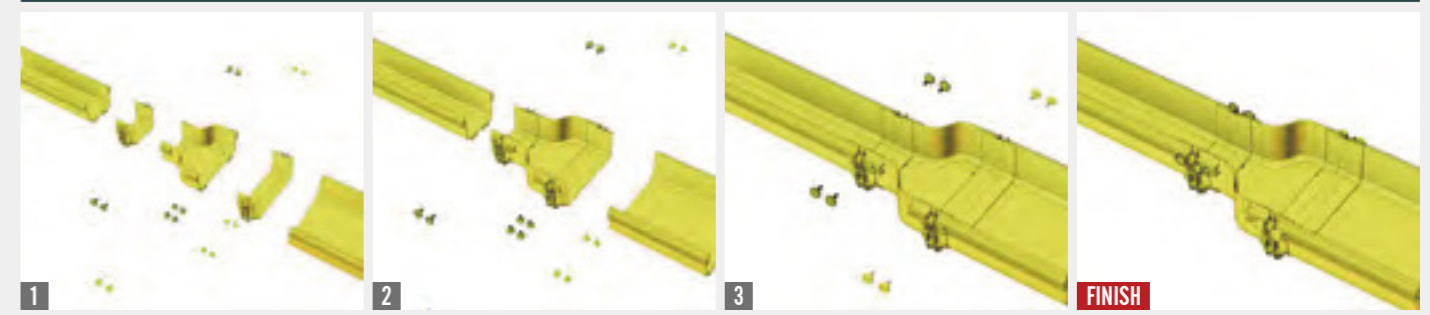

## 360 TO 240 ADAPTER COVER AND 240 TO 120 ADAPTER COVER INSTALLATION

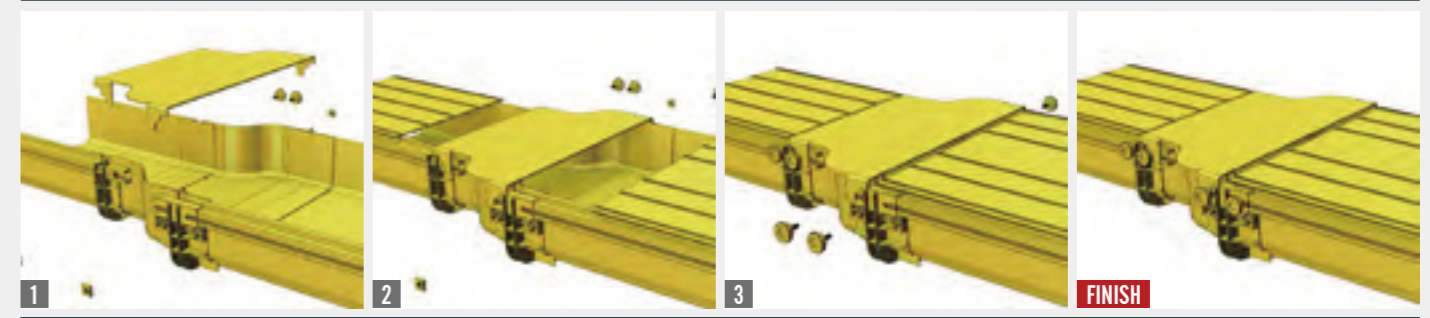

## 240 TO 120 VERTICAL TEE

ITEM NO.:	WIDTH		HEIGHT		MATERIAL
	MM	INCH	MM	INCH	
AF10	240	10	100	4	PVC / ABS
ATTACHES TO 4"X10" CHANNEL AND/OR FITTINGS TO CREATE A 4"X5" 90° VERTICAL DROP FROM A HORIZONTAL RUN					



## 240 TO 120 VERTICAL TEE INSTALLATION

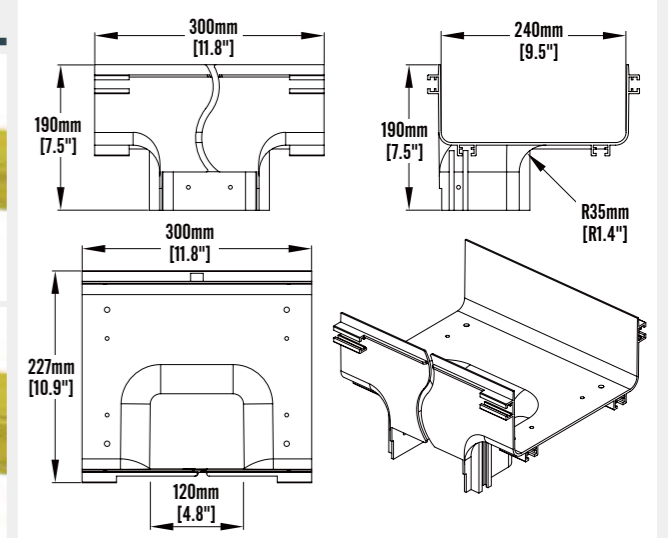
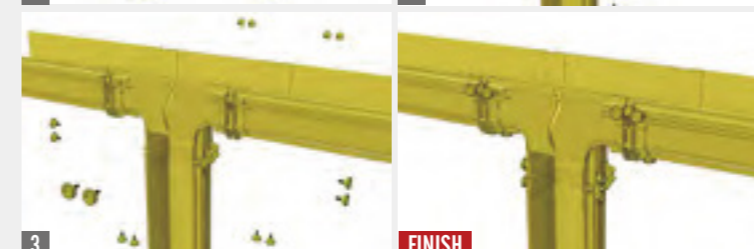

## 240 TO 120 HORIZONTAL TEE

ITEM NO.:	WIDTH		HEIGHT		MATERIAL
	MM	INCH	MM	INCH	
AF11	240	10	100	4	PVC / ABS
ATTACHES TO 4"X10" CHANNEL AND/OR FITTINGS TO CREATE A 90° HORIZONTAL BRANCH WITH A 4"X5" EXIT FROM STRAIGHT HORIZONTAL RUN.					

## 240 TO 120 HORIZONTAL TEE INSTALLATION

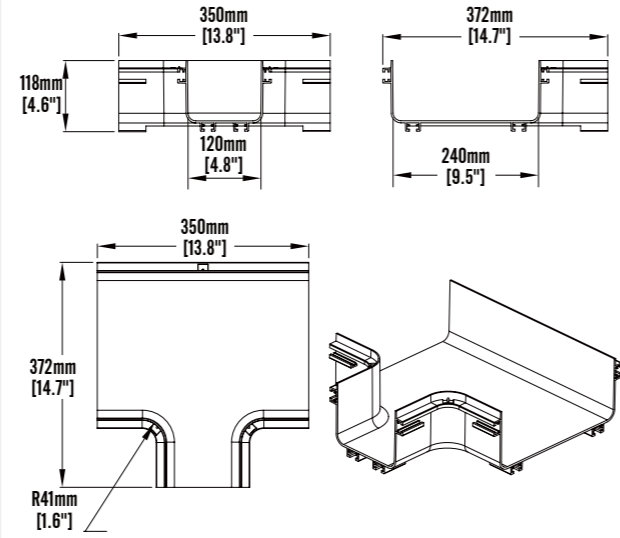
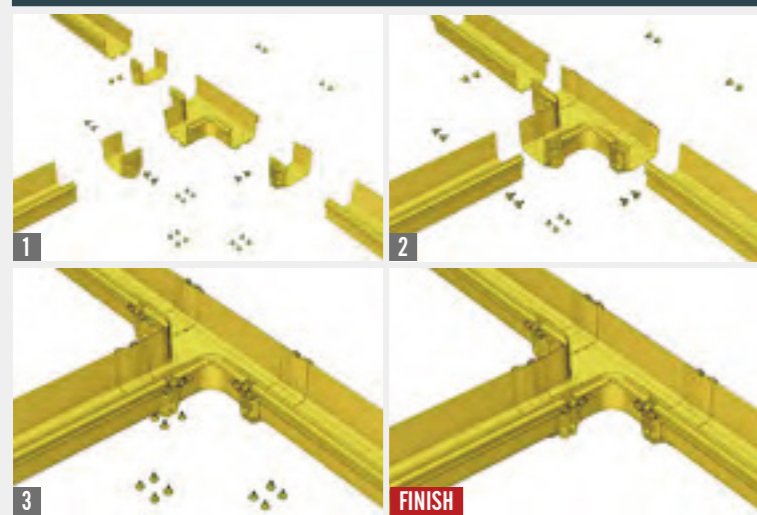

## 240 TO 120 HORIZONTAL CROSS

ITEM NO.:	WIDTH		HEIGHT		MATERIAL
	MM	INCH	MM	INCH	
AF12	240	10	100	4	PVC / ABS
ATTACHES TO 4"X10" CHANNEL AND/OR FITTINGS TO CREATE A HORIZONTAL FOUR WAY CROSS INTERSECTION WITH TWO 4"X5" EXITS.					

## 240 TO 120 HORIZONTAL CROSS INSTALLATION

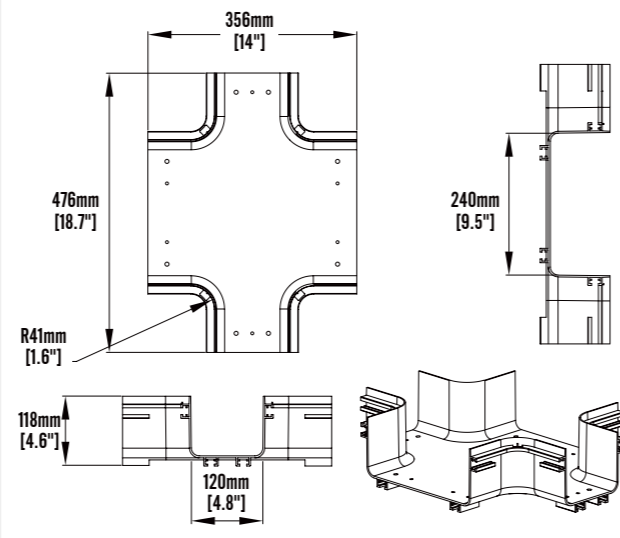
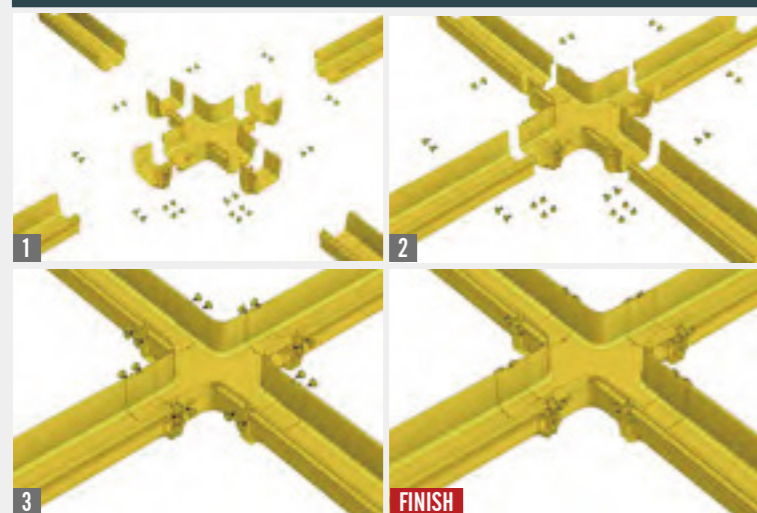

## 90 MOVABLE EXIT W/O CORRUGATED PIPE KIT

ITEM NO.:	WIDTH		HEIGHT		MATERIAL
	MM	INCH	MM	INCH	
ADK01	90	3.6	143	5.6	PVC / ABS
ASSEMBLES ONTO 4"X5", 4"X10", 4"X15" CHANNEL, SPILLING OVER THE SIDE INTO A 90MM MOVABLE EXIT WITHOUT CORRUGATED PIPE					

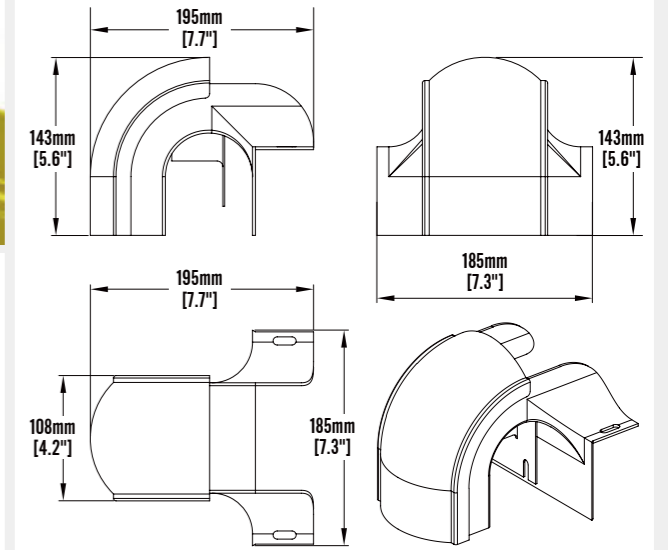
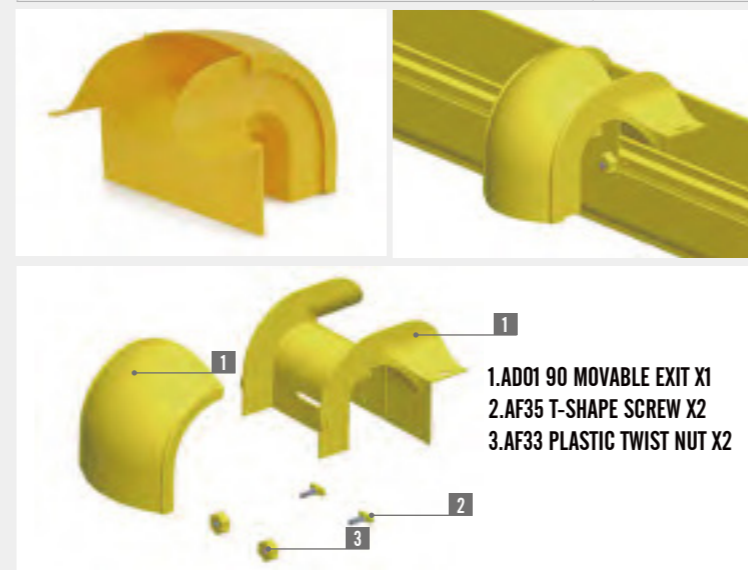

## 90 MOVABLE EXIT WITH CORRUGATED PIPE KIT

ITEM NO.:	WIDTH		HEIGHT		MATERIAL
	MM	INCH	MM	INCH	
ADK02	90	3.6	143	5.6	PVC / ABS
ASSEMBLES ONTO 4"X5", 4"X10", 4"X15" CHANNEL, SPILLING OVER THE SIDE INTO A 90MM MOVABLE EXIT WITH CORRUGATED PIPE					

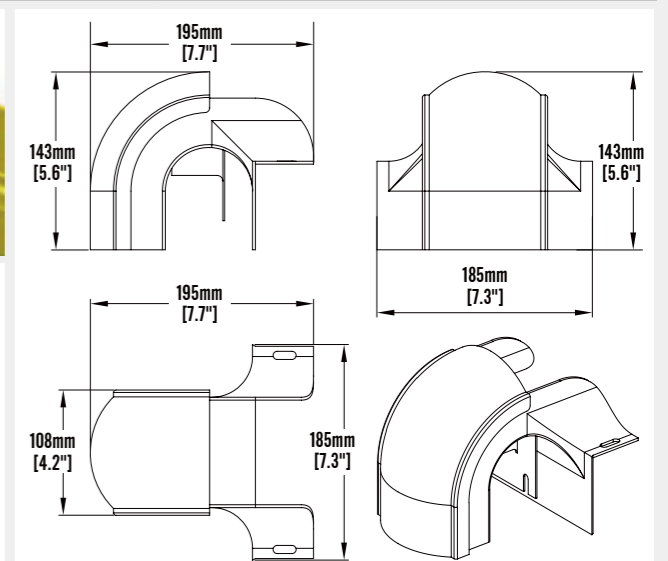
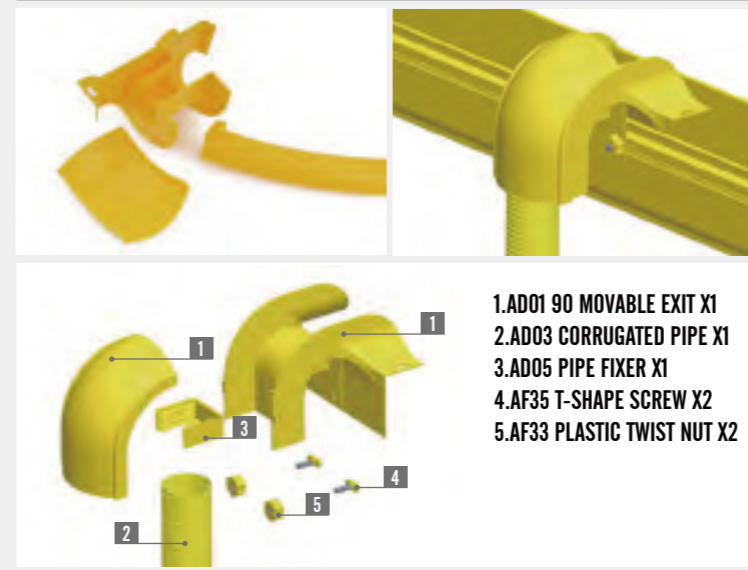



## 130 MOVABLE EXIT KIT

ITEM NO.:	WIDTH		HEIGHT		MATERIAL
	MM	INCH	MM	INCH	
ADK03	130	5.2	153	6	PVC / ABS

ASSEMBLES ONTO 4"X5", 4"X10", 4"X15" CHANNEL, SPILLING OVER THE SIDE INTO A 130MM MOVABLE EXIT

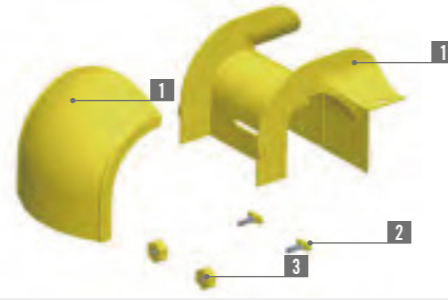
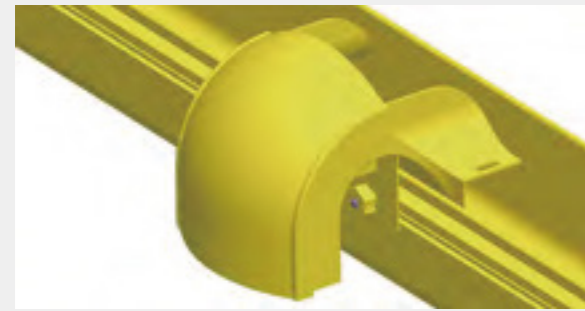

- 1.AD02 130 MOVABLE EXIT X1
- 2.AF35 T-SHAPE SCREW X2
- 3.AF33 PLASTIC TWIST NUT X2

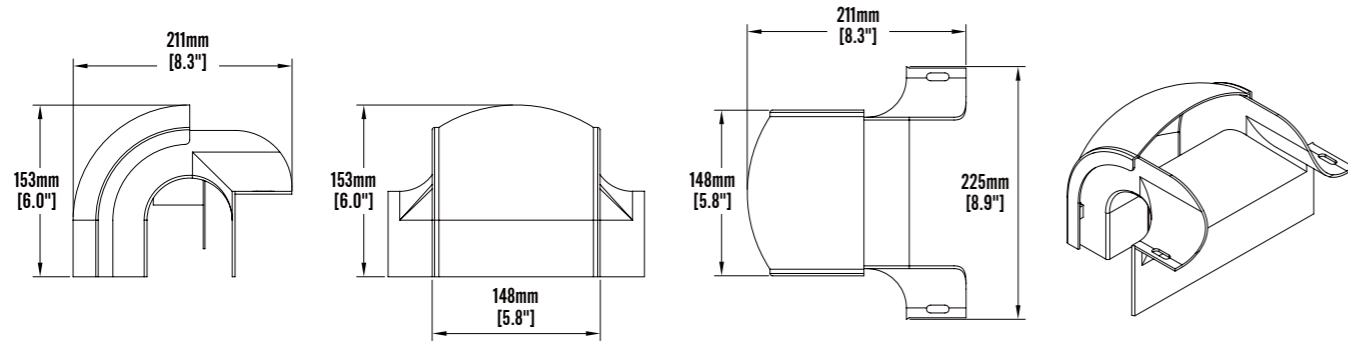

## MOVABLE EXIT KIT INSTALLATION



## 60 MOVABLE EXIT KIT

ITEM NO.:	WIDTH		HEIGHT		MATERIAL
	MM	INCH	MM	INCH	
			200	8	PVC / ABS

ASSEMBLES ONTO 4"X5", 4"X10", 4"X15" CHANNEL, SPILLING OVER THE SIDE INTO A 130MM MOVABLE EXIT

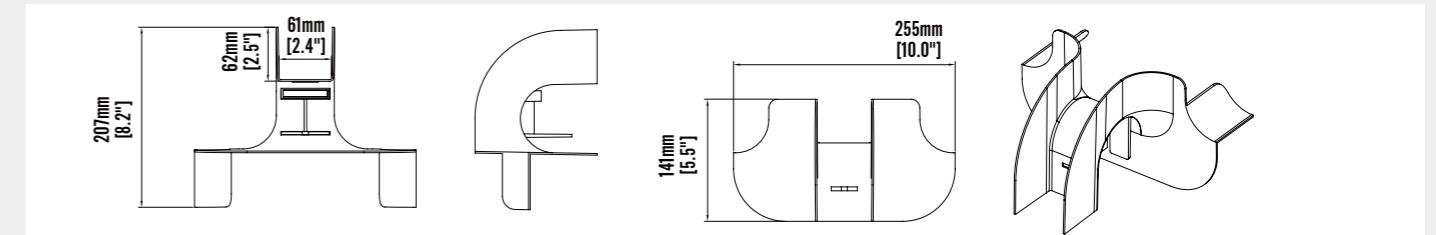

## 120 TO 60 MOVABLE EXIT KIT

ITEM NO.: ADK05

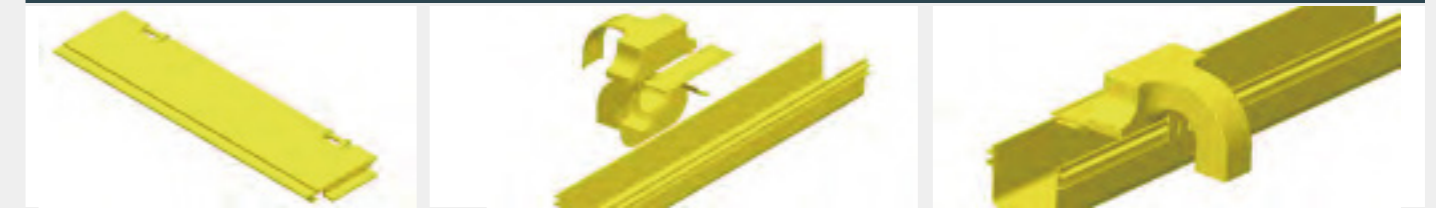

## 240 TO 60 MOVABLE EXIT KIT

ITEM NO.: ADK06

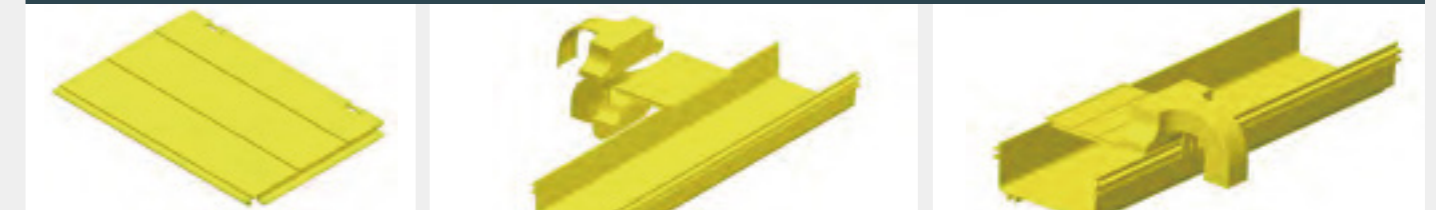



## 60 MOVABLE EXIT KIT INSTALLATION



## 120 TRUMPET SPILLOUT KIT

ITEM NO.:	WIDTH		HEIGHT		MATERIAL
	MM	INCH	MM	INCH	
ADK04	120	5	125	5	PVC / ABS

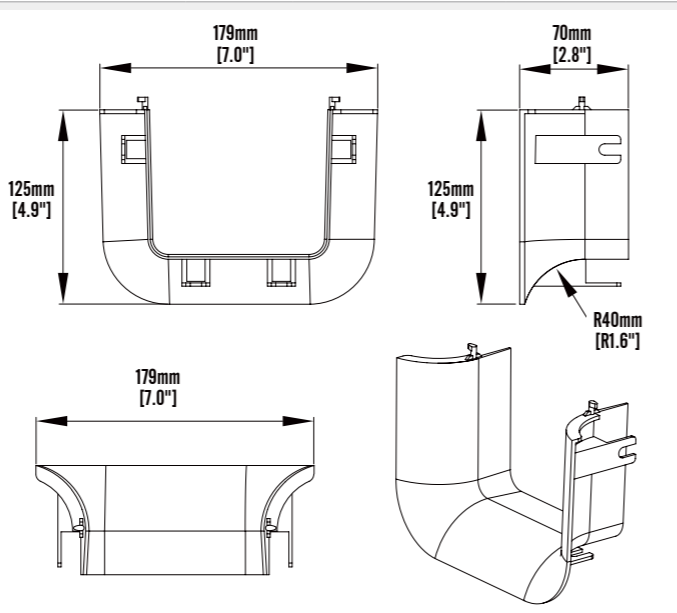
USED TO LIMIT THE BEND RADIUS OF THE CABLE TO 2" (50.8MM) WHEN EXITING FROM 4"X5" CHANNEL, 4"X5" HORIZONTAL TEE FITTING, OR 4"X5" EXIT ON 4"X10" VERTICAL TEE.

1.1.AD04 120 TRUMPET SPILLOUT X1  
2.AF35 T-SHAPE SCREW X4  
3.AF33 PLASTIC TWIST NUT X4

## 120 TRUMPET SPILLOUT KIT INSTALLATION



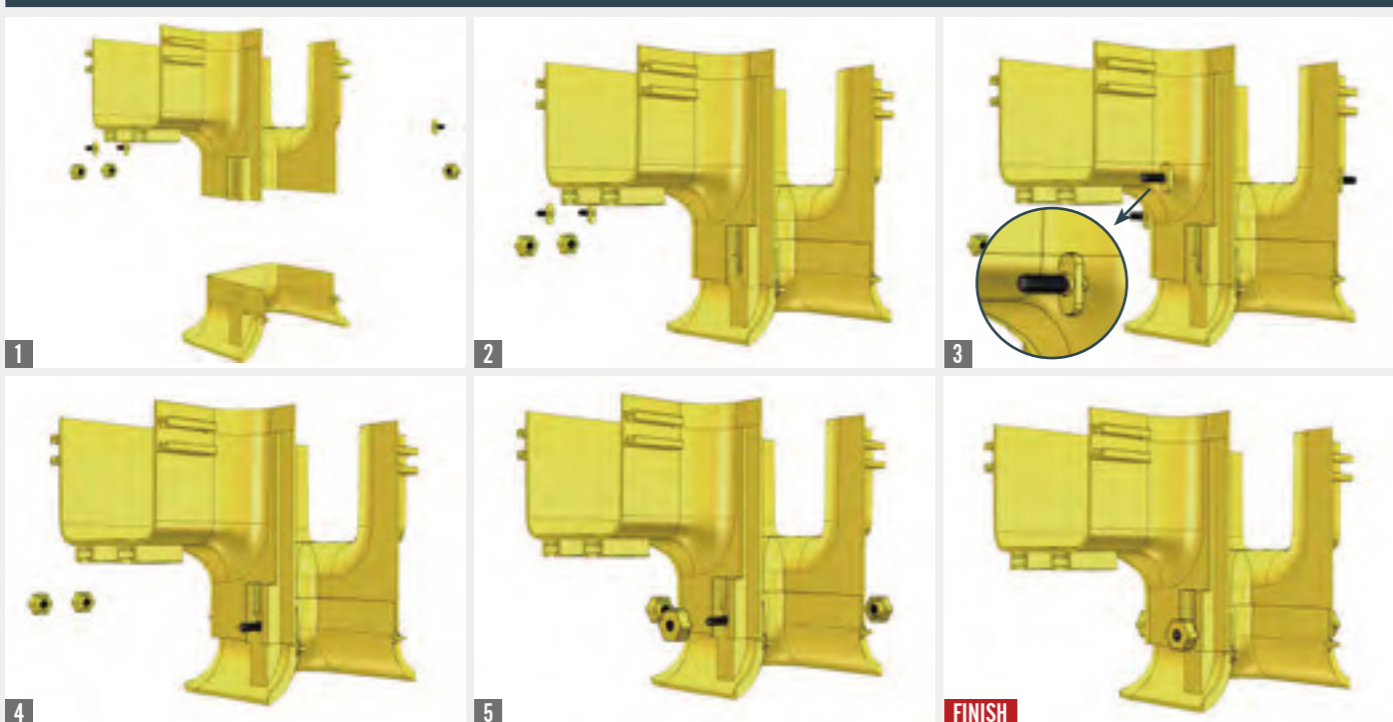

1 2 3 4 5 **FINISH**

## 360 END CAP KIT

ITEM NO.:	WIDTH		HEIGHT		MATERIAL
	MM	INCH	MM	INCH	
AFK01	360	15	100	4	PVC / ABS

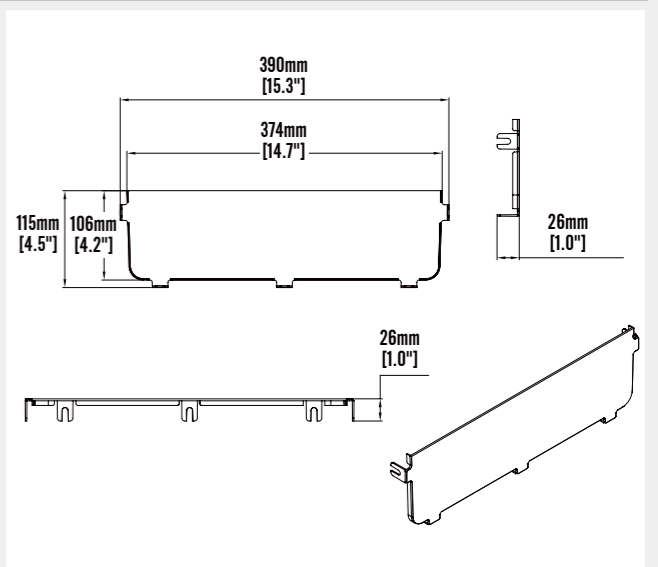
USED FOR CLOSING OFF OPEN ENDS OF THE CHANNEL OR FITTINGS.





1.AF05 360 END CAP X1  
2.AF35 T-SHAPE SCREW X5  
3.AF33 PLASTIC TWIST NUT X5

## 240 END CAP KIT

ITEM NO.:	WIDTH		HEIGHT		MATERIAL
	MM	INCH	MM	INCH	
AFK03	240	10	100	4	PVC / ABS

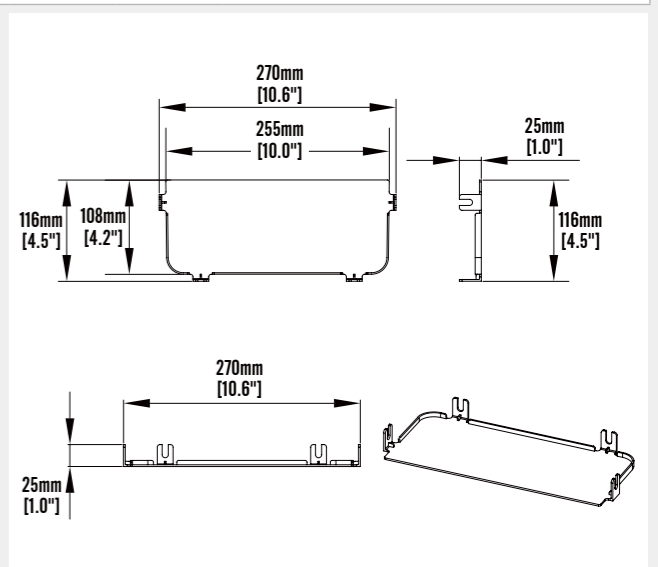
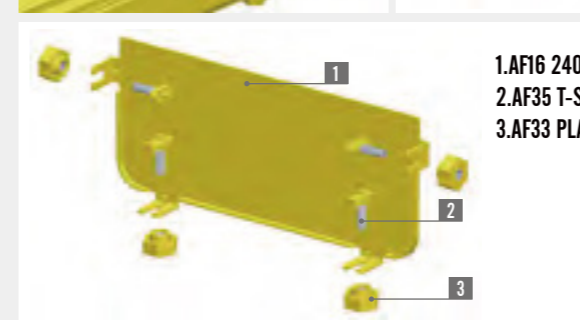
USED FOR CLOSING OFF OPEN ENDS OF THE CHANNEL OR FITTINGS.

1.AF16 240 END CAP X1  
2.AF35 T-SHAPE SCREW X4  
3.AF33 PLASTIC TWIST NUT X4

#### 120 END CAP KIT

	ITEM NO.:	WIDTH		HEIGHT		MATERIAL
		MM	INCH	MM	INCH	
	AFK07	120	5	100	4	PVC / ABS
USED FOR CLOSING OFF OPEN ENDS OF THE CHANNEL OR FITTINGS.						

- 1. AF26 120 END CAP X1
- 2. AF35 T-SHAPE SCREW X4
- 3. AF33 PLASTIC TWIST NUT X4

#### 60 END CAP KIT

	ITEM NO.:	WIDTH		HEIGHT		MATERIAL
		MM	INCH	MM	INCH	
	AF71	60	2.36	60	2.36	PVC / ABS
USED FOR CLOSING OFF OPEN ENDS OF THE CHANNEL OR FITTINGS.						

#### 360/240/120 END CAP KIT INSTALLATION

1

2

3

4

FINISH

#### 60 END CAP KIT INSTALLATION

1

2

3

4

FINISH

**300-1 LADDER RACK SUPPORT KIT**

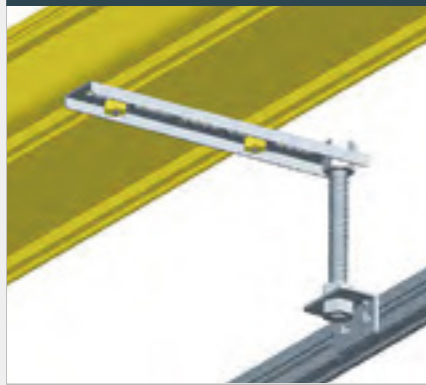

ITEM NO.:	LENGTH		WIDTH		MATERIAL
	MM	INCH	MM	INCH	
AMK02	350	14	50	2	STEEL

USED TO SUPPORT THE 4"x10" SYSTEM BY SPANNING TWO EXISTING THREADED ROD DROPS. CAN BE INSTALLED FROM ABOVE OR BELOW.

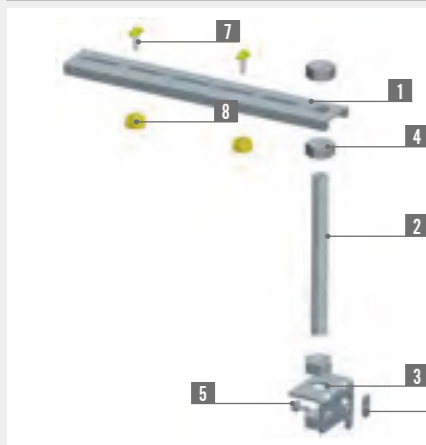

- 1.AM02 300 SUPPORT BAR X1
- 2.T001 M20 \*200MM THREADED ROD X1
- 3.T002 L-STEEL X1
- 4.T003 M20 NUT X4
- 5.T004 M6\*14 FLANGE SCREWS X2
- 6.T005 M6 WAIST-SHAPE NUT X2
- 7.AF35 T-SHAPE SCREW X2
- 8.AF33 PLASTIC TWIST NUT X2

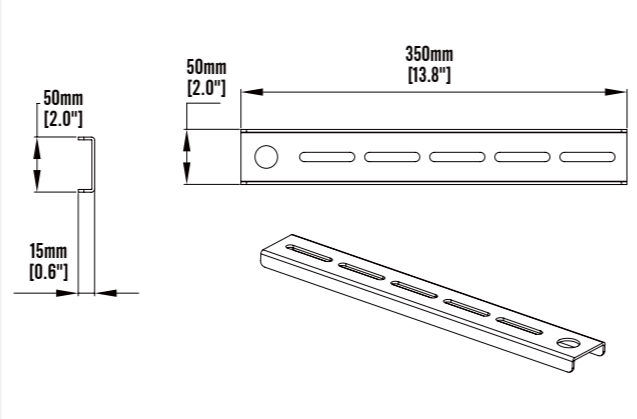

**LADDER RACK SUPPORT KIT INSTALLATION**

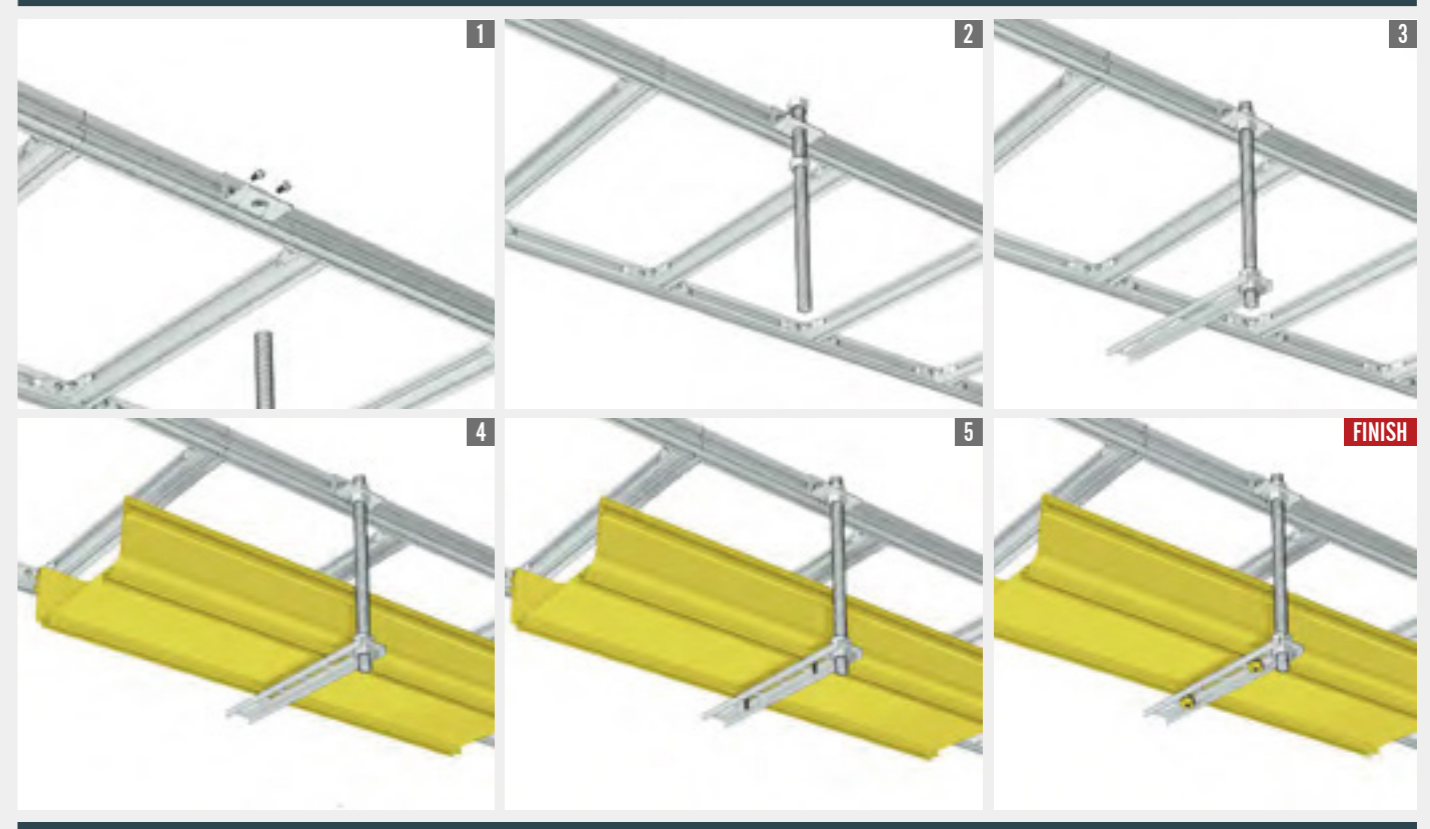

**230-1 LADDER RACK SUPPORT KIT**



ITEM NO.:	LENGTH		WIDTH		MATERIAL
	MM	INCH	MM	INCH	
AMK03	230	9	50	2	STEEL

USED TO SUPPORT THE 4"x5" SYSTEM BY SPANNING TWO EXISTING THREADED ROD DROPS. CAN BE INSTALLED FROM ABOVE OR BELOW.

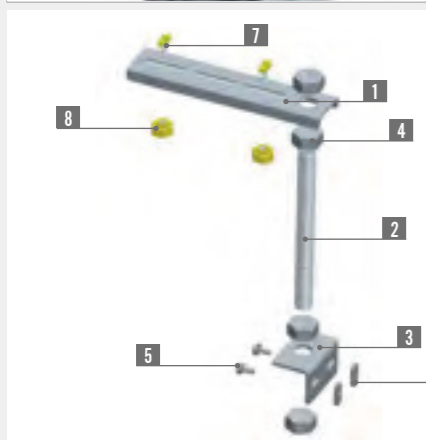

- 1.AM03 230 SUPPORT BAR X1
- 2.T001 M20 \*200MM THREADED ROD X1
- 3.T002 L-STEEL X1
- 4.T003 M20 NUT X4
- 5.T004 M6\*14 FLANGE SCREWS X2
- 6.T005 M6 WAIST-SHAPE NUT X2
- 7.AF35 T-SHAPE SCREW X2
- 8.AF33 PLASTIC TWIST NUT X2

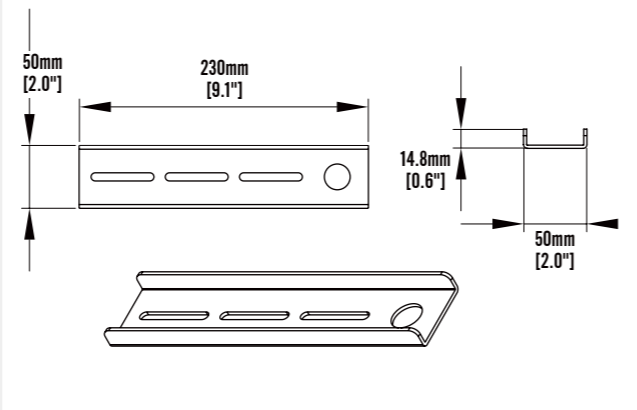

## FIXED CABINET TOP SUPPORT KIT

ITEM NO.:	LENGTH		HEIGHT		MATERIAL
	MM	INCH	MM	INCH	
AMK04	300/400/500	12/16/20	50/100/150/200/250	2/4/6/8/10	STEEL

APPLYING TO SUPPORT THE FIBER RACEWAY ON THE TOP OF CABINETS, STAND'S HEIGHT IS OPTIONAL.

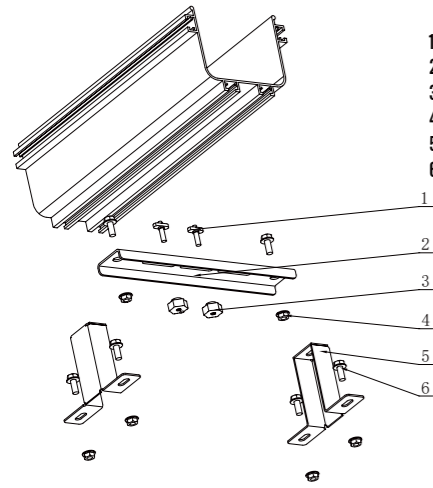

1. AF35 T-SHAPE SCREW X2
2. SUPPORT BAR X1
3. AF33 PLASTIC TWIST NUT X2
4. T006 M8 FLANGE NUT X6
5. T007 T TYPE CABINET TOP STAND X2
6. T008 M8 FLANGE BOLT X6

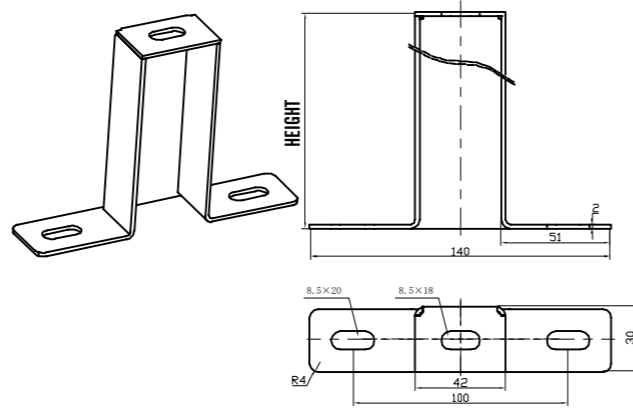

## TRAPEZE SUPPORT KIT

ITEM NO.:	LENGTH		WIDTH		MATERIAL
	MM	INCH	MM	INCH	
AMK06	300/400/500	12/16/20	50	2	STEEL

APPLYING TO SUPPORT THE FIBER RACEWAY FROM THE CEILING.

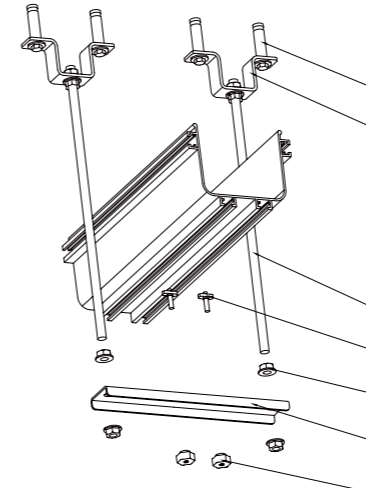

1. T010 M8 EXPANSION BOLT X4
2. T011 C CEILING BRACKET X2
3. T012 THREADED ROD X2
4. AF35 T-SHAPE SCREW X2
5. T013 FLANGE NUT X8
6. SUPPORT BAR X1
7. AF33 PLASTIC TWIST NUT X2

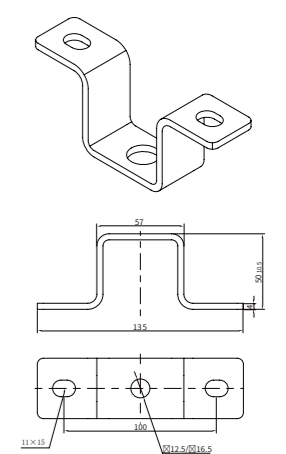
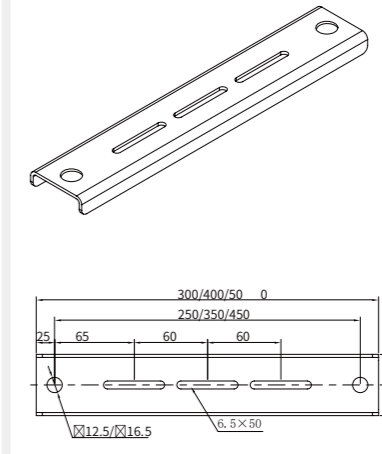

## ADJUSTABLE CABINET TOP SUPPORT KIT

ITEM NO.:	LENGTH		HEIGHT		MATERIAL
	MM	INCH	MM	INCH	
AMK05	230/350	9/14	200	8	STEEL

APPLYING TO SUPPORT THE FIBER RACEWAY ON THE TOP OF THE CABINET, STAND'S HEIGHT IS ADJUSTABLE FROM 50MM TO 200MM.

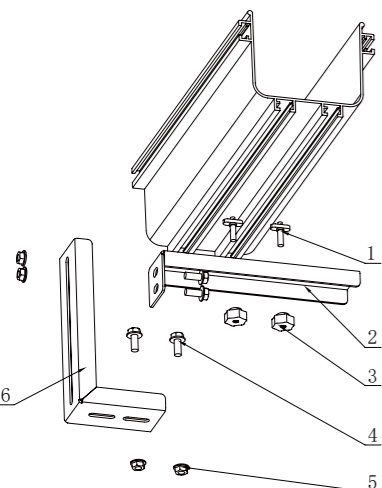

1. AF35 T-SHAPE SCREW X2
2. AM04 SUPPORT BAR X1
3. AF33 PLASTIC TWIST NUT X2
4. T008 M8 FLANGE BOLT X4
5. T006 M8 FLANGE NUT X4
6. T009 ADJUSTABLE CABINET TOP STAND X1

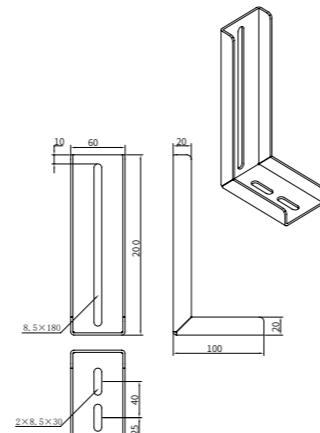
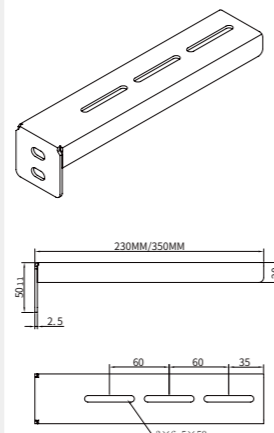

## LADDER RACK SUPPORT KIT

ITEM NO.:	LENGTH		WIDTH		MATERIAL
	MM	INCH	MM	INCH	
AMK07	230/350	9/14	50	2	STEEL

APPLYING TO SUPPORT THE FIBER RACEWAY ALONG SIDE THE FLAT STEEL LADDER RACK, FLEXIBLE AND STURDY.

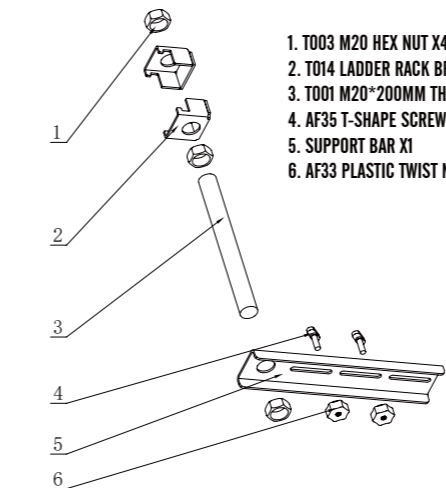

1. T003 M20 HEX NUT X4
2. T014 LADDER RACK BRACKET X2
3. T001 M20\*200MM THREADED ROD X2
4. AF35 T-SHAPE SCREW X2
5. SUPPORT BAR X1
6. AF33 PLASTIC TWIST NUT X2

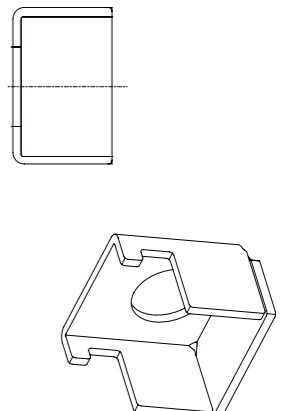
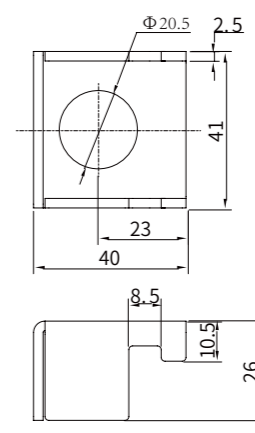

## TOP OF RACK/CABINET SUPPORT

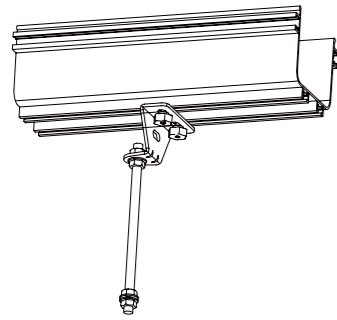

ITEM NO.:	LENGTH		HEIGHT		MATERIAL
	MM	INCH	MM	INCH	
AMK08	110	4	58	2	STEEL

APPLYING TO SUPPORT THE FIBER RACEWAY AT THE TOP OF RACK/CABINET OR OTHER OBJECTS, FLEXIBLE, SIMPLE AND STURDY.

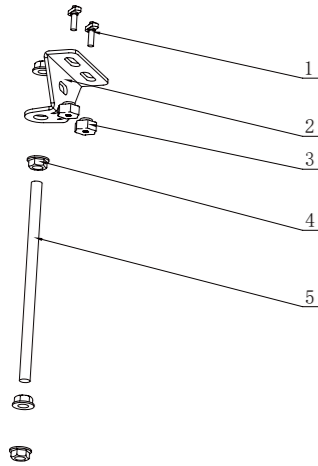

1. AF35 T-SHAPE SCREW X2
2. T015 Z TYPE CENTER SUPPORT BRACKET X1
3. AF33 PLASTIC TWIST NUT X2
4. T013 FLANGE NUT X4
5. T012 THREADED ROD X1

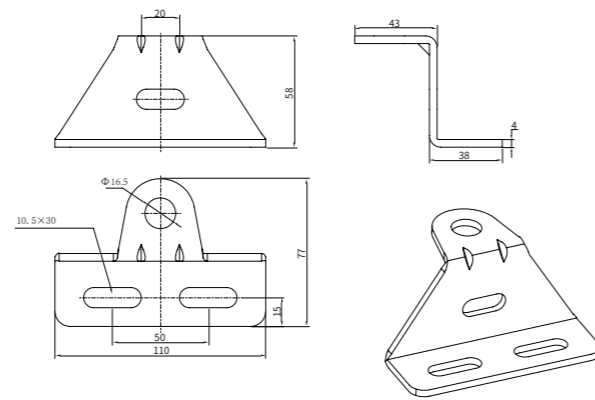

## UNISTRUT SUPPORT

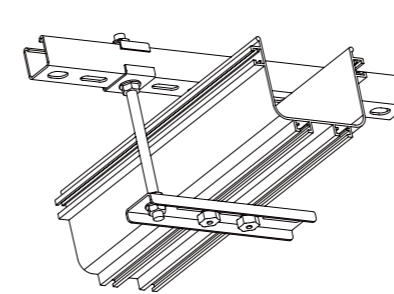

ITEM NO.:	LENGTH		HEIGHT		MATERIAL
	MM	INCH	MM	INCH	
AMK10	230/350	9/14	50	2	STEEL

APPLYING TO SUPPORT THE FIBER RACEWAY FROM C CHANNEL BAR, SIMPLY DESIGNED AND EASY FOR AMOUNTING.

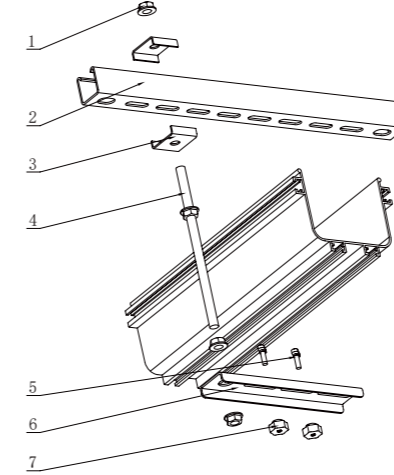

1. T006 FLANGE NUT X4
2. C CHANNEL BAR X1
3. T018 C CHANNEL HOLD DOWN CLIP X2
4. T012 THREADED ROD X1
5. AF35 T-SHAPE SCREW X2
6. SUPPORT BAR X1
7. AF33 PLASTIC TWIST NUT X2

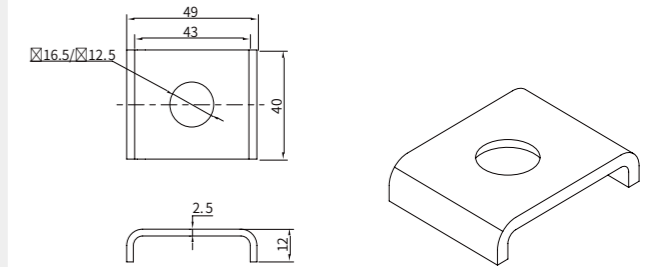

## UNISTRUT SUPPORT

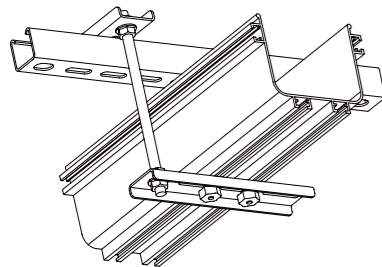

ITEM NO.:	LENGTH		HEIGHT		MATERIAL
	MM	INCH	MM	INCH	
AMK09	230/350	9/14	50	2	STEEL

APPLYING TO SUPPORT THE FIBER RACEWAY FROM C CHANNEL BAR

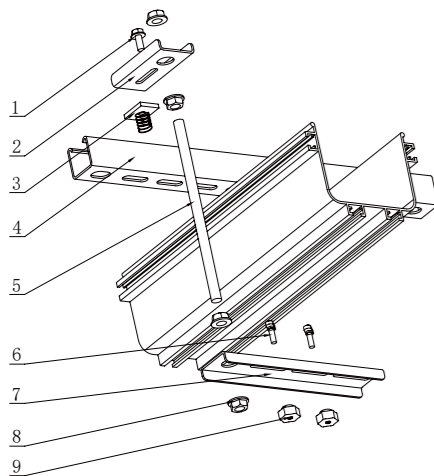

1. T008 M8 FLANGE BOLT X1
2. T017 C CHANNEL HOLD DOWN CLIP X1
3. T016 SPRING NUT X1
4. C CHANNEL BAR X1
5. T012 THREADED ROD X1
6. AF35 T-SHAPE SCREW X2
7. SUPPORT BAR X1
8. T006 FLANGE NUT X4
9. AF33 PLASTIC TWIST NUT X2

