

REVISIONS			
REV.	DESCRIPTION	DATE	APPROVED
A	FULL RELEASE	2023/11/20	CT

NOTES:

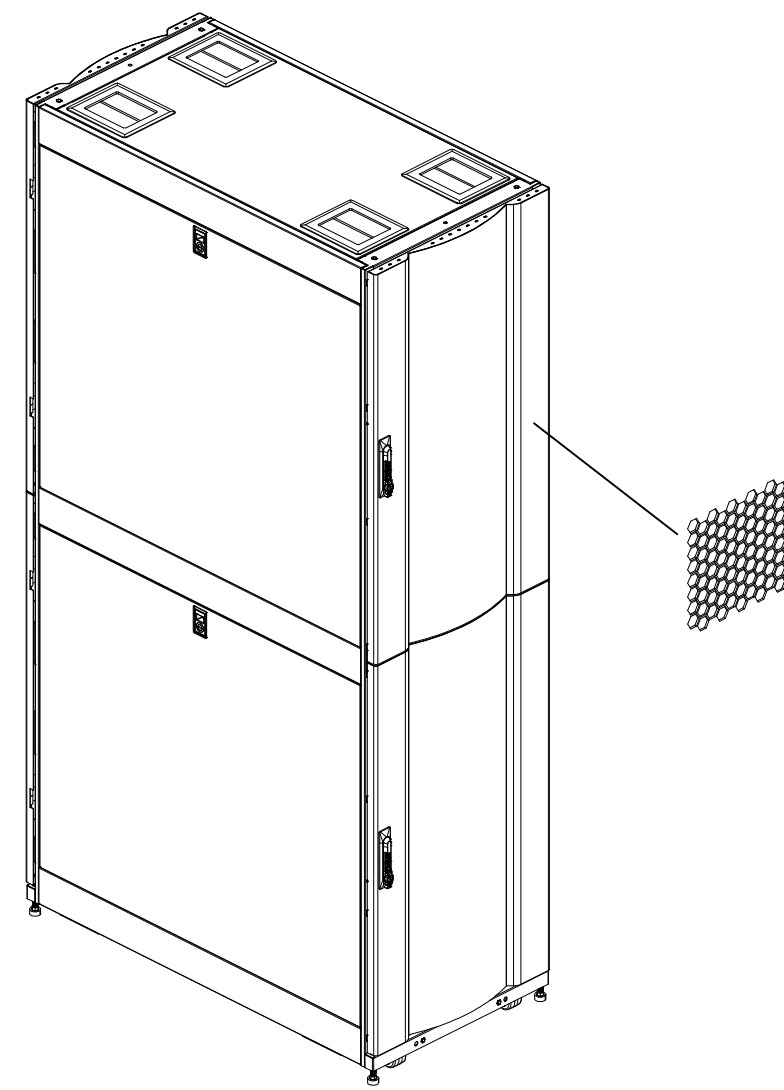

FRONT VIEW

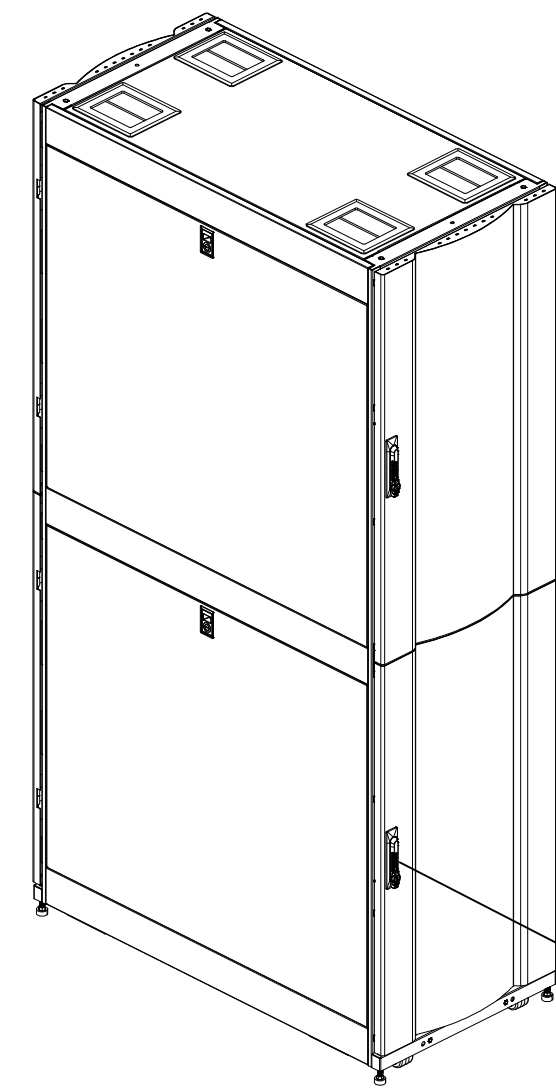

REAR VIEW

COMBINATION LOCK*4
PN:INV-DRLOCK-MA01

PROPRIETARY AND CONFIDENTIAL THIS DRAWING AND ITS SPECIFICATIONS ARE THE PROPERTY OF INOVA AND SHALL NOT BE COPIED, REPRODUCED, OR USED IN WHOLE OR IN PART, AS THE BASIS FOR THE MANUFACTURE OR SALE OF ITEMS WITHOUT THE WRITTEN PERMISSION FROM INOVA. THIS DRAWING IS BASED UPON THE LATEST AVAILABLE INFORMATION AND IS SUBJECT TO CHANGE WITHOUT NOTICE.	UNLESS OTHERWISE SPECIFIED $X = \pm 1$ $X.X = \pm 0.5$ $X.XX = \pm 0.30$ $X.XXX = \pm 0.130$ ANGULAR $X = 1^\circ$ $.X = 0.5^\circ$ $.XX = 0.25^\circ$		DESCRIPTION: INVOA 2 BAY CABINET, 600X1200X48U, SPLIT MOUNTING RAIL, UPPER 23U USABLE, LOWER 23U USABLE. FRONT AND REAR SINGLE MESH CURVE HALF DOOR. BLACK COLOR.	DRAWING NO: INV01-2C-61248		REV NO: A
	UNITS: mm [in]			MATERIAL: SEE INDIVIDUAL FINISH: SEE INDIVIDUAL	DEBURR AND BREAK SHARP EDGES/CONTOURS AT 0.2mm MAX	CLASS: N/A
			DRAWN BY: AMY ZHU 2023/11/20 APP. BY: SAM DING 2023/11/20		COMMENTS:	

E
D
C
B
A

E
D
C
B
A

8 7 6 5 4 3 2 1

8 7 6 5 4 3 2 1

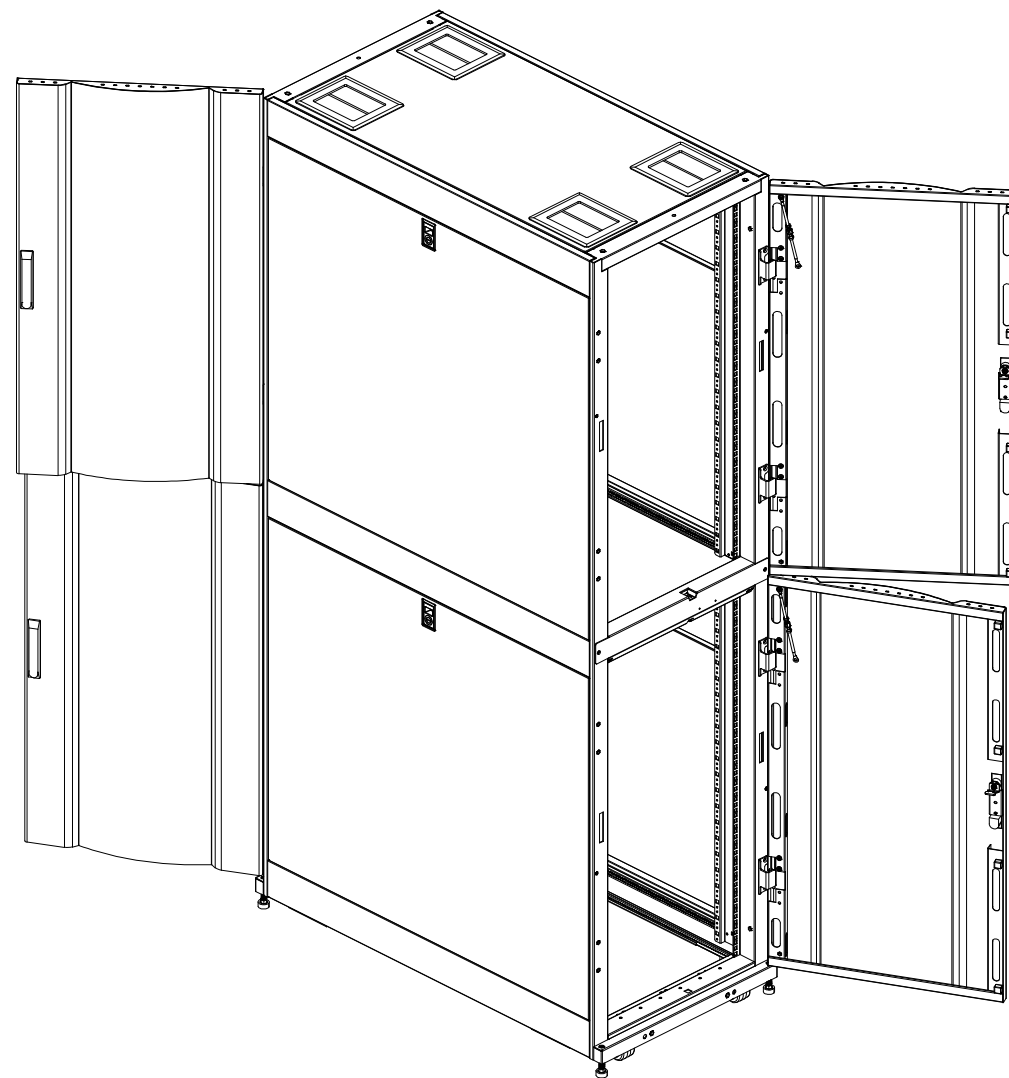

FRONT VIEW
(OPEN DOORS)

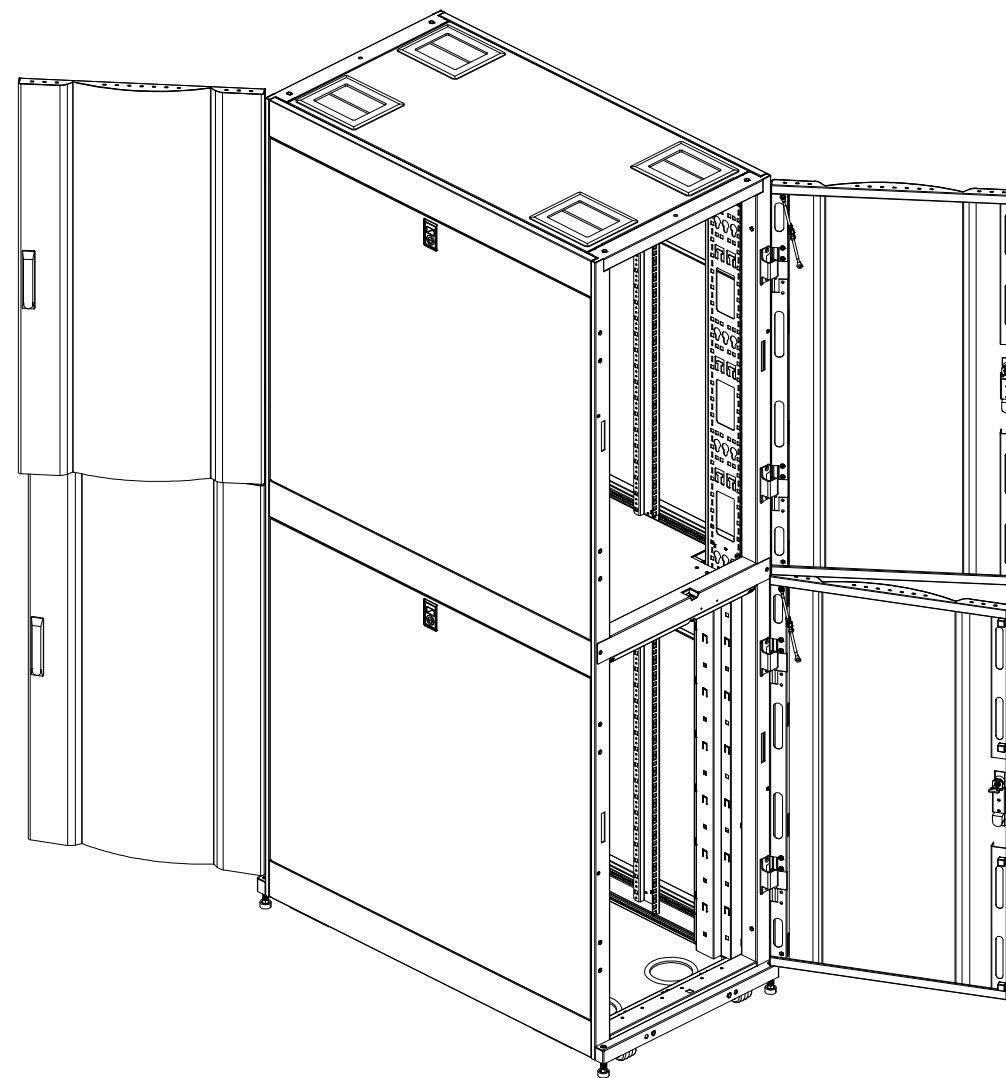

REAR VIEW
(OPEN DOORS)

NOTES:

PROPRIETARY AND CONFIDENTIAL
THIS DRAWING AND ITS SPECIFICATIONS ARE THE PROPERTY OF INOVA AND SHALL NOT BE COPIED, REPRODUCED, OR USED IN WHOLE OR IN PART, AS THE BASIS FOR THE MANUFACTURE OR SALE OF ITEMS WITHOUT THE WRITTEN PERMISSION FROM INOVA. THIS DRAWING IS BASED UPON THE LATEST AVAILABLE INFORMATION AND IS SUBJECT TO CHANGE WITHOUT NOTICE.

UNLESS OTHERWISE SPECIFIED

X = ± 1
X.X = ± 0.5
X.XX = ± 0.30
X.XXX = ± 0.130
ANGULAR
X = 1°
.X = 0.5°
.XX = 0.25°

UNITS: mm [in]



INTERPRET TO ASME Y14.100

DESCRIPTION:
INOVA 2 BAY CABINET,
600X1200X48U, SPLIT MOUNTING RAIL,
UPPER 23U USABLE, LOWER 23U USABLE.
FRONT AND REAR SINGLE MESH CURVE
HALF DOOR. BLACK COLOR.

MATERIAL: SEE INDIVIDUAL
FINISH: SEE INDIVIDUAL

DEBURR AND BREAK SHARP
EDGES/CONTOURS AT 0.2mm MAX

DRAWING NO:
INV01-2C-61248

NAME	DATE	COMMENTS:
DRAWN BY: AMY ZHU	2023/11/20	
APP. BY: SAM DING	2023/11/20	

SCALE: N/A WEIGHT:

REV NO:
A
SIZE:
B

SHEET: 2 OF 4

NOTES:

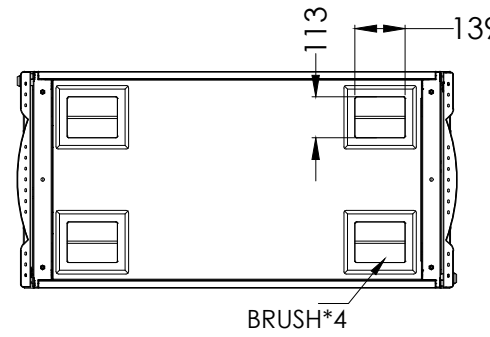
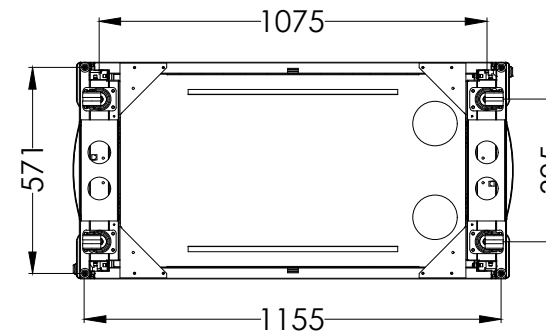
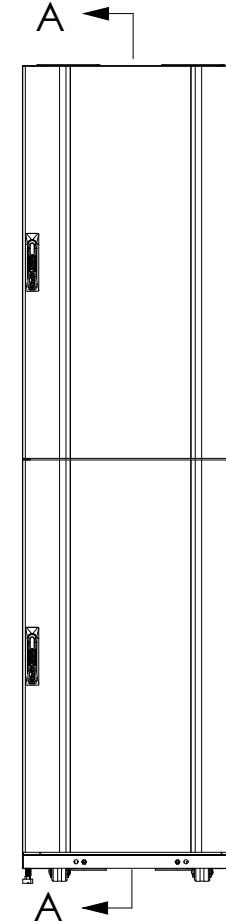
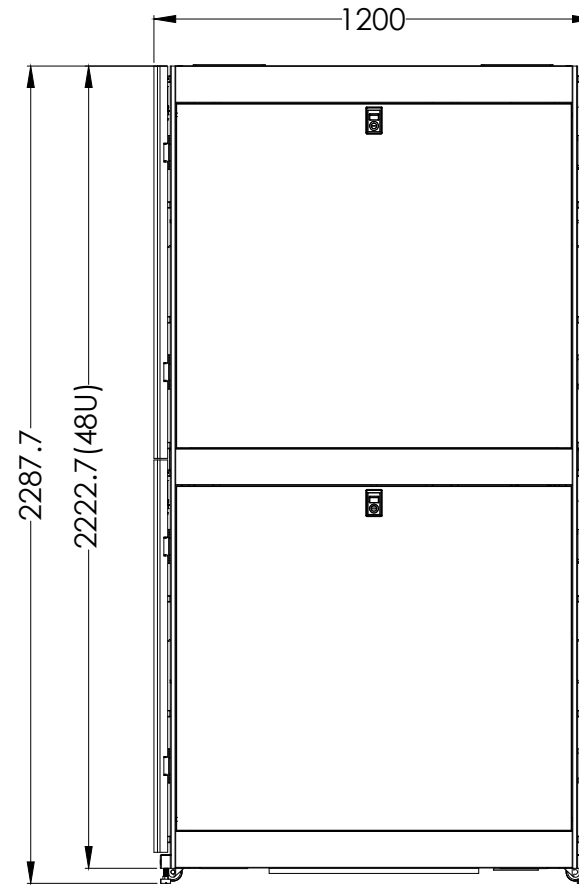
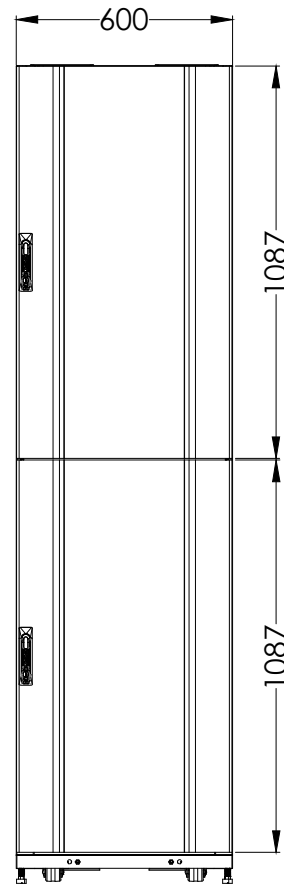
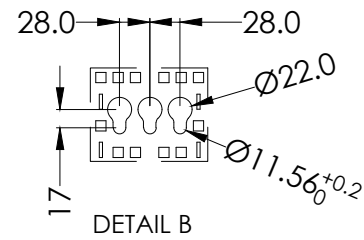
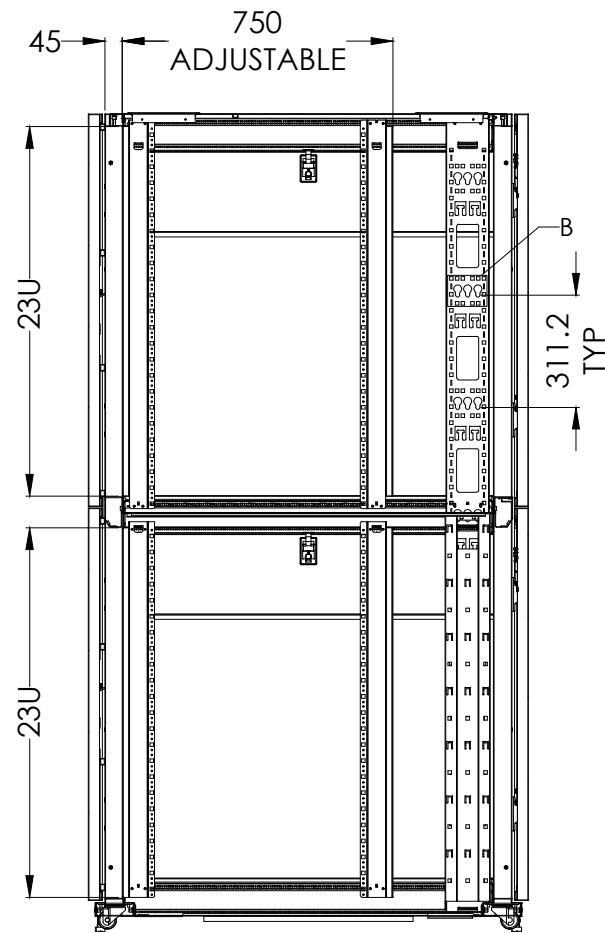

PROPRIETARY AND CONFIDENTIAL
THIS DRAWING AND ITS SPECIFICATIONS ARE THE PROPERTY OF INOVA AND SHALL NOT BE COPIED, REPRODUCED, OR USED IN WHOLE OR IN PART, AS THE BASIS FOR THE MANUFACTURE OR SALE OF ITEMS WITHOUT THE WRITTEN PERMISSION FROM INOVA. THIS DRAWING IS BASED UPON THE LATEST AVAILABLE INFORMATION AND IS SUBJECT TO CHANGE WITHOUT NOTICE.

UNLESS OTHERWISE SPECIFIED

X = ± 1
X.X = ± 0.5
X.XX = ± 0.30
X.XXX = ± 0.130
ANGULAR
X = 1°
.X = 0.5°
.XX = 0.25°

UNITS: mm [in]



INTERPRET TO ASME Y14.100

DESCRIPTION:
INVOA 2 BAY CABINET,
600X1200X48U, SPLIT MOUNTING RAIL,
UPPER 23U USABLE, LOWER 23U USABLE.
FRONT AND REAR SINGLE MESH CURVE
HALF DOOR. BLACK COLOR.

MATERIAL: SEE INDIVIDUAL
FINISH: SEE INDIVIDUAL

DEBURR AND BREAK SHARP
EDGES/CONTOURS AT 0.2mm MAX

DRAWING NO:
INV01-2C-61248

REV NO:
A
SIZE:
B

NAME	DATE	COMMENTS:
DRAWN BY: AMY ZHU	2023/11/20	
APP. BY: SAM DING	2023/11/20	

CLASS: N/A
SCALE: N/A
WEIGHT:
SHEET: 3 OF 4

NOTES:

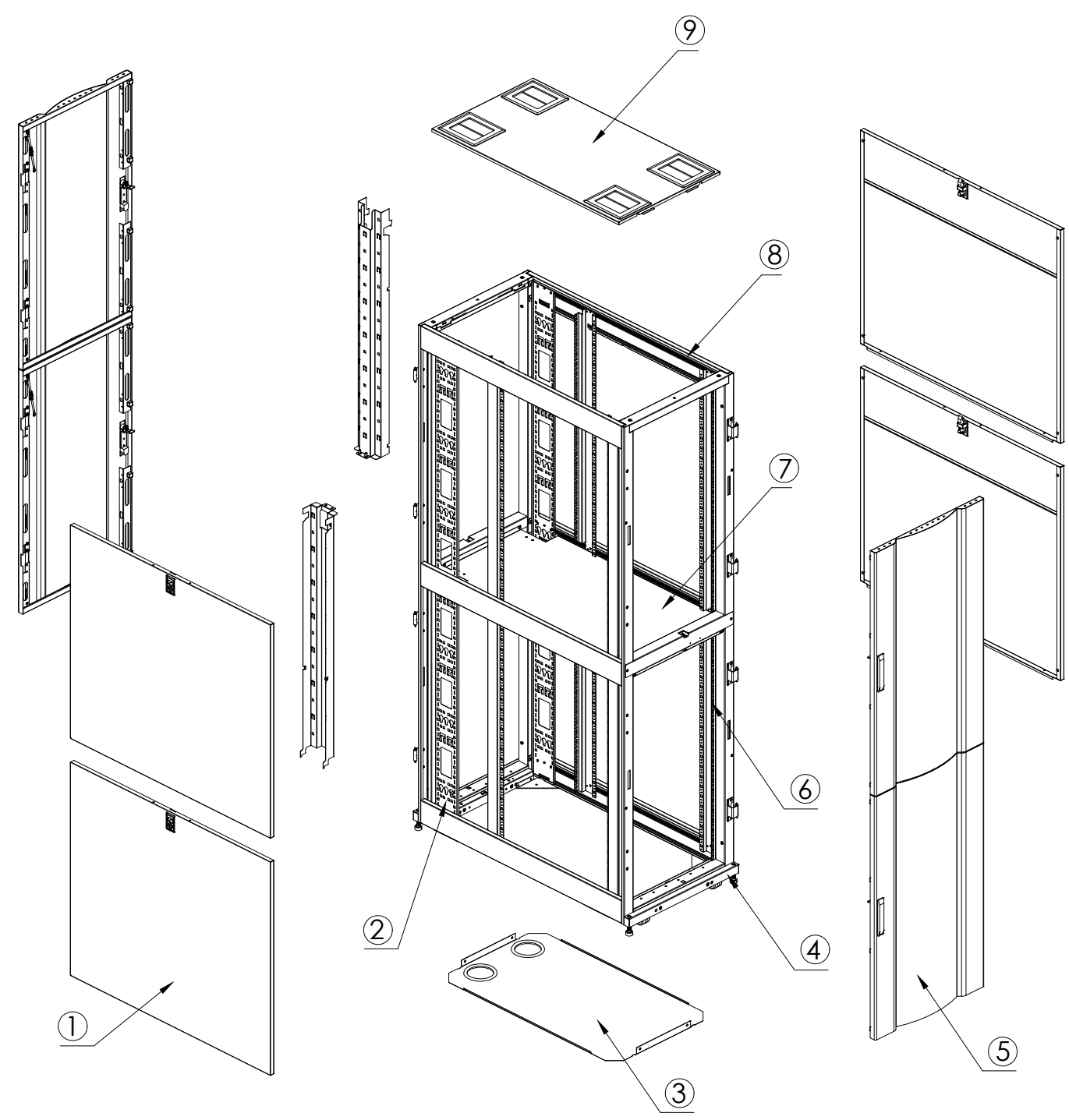

NO.	PN	DES.	QTY.
1	INV-4812-PANKIT	Inova 48u x 1200mm Side Panel Kit, Black	1
2	INV-648-VBCKIT	2 Bay cabinet, 48U, 600mm, vertical bar 2pcs, upper vertical bar cover 1pcs, lower vertical bar cover 1 pcs. Black	1
3	INV-BTM-612-02	Solid Bottom w/ 2 holes, 600mm wide, 1200mm deep, Black	1
4	INV-648-FMKIT-2BAYTS	2 Bay cabinet, 48U, 600mm, frame kit, including 2 frames, 4 castor, 4 leveling feet, 2 L bracket, 4 triangle stiffener, 4 baying kit, assemble hardware, customer hardware. Black.	1
5	INV-648-DRKIT-2BAYTS	2 Bay cabinet, 48U, 600mm, door kit, half height single mesh front, and rear door, with hinge, 3 digits combination lock, grounding wires. 4 pcs/set. Black	1
6	INV-648-2BAY-MRKIT	2 Bay cabinet, 48U, 600mm, mounting rail, upper 4 pcs, lower 4 pcs. Black	1
7	INV-648-TRAY-2BAYTS	2 Bay cabinet, 48U, 600mm, compartment tray. w/ mounting screws. Black	1
8	INV-BEAM-1200MM-2BTS	Inova horizontal beam for 1200mm cabinet, set of 6, for 2 bay cabinet. Black	1
9	INV-ROOF-612-02	Solid Roof w/ 4 holes & Brush, 600mm wide, 1200mm deep, Black	1

PROPRIETARY AND CONFIDENTIAL
 THIS DRAWING AND ITS SPECIFICATIONS ARE THE PROPERTY OF INOVA AND SHALL NOT BE COPIED, REPRODUCED, OR USED IN WHOLE OR IN PART, AS THE BASIS FOR THE MANUFACTURE OR SALE OF ITEMS WITHOUT THE WRITTEN PERMISSION FROM INOVA. THIS DRAWING IS BASED UPON THE LATEST AVAILABLE INFORMATION AND IS SUBJECT TO CHANGE WITHOUT NOTICE.

UNLESS OTHERWISE SPECIFIED
 X = ± 1
 X.X = ± 0.5
 X.XX = ± 0.30
 X.XXX = ± 0.130
 ANGULAR
 X = 1°
 .X = 0.5°
 .XX = 0.25°

UNITS: mm [in]



DESCRIPTION:
 INVOA 2 BAY CABINET, 600X1200X48U, SPLIT MOUNTING RAIL, UPPER 23U USABLE, LOWER 23U USABLE. FRONT AND REAR SINGLE MESH CURVE HALF DOOR. BLACK COLOR.

MATERIAL: SEE INDIVIDUAL
 FINISH: SEE INDIVIDUAL

DEBURR AND BREAK SHARP EDGES/CONTOURS AT 0.2mm MAX

DRAWING NO: INV01-2C-61248		REV NO: A
NAME		DATE
DRAWN BY AMY ZHU		2023/11/20
APP. BY SAM DING		2023/11/20
SCALE: N/A	WEIGHT:	SHEET: 4 OF 4