

NOTES:

REVISIONS			
REV.	DESCRIPTION	DATE	APPROVED
A	FULL RELEASED	2023/11/9	CT

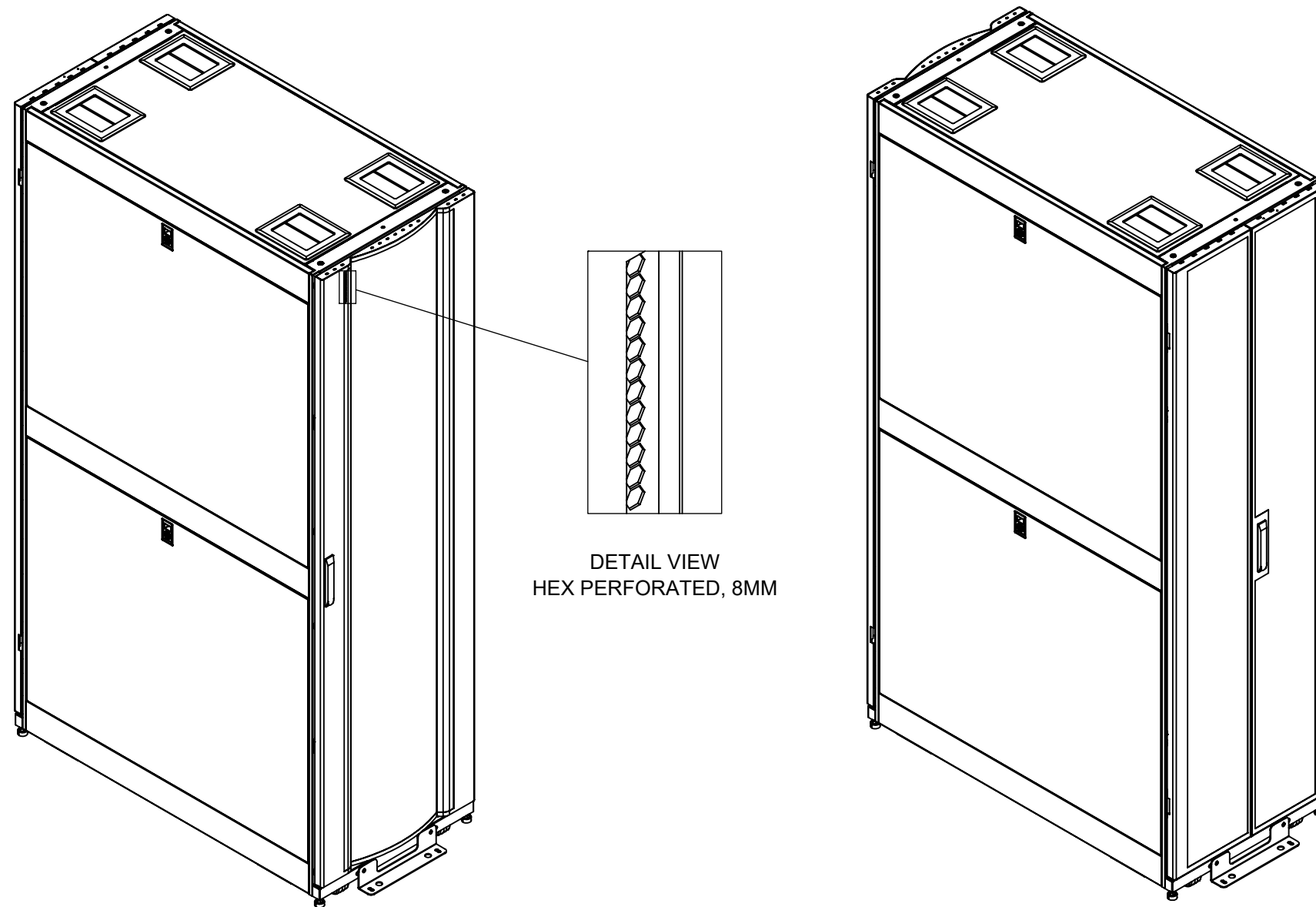

DETAIL VIEW
HEX PERFORATED, 8MM

PROPRIETARY AND CONFIDENTIAL

THIS DRAWING AND ITS SPECIFICATIONS ARE THE PROPERTY OF INOVA AND SHALL NOT BE COPIED, REPRODUCED, OR USED IN WHOLE OR IN PART, AS THE BASIS FOR THE MANUFACTURE OR SALE OF ITEMS WITHOUT THE WRITTEN PERMISSION FROM INOVA. THIS DRAWING IS BASED UPON THE LATEST AVAILABLE INFORMATION AND IS SUBJECT TO CHANGE WITHOUT NOTICE.

UNLESS OTHERWISE SPECIFIED

X = ± 1
 X.X = ± 0.5
 X.XX = ± 0.30
 X.XXX = ± 0.130
 ANGULAR
 X = 1°
 .X = 0.5°
 .XX = 0.25°



INTERPRET TO ASME Y14.100

DESCRIPTION:
 INOVA, DATA CENTER CABINET,
 600MM (23.6") WIDTH

MATERIAL:
 SEE INDIVIDUAL

FINISH:
 C=W WHITE RAL 9003 TEXTURE
 C=B BLACK RAL 9005 TEXTURE

DEBURR AND BREAK SHARP
 EDGES/CONTOURS AT 0.2mm MAX

CLASS:

DRAWING NO:
 INV01-6DDHH-
 XXXXXX

REV NO:
 A
 SIZE:
 B

NAME	DATE	COMMENTS:
DRAWN BY: AMY ZHU	2023/11/9	
APP. BY: SAM DING	2023/11/9	

SCALE: 1:16 WEIGHT: SHEET: 1 OF 3

NOTES:

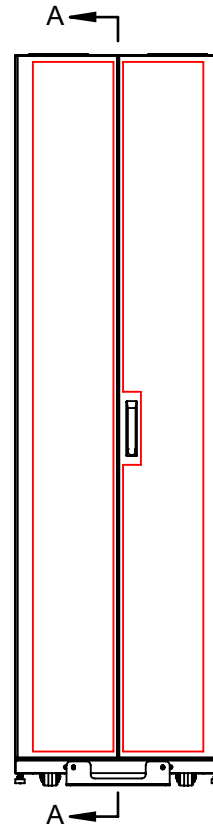
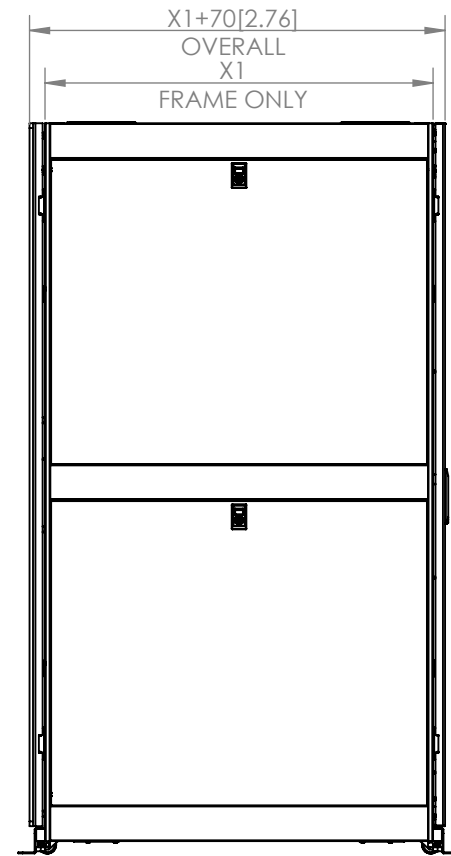
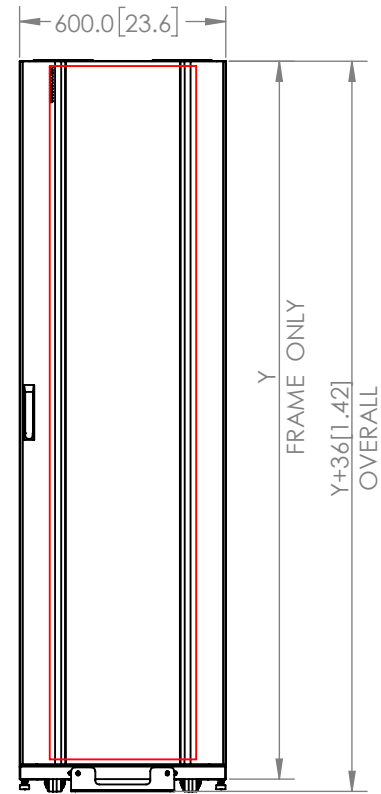
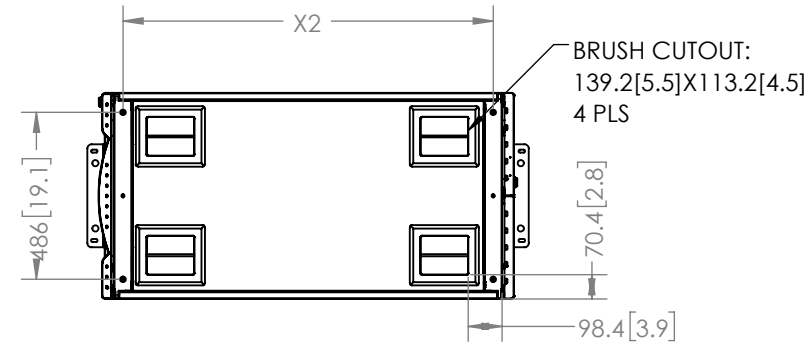

450 [17.7] $\pm \frac{+2}{-1}$
465 [18.3] ± 1.6

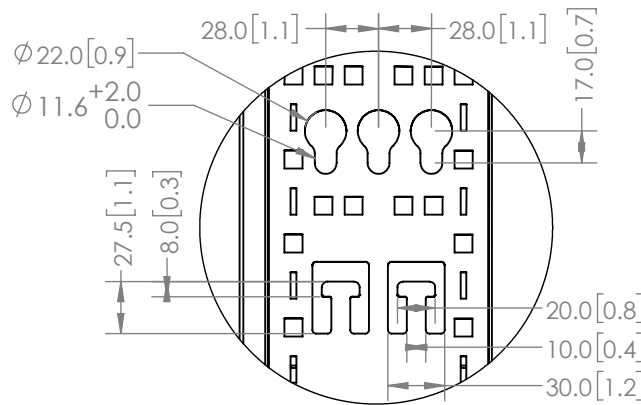
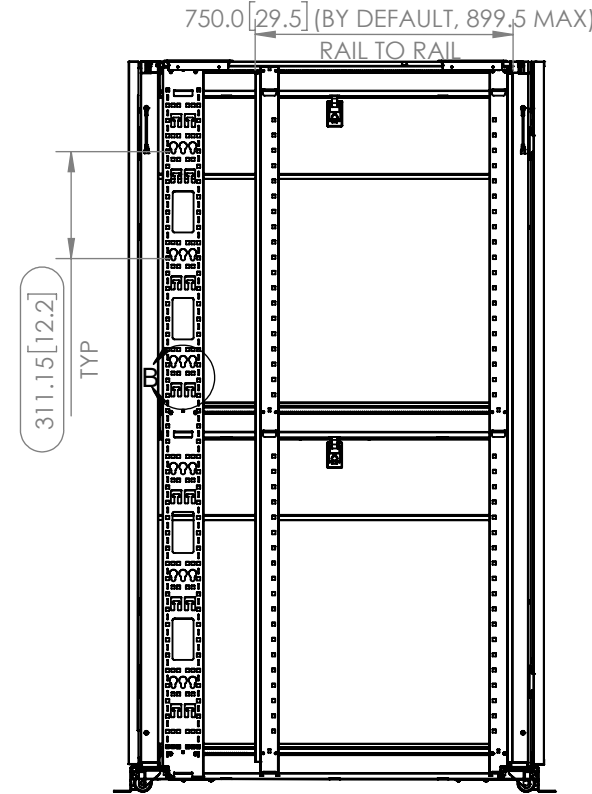

DETAIL B
SCALE 1 : 4

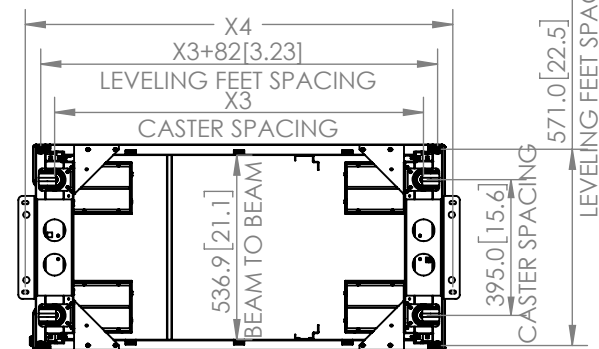

PROPRIETARY AND CONFIDENTIAL

THIS DRAWING AND ITS SPECIFICATIONS ARE THE PROPERTY OF INOVA AND SHALL NOT BE COPIED, REPRODUCED, OR USED IN WHOLE OR IN PART, AS THE BASIS FOR THE MANUFACTURE OR SALE OF ITEMS WITHOUT THE WRITTEN PERMISSION FROM INOVA. THIS DRAWING IS BASED UPON THE LATEST AVAILABLE INFORMATION AND IS SUBJECT TO CHANGE WITHOUT NOTICE.

UNLESS OTHERWISE SPECIFIED

X = ± 1
X.X = ± 0.5
X.XX = ± 0.30
X.XXX = ± 0.130
ANGULAR
X = 1°
.X = 0.5°
.XX = 0.25°



INTERPRET TO ASME Y14.100

DESCRIPTION:
INOVA, DATA CENTER CABINET,
600MM (23.6") WIDTH

MATERIAL:
SEE INDIVIDUAL

DEBURR AND BREAK SHARP
EDGES/CONTOURS AT 0.2mm MAX

FINISH:
C=W WHITE RAL 9003 TEXTURE
C=B BLACK RAL 9005 TEXTURE

CLASS: N/A

DRAWING NO:
INV01-6DDHH-
XXXXXX

NAME	DATE	COMMENTS:
DRAWN BY AMY ZHU	2023/11/9	
APP. BY SAM DING	2023/11/9	

SCALE: 1:22 WEIGHT:

REV NO:
A
SIZE:
B

SHEET: 2 OF 3

PN	X1	X2	X3	X4	Y
INV01-60842	730[28.7]	677[26.7]	673[26.5]	844[33.2]	1956[77.0]
INV01-60845	730[28.7]	677[26.7]	673[26.5]	844[33.2]	2089[82.2]
INV01-60848	730[28.7]	677[26.7]	673[26.5]	844[33.2]	2222[87.5]
INV01-60852	730[28.7]	677[26.7]	673[26.5]	844[33.2]	2400[94.5]
INV01-61042	930[36.6]	877[34.5]	873[34.4]	1044[41.1]	1956[77.0]
INV01-61045	930[36.6]	877[34.5]	873[34.4]	1044[41.1]	2089[82.2]
INV01-61048	930[36.6]	877[34.5]	873[34.4]	1044[41.1]	2222[87.5]
INV01-61052	930[36.6]	877[34.5]	873[34.4]	1044[41.1]	2400[94.5]
INV01-61142	1030[40.6]	977[38.5]	973[38.3]	1144[45.0]	1956[77.0]
INV01-61145	1030[40.6]	977[38.5]	973[38.3]	1144[45.0]	2089[82.2]
INV01-61148	1030[40.6]	977[38.5]	973[38.3]	1144[45.0]	2222[87.5]
INV01-61152	1030[40.6]	977[38.5]	973[38.3]	1144[45.0]	2400[94.5]
INV01-61242	1130[44.5]	1077[42.4]	1073[42.2]	1244[49.0]	1956[77.0]
INV01-61245	1130[44.5]	1077[42.4]	1073[42.2]	1244[49.0]	2089[82.2]
INV01-61248	1130[44.5]	1077[42.4]	1073[42.2]	1244[49.0]	2222[87.5]
INV01-61252	1130[44.5]	1077[42.4]	1073[42.2]	1244[49.0]	2400[94.5]

NOTES:

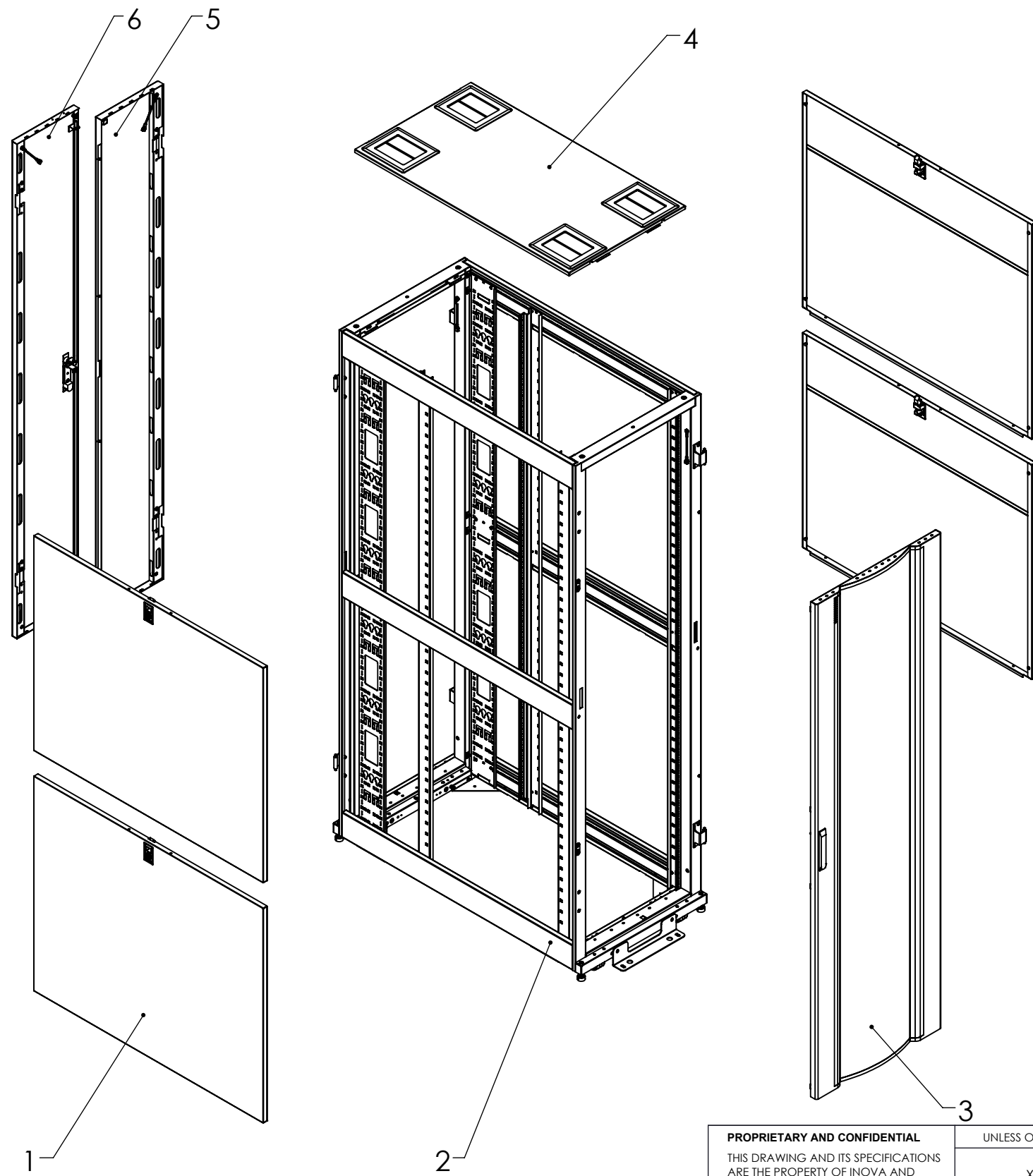

1. SIDE PANEL
2. FRAME WITH VERTICAL MOUNTING RAILS AND RCCS
3. FRONT DOOR
4. TOP PANEL
5. REAR LEFT DOOR
6. REAR RIGHT DOOR
7. ACCESSORY BAG (CAGE NUT KIT)

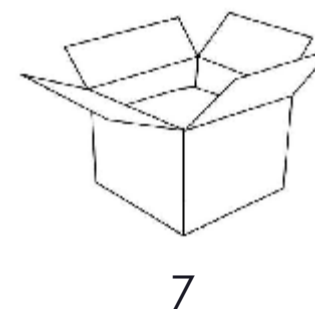

<p>PROPRIETARY AND CONFIDENTIAL</p> <p>THIS DRAWING AND ITS SPECIFICATIONS ARE THE PROPERTY OF INOVA AND SHALL NOT BE COPIED, REPRODUCED, OR USED IN WHOLE OR IN PART, AS THE BASIS FOR THE MANUFACTURE OR SALE OF ITEMS WITHOUT THE WRITTEN PERMISSION FROM INOVA. THIS DRAWING IS BASED UPON THE LATEST AVAILABLE INFORMATION AND IS SUBJECT TO CHANGE WITHOUT NOTICE.</p>	UNLESS OTHERWISE SPECIFIED			DESCRIPTION: INOVA, DATA CENTER CABINET, 600MM (23.6") WIDTH		DRAWING NO: INV01-6DDHH-XXXXXX		REV NO: A	
	<p>X = ± 1 X.X = ± 0.5 X.XX = ± 0.30 X.XXX = ± 0.130 ANGULAR X = 1° .X = 0.5° .XX = 0.25°</p>			MATERIAL: SEE INDIVIDUAL		FINISH: C=W WHITE RAL 9003 TEXTURE C=B BLACK RAL 9005 TEXTURE		NAME	DATE
	UNITS: mm [in]			DEBURR AND BREAK SHARP EDGES/CONTOURS AT 0.2mm MAX		CLASS: N/A	SCALE: 1:50	WEIGHT:	COMMENTS:
	INTERPRET TO ASME Y14.100								
						DRAWN BY: AMY ZHU 2023/11/9		SIZE: A	
						APP. BY: SAM DING 2023/11/9		SIZE: B	
						SHEET: 3 OF 3			