

8 7 6 5 4 3 2 1

NOTES:

REVISIONS			
REV.	DESCRIPTION	DATE	APPROVED
A	FULL RELEASED	2023/11/30	CT

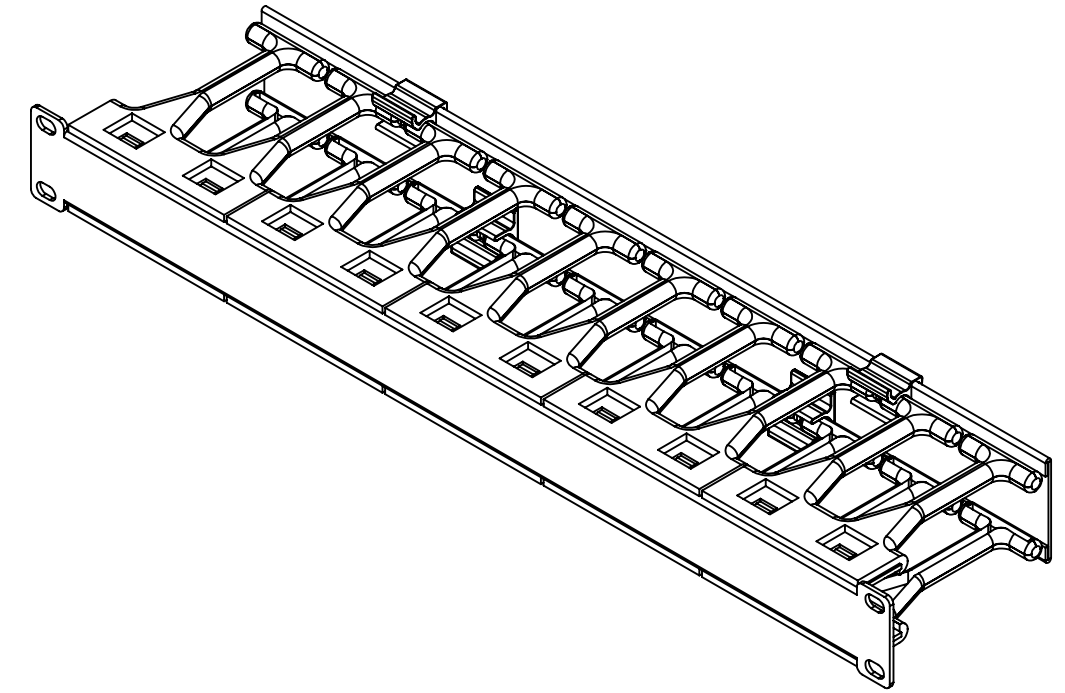

ACCESSORY BAG			
ITEM	PN.	DES.	QTY.
1	212-E600-00	NUT, INTEGRATED(SEMS),CAGE NUT, M6,BLACK ZINC PLATE	4
2	224-E600-00	WASHER, CUP WASHER, PLASTIC, BLACK, DIA X, THICKNESS X, HEIGHT X	4
3	201-E616-00	SCREW, ROUNDED HEAD, M6X16 PHILLIPS, BLACK ZINC, GRADE 8.8	4

PROPRIETARY AND CONFIDENTIAL

THIS DRAWING AND ITS SPECIFICATIONS ARE THE PROPERTY OF INOVA AND SHALL NOT BE COPIED, REPRODUCED, OR USED IN WHOLE OR IN PART, AS THE BASIS FOR THE MANUFACTURE OR SALE OF ITEMS WITHOUT THE WRITTEN PERMISSION FROM INOVA. THIS DRAWING IS BASED UPON THE LATEST AVAILABLE INFORMATION AND IS SUBJECT TO CHANGE WITHOUT NOTICE.

UNLESS OTHERWISE SPECIFIED

X = ± 1
 X.X = ± 0.5
 X.XX = ± 0.30
 X.XXX = ± 0.130
 ANGULAR
 X = 1°
 .X = 0.5°
 .XX = 0.25°



INTERPRET TO ASME Y14.100

DESCRIPTION:
CABINET ACCESSORY, 1U FINGER CABLE MANAGER WITH COVER, WHITE

MATERIAL: 2MM CRS, 1.5MM OR 3mm ALUMINUM AND PLASTIC FINISH: RAL9003 TEXTURE

DEBURR AND BREAK SHARP EDGES/CONTOURS AT 0.2mm MAX

CLASS:

DRAWING NO:
INV08-00009W

REV NO:
A
 SIZE:
B

NAME	DATE	COMMENTS:
DRAWN BY: AMY ZHU	2023/11/30	
APP. BY: SAM DING	2023/11/30	

SCALE: 1:3 WEIGHT: SHEET: 1 OF 2

8 7 6 5 4 3 2 1

NOTES:

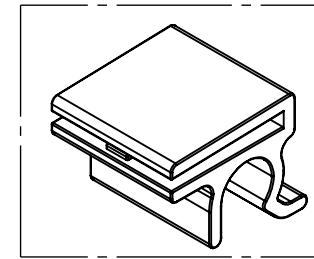
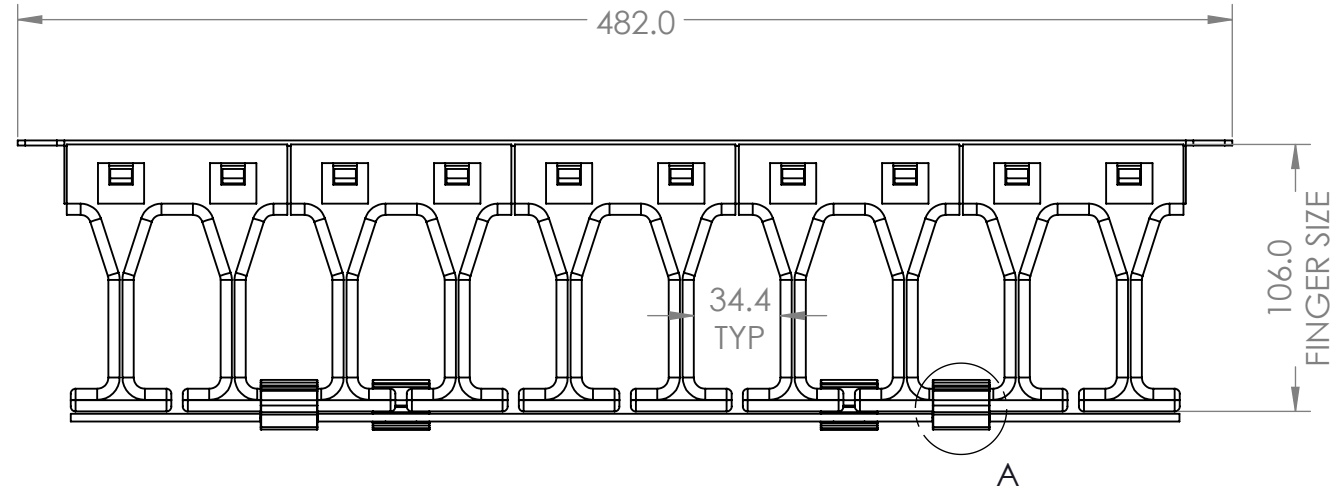

DETAIL A

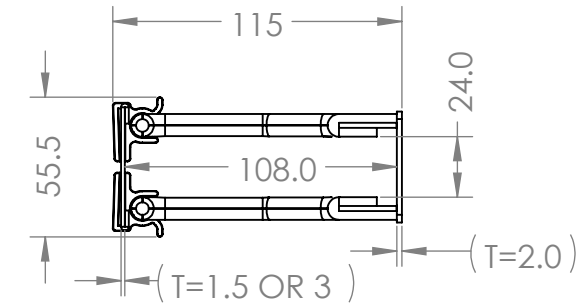
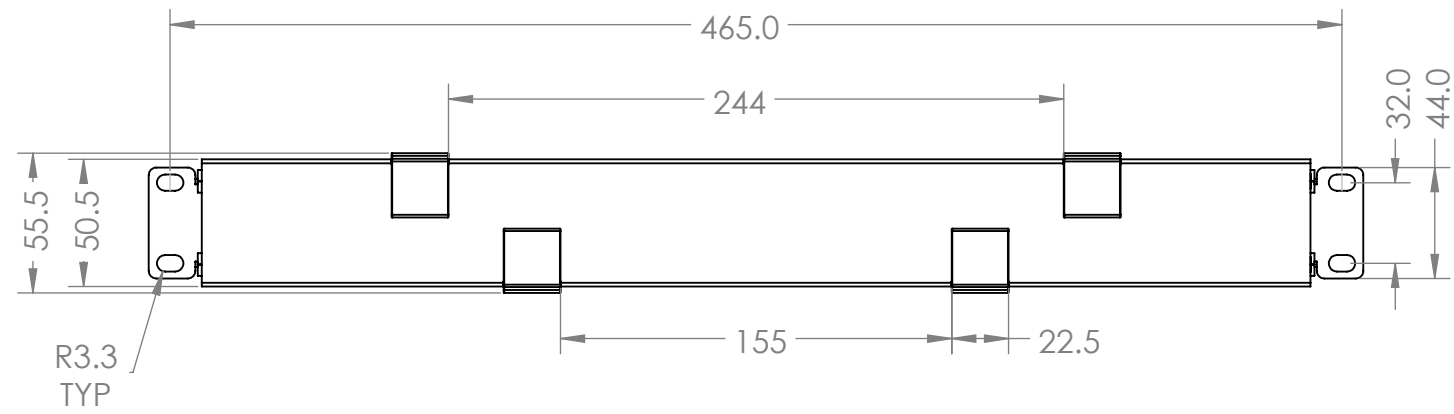

<p>PROPRIETARY AND CONFIDENTIAL</p> <p>THIS DRAWING AND ITS SPECIFICATIONS ARE THE PROPERTY OF INOVA AND SHALL NOT BE COPIED, REPRODUCED, OR USED IN WHOLE OR IN PART, AS THE BASIS FOR THE MANUFACTURE OR SALE OF ITEMS WITHOUT THE WRITTEN PERMISSION FROM INOVA. THIS DRAWING IS BASED UPON THE LATEST AVAILABLE INFORMATION AND IS SUBJECT TO CHANGE WITHOUT NOTICE.</p>	<p>UNLESS OTHERWISE SPECIFIED</p> <p>X = ± 1 X.X = ± 0.5 X.XX = ± 0.30 X.XXX = ± 0.130 ANGULAR X = 1° .X = 0.5° .XX = 0.25°</p>			<p>DESCRIPTION: CABINET ACCESSORY, 1U FINGER CABLE MANAGER WITH COVER, WHITE</p>		<p>DRAWING NO: INV08-00009W</p>		<p>REV NO: A</p>	
	<p>INTERPRET TO ASME Y14.100</p>			<p>MATERIAL: 2MM CRS, 1.5MM OR 3mm ALUMINUM AND PLASTIC</p>	<p>FINISH: RAL9003 TEXTURE</p>	<p>CLASS: N/A</p>	<p>SCALE: 1:3</p>	<p>WEIGHT:</p>	<p>COMMENTS:</p>
	<p>DEBURR AND BREAK SHARP EDGES/CONTOURS AT 0.2mm MAX</p>			<p>CLASS: N/A</p>	<p>SCALE: 1:3</p>	<p>WEIGHT:</p>	<p>SHEET: 2 OF 2</p>	<p>DRAWN BY: AMY ZHU 2023/11/30</p>	<p>APP. BY: SAM DING 2023/11/30</p>
	<p>UNITS: mm [in]</p>			<p>CLASS: N/A</p>	<p>SCALE: 1:3</p>	<p>WEIGHT:</p>	<p>SHEET: 2 OF 2</p>	<p>DRAWN BY: AMY ZHU 2023/11/30</p>	<p>APP. BY: SAM DING 2023/11/30</p>