

NOTES:

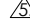

1. INSTALLATION SHALL COMPLY WITH ALL APPLICABLE NATIONAL, STATE AND LOCAL ELECTRICAL CODES.
  2. REFER TO PRODUCT DOCUMENTATION FOR ADDITIONAL DETAILS PRIOR TO INSTALLATION AND PREPARATION WORK.
  3. UNLESS OTHERWISE SPECIFIED, ALL DIMENSIONS ARE IN MILLIMETERS [INCHES].
  4. NET WEIGHT OF UNIT IS 29 kg [ 63.93 lb]
-  BRACKET IS PROVIDED WITH THE UNIT.

REVISIONS			
REV.	DESCRIPTION	DATE	APPROVED
A	FULL RELEASED	2025.3.13	CT

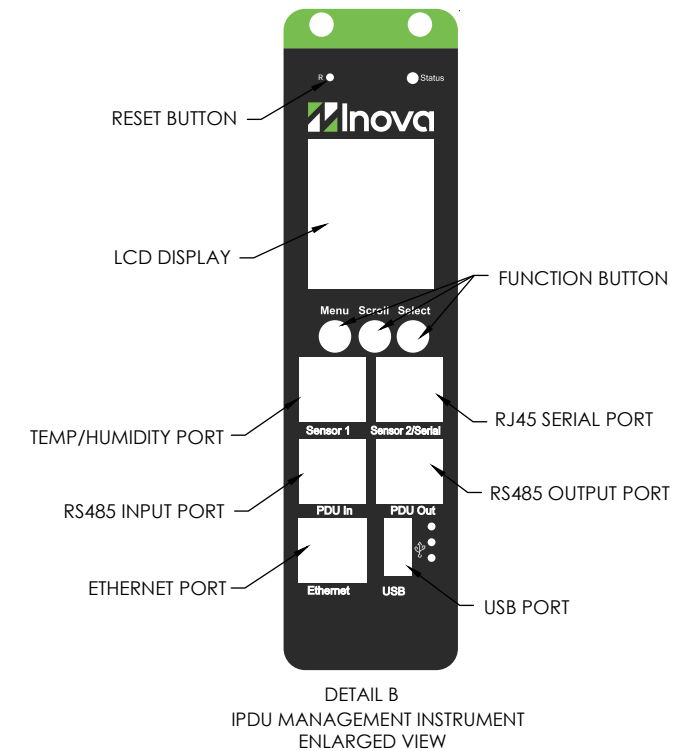
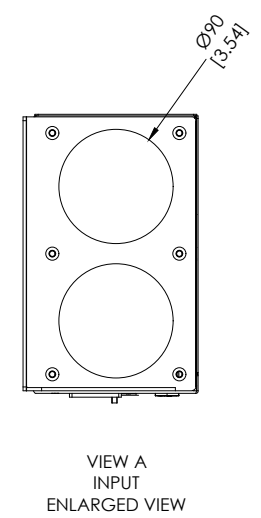
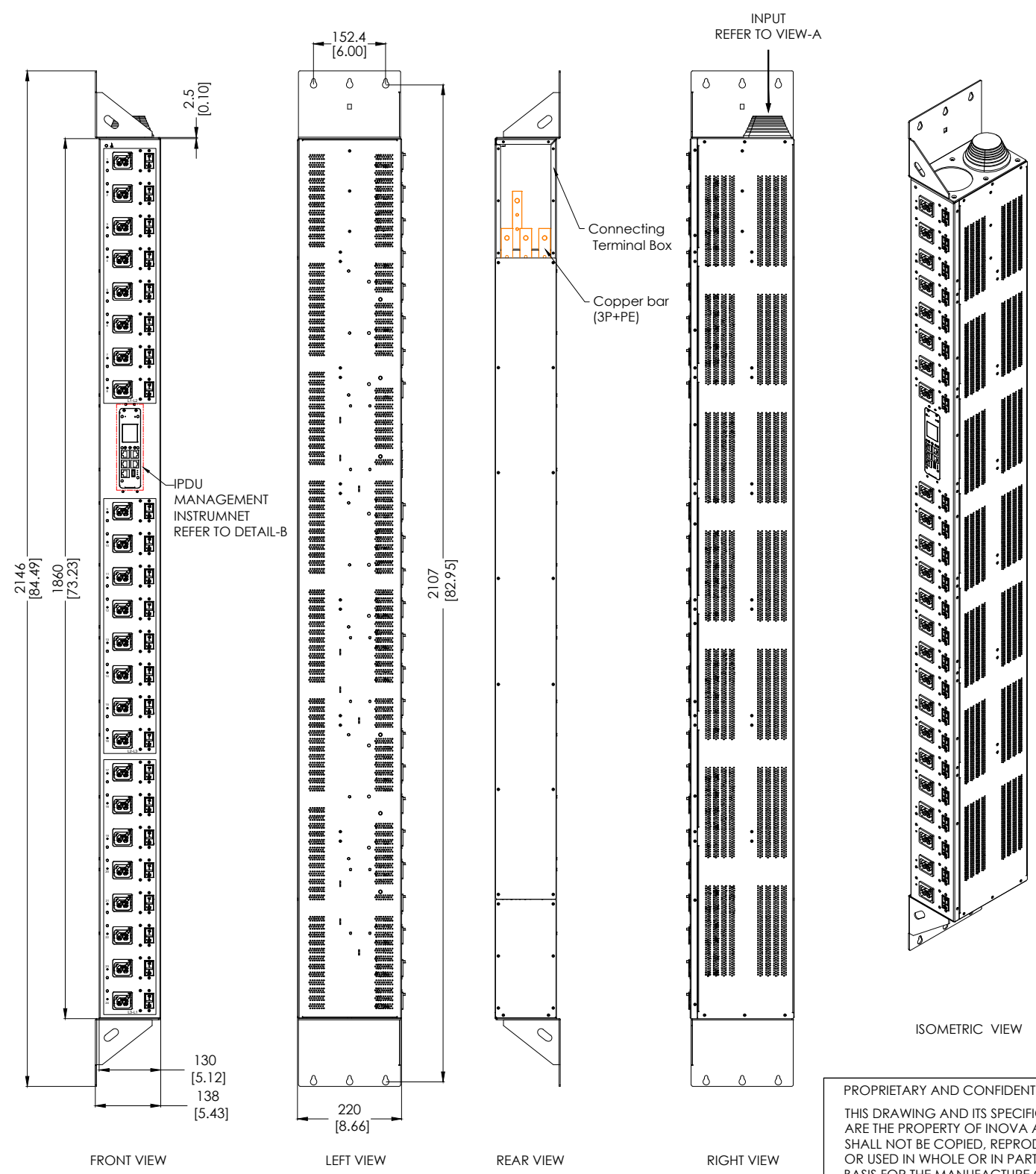

PROPRIETARY AND CONFIDENTIAL  
THIS DRAWING AND ITS SPECIFICATIONS ARE THE PROPERTY OF INOVA AND SHALL NOT BE COPIED, REPRODUCED, OR USED IN WHOLE OR IN PART, AS THE BASIS FOR THE MANUFACTURE OR SALE OF ITEMS WITHOUT THE WRITTEN PERMISSION FROM INOVA. THIS DRAWING IS BASED UPON THE LATEST AVAILABLE INFORMATION AND IS SUBJECT TO CHANGE WITHOUT NOTICE.

UNLESS OTHERWISE SPECIFIED  
X = ± 1  
X.X = ± 0.5  
X.XX = ± 0.30  
X.XXX = ± 0.130  
ANGULAR  
X = 1°  
.X = 0.5°  
.XX = 0.25°

  UNITS: mm [in]



DESCRIPTION:  
208V delta 3PH Hard Wire Input, 24pcs locking C39, 72 KW, Metered and Switch per Outlet, Black, Grey, White alternative outlets layout. Black Chassis.

MATERIAL: N/A FINISH: N/A

DEBURR AND BREAK SHARP EDGES/CONTOURS AT 0.2mm MAX

DRAWING NO: MSPO200A3PHC39X24		REV NO: A
NAME	DATE	COMMENTS:
DRAWN BY AMY ZHU	2025/3/13	
APP. BY JOHAN ZUO	2025/3/13	
SCALE: N/A	WEIGHT:	SHEET: 1 OF 2

INTERPRET TO ASME Y14.100

CLASS: N/A

CLASS: N/A

NOTES:

1. INSTALLATION SHALL COMPLY WITH ALL APPLICABLE NATIONAL, STATE AND LOCAL ELECTRICAL CODES.
2. REFER TO PRODUCT DOCUMENTATION FOR ADDITIONAL DETAILS PRIOR TO INSTALLATION AND PREPARATION WORK.
3. THIS DRAWING DEPICTS THE POWER SYSTEM CONNECTIONS AND IS NOT REPRESENTATIVE OF THE PHYSICAL LAYOUT. PLEASE REFER TO MECHANICAL DRAWINGS FOR PHYSICAL LAYOUT.

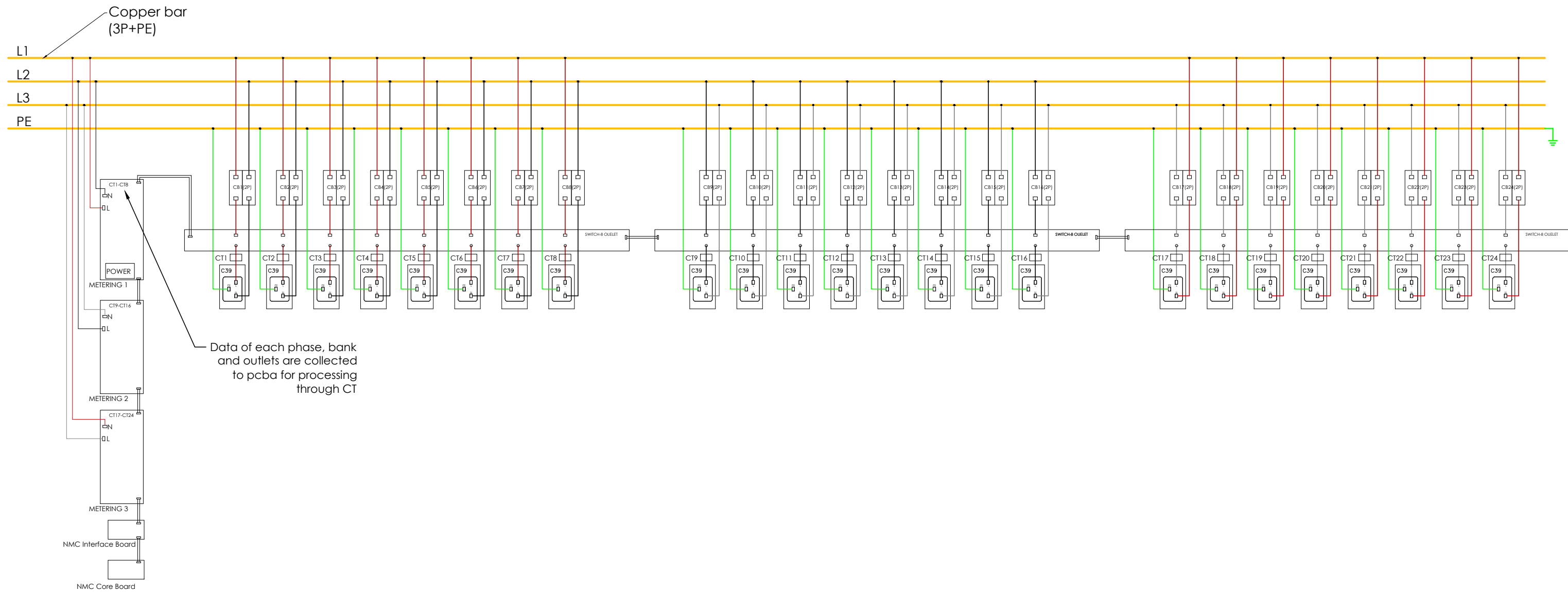

PROPRIETARY AND CONFIDENTIAL  
THIS DRAWING AND ITS SPECIFICATIONS ARE THE PROPERTY OF INOVA AND SHALL NOT BE COPIED, REPRODUCED, OR USED IN WHOLE OR IN PART, AS THE BASIS FOR THE MANUFACTURE OR SALE OF ITEMS WITHOUT THE WRITTEN PERMISSION FROM INOVA. THIS DRAWING IS BASED UPON THE LATEST AVAILABLE INFORMATION AND IS SUBJECT TO CHANGE WITHOUT NOTICE.

UNLESS OTHERWISE SPECIFIED  
X = ± 1  
X.X = ± 0.5  
X.XX = ± 0.30  
X.XXX = ± 0.130  
ANGULAR  
X = 1°  
.X = 0.5°  
.XX = 0.25°

UNITS: mm [in]



DESCRIPTION:  
208V delta 3PH Hard Wire Input, 24pcs locking C39, 72 KW, Metered and Switch per Outlet, Black, Grey, White alternative outlets layout. Black Chassis.

MATERIAL: N/A FINISH: N/A

DEBURR AND BREAK SHARP EDGES/CONTOURS AT 0.2mm MAX

DRAWING NO: MSPO200A3PHC39X24		REV NO: A
NAME		DATE
DRAWN BY AMY ZHU		2025/3/13
APP. BY JOHAN ZUO		2025/3/13
SCALE: N/A	WEIGHT:	SHEET: 2 OF 2

INTERPRET TO ASME Y14.100

CLASS: N/A

CLASS: N/A